

2003 KIWI® & KIWI TOO® TRAVEL TRAILERS BY JAYCO





One part  
COZY  
cottage,

one part  
COMFY  
cabin

Millions of vacationing Americans saw Jayco®'s Kiwi® travel trailer when it toured the nation as part of The Park Programs/Summer-Fun Sweepstakes in 2002, and entered the sweepstakes to win a Kiwi as the grand prize. Jayco was proud to participate in and serve as the official recreational vehicle of the program, involving our nation's National Parks.





## Kiwi® Travel Trailers

*Do you need the size and comfort of a travel trailer but don't want to give up the convenience and maneuverability of a camping trailer? You don't have to. With 35 years of building family fun, Jayco® makes Kiwi® travel trailer to fit your need for comfort and easy towing. From the well-equipped kitchen and well-appointed living room to the well-built exterior, you'll find plenty of features packed into an RV small enough to take wherever you need to go.*

In the kitchen, beautiful Fairfield Oak cabinets have the strength to last. We build them like the ones in your home at a full 35" high, and build cabinet doors using traditional, strong mortise-and-tenon joints. And we use real-wood drawers, not plastic tubs.



Attractive, matching bunk privacy curtains give you a little time to yourself.



Don't worry about deciding how many clothes you can bring with you. Get plenty of space in the large wardrobe closets.



Kiwi gives you travel trailer comforts with camping trailer towability and looks great with optional features such as color-coordinated "ground effects" skirting (not shown here) and white-frame, radius-cornered baggage doors and windows.



**More travel trailer space, less travel trailer weight**

The larger Kiwi Too® travel trailer offers you more interior space, including 78" high ceilings for plenty of headroom. But it weighs up to 15% less than similar-length trailers, so it's simple to tow. With Kiwi Too, you get camping convenience that's easy to handle.

Most Kiwi Too travel trailers feature a J-Steel™ sofa slideout that expands your living space. The manual slideout system is easy to operate. Add the new, optional electric J-Crank™ power slideout for even easier operation.



28 R interior



The new IOTA power center combines 12V and 110V in one convenient compartment.



**DELUXE TRIM PACKAGE OPTION**

The optional integrated ABS front cap improves aerodynamics and protects and hides your LP gas bottles.



Choose a molded rear bumper (one-piece rear bumper on 8' wide models) to make your Kiwi Too travel trailer even more attractive.



Optional radius molded fender skirting lends a sleek look and resists stone damage.



## Kiwi Too® Travel Trailers

You won't have to settle for cold sandwiches anymore. The kitchen comes equipped with a 5- or 6-cu.-ft. flush-mount Norcold® double-door refrigerator, 3-burner range top, range hood with fan and high-rise white faucet.



You'll rest comfortably in the bedroom with features such as a roof vent for better ventilation, optional carpeting for a plush feel and optional innerspring mattress for a good night's sleep. The bed lifts easily on struts for storage beneath.



### BUILDING FAMILY FUN FOR 35 YEARS



The bunk over double bed option (22 V) gives you and your kids more room.

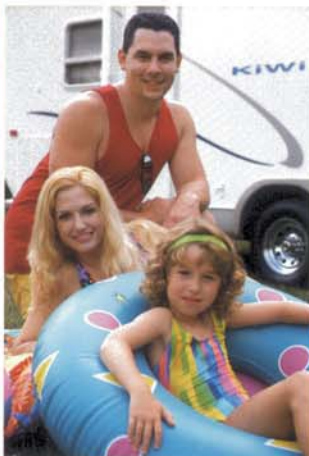

Your Kiwi Too® travel trailer will hold up to years of travel. The independent torsion-axle suspension system smooths out bumps, electric brakes or optional hydraulic brakes keep you safe and the tough TPO roof shrugs off the elements. In case of emergencies, we even include a spare tire with carrier standard.



Different family sizes can find just the right amount of room with features such as the optional triple bunks (30 T) with KidStuf™ bunk organizers option, which give kids a place for their toys, books and other items.



## Kiwi® & Kiwi Too® Travel Trailers

### Loaded with more than just the basics

Both Kiwi® and Kiwi Too® travel trailers give you all the extras that turn a camping trip into an extraordinary one you'll always remember.

Bake your favorite meals in the optional oven.

Simply plug in the optional outside stove for an outdoor dinner.

Our optional portable gas barbecue grill lets you get that great grilled flavor. And it comes with a handy carrying case.

Get consistent-tasting drinking water with the optional water filtration system, which is built-in so you won't have to mount one outside.



The white acrylic, full double sink with cover gives you the good looks and size competitors don't (single on 17 A).



The optional microwave oven with carousel lets you heat up leftover burgers or make late-night popcorn. In Kiwi Too travel trailer, choose an oven and microwave for the ultimate in cooking flexibility.



The optional outside shower includes hot and cold faucets, rugged ABS plastic hose and shower head.



Another item to bring a touch of home includes the beautiful residential handles and knobs on kitchen cabinets and drawers.



## Kiwi® & Kiwi Too® Travel Trailers

Keep tabs on your kids or other family members with the optional Audiovox® family two-way radio system, including four hand-held radios and holder/charger.



An optional front storage compartment pull-out tray brings your things out within easy reach.



Kiwi Too® travel trailers give you more room than similar vehicles for longer items such as fishing poles, paddles or water skis and convenient pass-through access from both sides.



Keep track of the status of all systems with the monitor panel.



The Norco® frame has an E-Coat™ surface to inhibit rust and is made without welds, allowing a thicker, more rigid steel than in conventional tubular-steel trailer frames but weighing 20% less. Special pinched "huck" bolts hold frame pieces together and don't loosen over time. And the unique tapered design puts the strongest part of the frame over the axles.



Our new E-Z Lube® axles with removable caps make maintenance simple.



The one-piece PolyFlex™ underbelly coating protects against stones and dirt, improves aerodynamics and makes towing easier (enclosed underbelly on Kiwi Too).



Hear your favorite music while enjoying the sun and fresh air with the optional outside entertainment center. It features a spare 110V duplex power outlet for whatever additional items you choose and a heavy, waterproof locking cover.

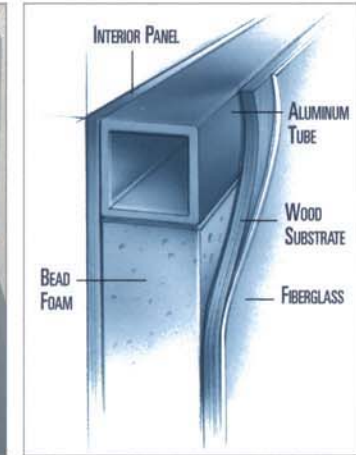

TuffShell™ construction uses vacuum-bond laminating to ensure floor, walls and roof stay flat and straight and won't warp for the life of the trailer. The Filon® Plus high-gloss fiberglass sidewalls form a strong, one-piece exterior that weighs less than regular fiberglass.



# 2003 Kiwi® AND Kiwi Too® TRAVEL TRAILER STANDARDS AND OPTIONS

## STANDARD INTERIOR FEATURES

	Kiwi®	Kiwi Too®
Oak doors and drawers, mortise-and-tenon construction	■	■
Cabinets crafted with stile construction	■	■
No-wax vinyl flooring	■	■
3-burner range top	■	■
Prewired for microwave oven installation	■	■
3-cu.-ft. flush-mount refrigerator (17 A, 18 F)	■	■
5-cu.-ft. flush-mount refrigerator (21 C, 23 B, 23 D, 25 E) (22 U, 22 V)	■	■
6-cu.-ft. flush-mount refrigerator	■	■
Range hood w/light and fan	■	■
Shower curtain	■	■
Large drawer in U-dinette	■	■
Large kitchen window	■	■
Slanted overhead cabinet (where possible)	■	■
Bunk lights with fan (2)	■	■
Bathroom mirror	■	■
Bathroom roof vent (17 A)	■	■
12V bathroom roof vent (except 17 A)	■	■
Fire extinguisher	■	■
LP detector	■	■
Smoke detector	■	■
Double white acrylic kitchen sink (single 17 A)	■	■
High-rise white kitchen faucet	■	■
Wallpaper border - kitchen	■	■
Roof vent in bedroom	■	■
Prop for bed lid	■	■
35" residential-height base cabinets	■	■
* Mini blinds	■	■
Sink cover - 1 (except 17 A)	■	■
78" ceiling height	■	■
* Stereo prep w/2 speakers	■	■

## STANDARD CONSTRUCTION FEATURES

	Kiwi®	Kiwi Too®
TuffShell™ vacuum-bond laminated walls, roof and floor	■	■
1" tubular-aluminum frame	■	■
Bead-foam insulation throughout (R-7 roof/floor) (R-5 walls)	■	■
Smooth, one-piece fiberglass exterior	■	■
Unitized, 1-1/2" laminated floor construction	■	■
One-piece PolyFlex™ underbelly coating	■	■
New modular HSLA steel E-Coat™ frame	■	■
Enclosed underbelly	■	■

\* New for 2003!

## STANDARD EXTERIOR FEATURES

	Kiwi®	Kiwi Too®
Independent torsion-axle suspension system	■	■
22" door with dead bolt lock (17 A, 18 F)	■	■
26" door with dead bolt lock (except 17 A)	■	■
White frame radius-corned baggage doors	■	■
Sewer hose storage compartment	■	■
Patio light w/inside switch and amber lens	■	■
110V exterior receptacle	■	■
Heavy-duty retractable entrance step	■	■
Safety chains and breakaway switch	■	■
14" C-range radial tires (25 E Kiwi® - 26' & up Kiwi Too®)	■	■
13" C-range radial tires (Kiwi® & under 25' Kiwi Too®)	■	■
10" electric brakes	■	■
Stabilizer jacks (4)	■	■
BoltaFlex CT™ tent	■	■
2" hitch coupler (17 A, 18 F)	■	■
2-5/16" hitch coupler (except 17 A)	■	■
Lockable end bunks	■	■
TPO roof	■	■
Radius-framed white windows	■	■
Flush-mount front window & awning	■	■
Front angled windows	■	■
White spoked wheels	■	■
Dead bolt door lock	■	■
Locking battery compartment w/rotocast box	■	■
Pass-through storage	■	■
Baggage doors with grab handles	■	■
HDPE wheel wells	■	■
* EZ Lube® axles	■	■
* Spare tire w/carrier	■	■

## STANDARD HEAT, POWER & WATER

	Kiwi®	Kiwi Too®
Double 20-lb. LP bottles with auto regulator (all Kiwi® & 25' and under Kiwi Too®)	■	■
Double 30-lb. LP bottles with auto regulator (26' models & up)	■	■
30-amp. high-efficiency electronic converter (all Kiwi® & 25' and under Kiwi Too®)	■	■
45-amp. high-efficiency electronic converter (26' models & up)	■	■
30-amp. power cord	■	■
16,000-BTU auto-ignition furnace w/thermostat (17 A, 18 F)	■	■
20,000-BTU auto-ignition furnace w/thermostat (21 C, 23 B, 23 D, 25 E)	■	■
31,000-BTU auto-ignition furnace (30 T)	■	■
25,000-BTU auto-ignition furnace (22 U, 22 V, 26 S, 28 R)	■	■
Ducted heat (except 17 A)	■	■
Floor-ducted heat	■	■
Pre-wired for air conditioning	■	■
Shurflo® demand water pump	■	■
Copper gas lines	■	■
Monitor panel	■	■
120V power center	■	■
120V G.F.C.I. protected circuit	■	■
TV antenna and cable	■	■
Water heater bypass kit	■	■
6-gallon gas water heater	■	■

## OPTIONAL FEATURES

	Kiwi®	Kiwi Too®
Folding chairs (23 B)	■	■
Tinted safety glass windows	■	■
Bath skylight (18 F, 21 C, 23 D, 25 E) (28 R)	■	■
20-lb. double vinyl gas bottle cover (Kiwi® & 25' under Kiwi Too®)	■	■
30-lb. double vinyl gas bottle cover (26' models & up)	■	■
13,500-BTU A/C (all Kiwi® & 22 U, 22 V Kiwi Too®)	■	■
* 13,500-BTU Central A/C (26 S, 28 R, 30 T)	■	■
* 15,000-BTU Central A/C (26 S, 28 R, 30 T)	■	■
Microwave oven w/ carousel	■	■
Oven	■	■
Outside stove	■	■
Portable gas barbecue grill w/carrying case	■	■
Awning	■	■
Stereo AM/FM cassette w/2 speakers	■	■
Stereo AM/FM CD w/2 speakers	■	■
Spare tire w/carrier	■	■
Hydraulic brakes (17 A, 18 F)	■	■
Bunk beds (21 C)	■	■
Third bunk (30 T)	■	■
Outside shower	■	■
Exterior entertainment center	■	■
DSI water heater	■	■
Center tension rafter	■	■
Woven wood shades	■	■
Exterior storage drawer (22 U, 26 S, 30 T)	■	■
ABS tub surround (28 R)	■	■
Stabilizer jacks - 4	■	■
Bedroom carpet	■	■
KidStuf™ bunk organizer (2 or 3) (30 T)	■	■
KidStuf™ bunk organizer (1)	■	■
Inner spring mattress with bed struts	■	■
Bedroom TV shelf	■	■
Bi-fold door	■	■
Chrome wheels	■	■
5-cu.-ft. flush-mount refrigerator (18 F)	■	■
6-cu.-ft. flush-mount refrigerator (23 B, 23 D, 25 E) (22 U, 22 V)	■	■
* Family 2-way radio system	■	■
* Water purifier system	■	■
* J-Crank™ electric power slideout	■	■
* Exterior radius skirts	■	■
Deluxe trim package:	■	■
• ABS front cap • Radius skirt • Molded bumper		
• Molded fender skirt • Colored skirting & caps		



# 2003 Kiwi® TRAVEL TRAILER FLOORPLANS

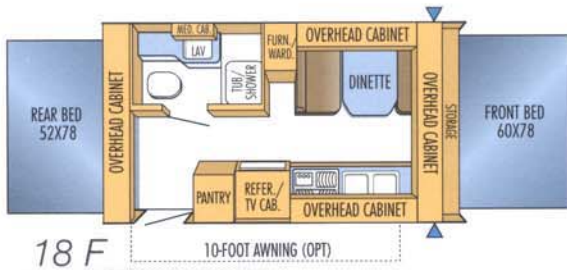
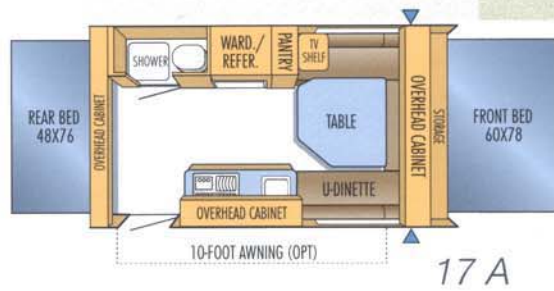

OUTSIDE STORAGE COMPARTMENT

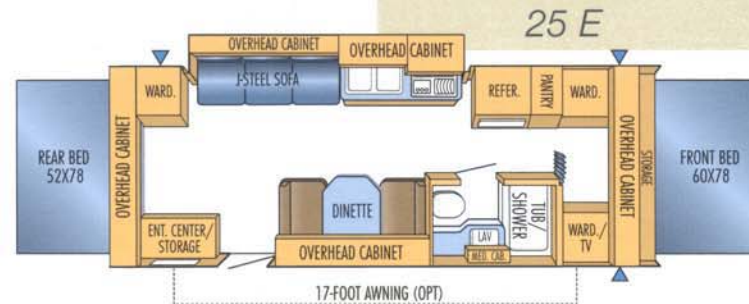
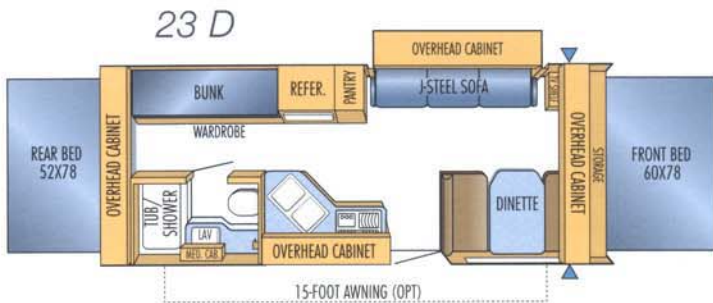
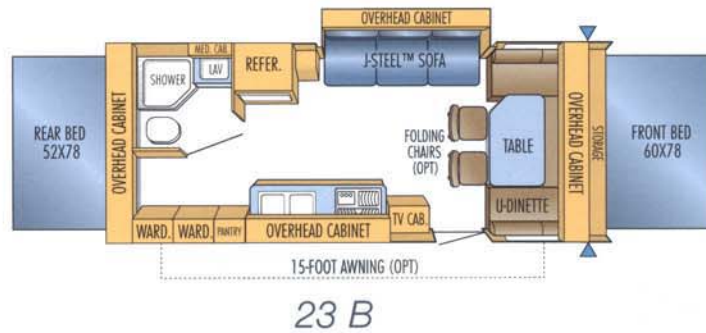
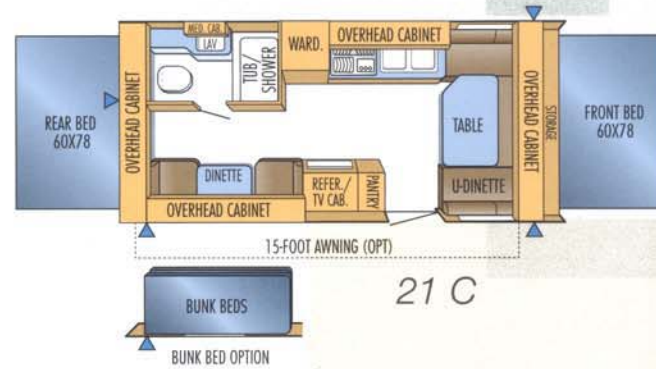



# 2003 Kiwi Too® TRAVEL TRAILER FLOORPLANS

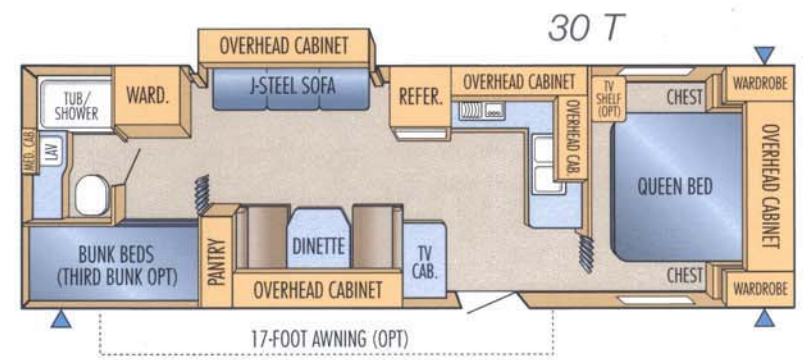
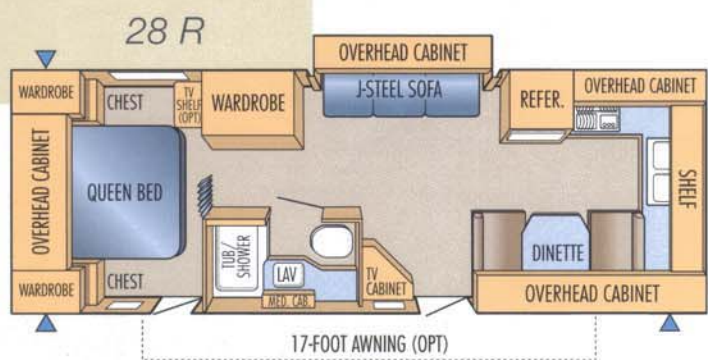
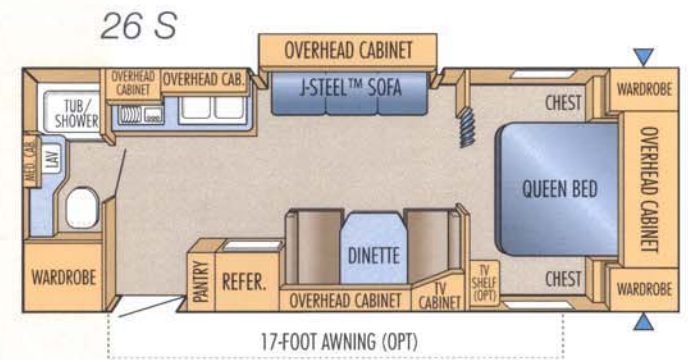
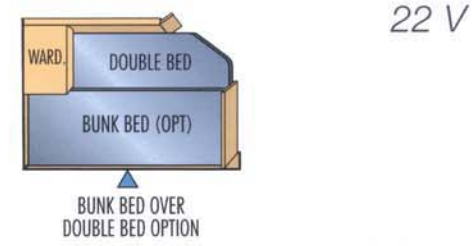
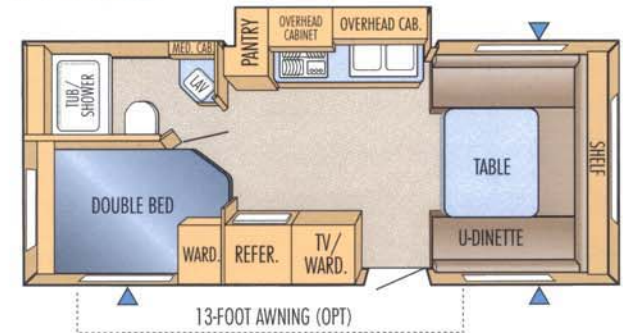
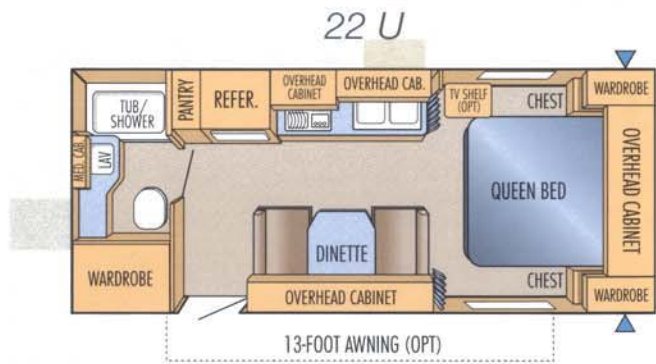
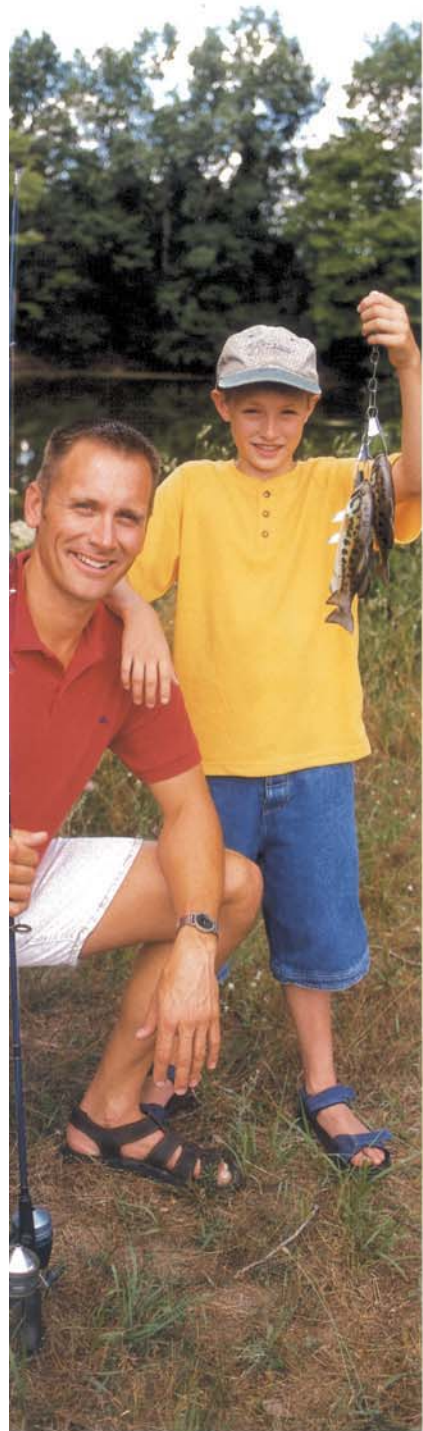



## 2003 Kiwi® TRAVEL TRAILER SPECIFICATIONS

Kiwi®	Exterior Travel Length	Exterior Campsite Length	Exterior Width	Exterior Height w/opt AC	Interior Headroom	Unloaded Vehicle Weight (lbs.)	Axle Weight (lbs.)	Hitch Weight (lbs.)	Cargo Carrying Capacity (lbs.)	Gross Vehicle Weight Rating (lbs.)	Fresh Water Capacity (gals.)	Gray Water Capacity (gals.)	Toilet/Black Wastewater Capacity (gals.)
17 A	17'-2"	20'-8"	7'-1"	115"	78"	2365	2130	235	1085	3450	30	19	6
18 F	18'-2"	21'-5"	7'-6"	115"	78"	2760	2355	405	990	3750	30	23	23
21 C	21'-9"	25'-7"	7'-6"	115"	78"	3230	2810	420	1320	4550	30	30	25
23 B	23'-7"	27'-1"	7'-6"	115"	78"	3630	3290	340	1320	4950	30	30	25
23 D	23'-7"	27'-1"	7'-6"	115"	78"	3670	3225	445	1280	4950	30	30	25
25 E	25'-10"	29'-3"	7'-6"	115"	78"	4000	3485	515	1500	5500	30	30	25

Fresh Water Capacity Includes 6 gal. For Water Heater

## 2003 Kiwi Too® TRAVEL TRAILER SPECIFICATIONS

Kiwi Too®	Exterior Travel Length	Exterior Width	Exterior Height w/opt AC	Interior Headroom	Unloaded Vehicle Weight (lbs.)	Axle Weight (lbs.)	Hitch Weight (lbs.)	Cargo Carrying Capacity (lbs.)	Gross Vehicle Weight Rating (lbs.)	Fresh Water Capacity (gals.)	Gray Water Capacity (gals.)	Toilet/Black Wastewater Capacity (gals.)
22 U	23'-6"	7'-6"	116"	78"	3490	3145	345	1460	4950	36	30	22
22 V	22'-6"	7'-6"	116"	78"	3590	3220	370	1360	4950	36	30	22
26 S	27'-6"	8'	116"	78"	4340	3815	525	1460	5800	36	30	22
28 R	28'-11"	8'	116"	78"	4285	3795	490	1815	6100	36	30	22
30 T	31'-6"	8'	116"	78"	4725	4115	610	1775	6500	36	30	22

Fresh Water Capacity Includes 6 gal. For Water Heater

**Unloaded Vehicle Weight (UVW):** Sometimes referred to as "Dry Weight," UVW means the typical weight of this trailer as built at the factory. The UVW, as used in product literature and other promotional materials, does not include cargo, fresh water, LP gas, options or dealer-installed accessories.

**Gross Vehicle Weight Rating (GVWR):** GVWR means the maximum permissible weight of the trailer, including the UVW plus passengers, personal items, all cargo, fluids, options and dealer-installed accessories. The GVWR is equal to or greater than the sum of the UVW and the CCC.

**Cargo Carrying Capacity (CCC):** CCC means the maximum weight of all passengers, personal items, food, fresh water, LP gas, tools, other cargo and dealer-installed accessories that can be carried by the trailer. CCC is equal to or less than GVWR minus UVW. The addition of options will decrease the CCC.

It is important for your safety and enjoyment that your tow vehicle be adequately sized and equipped to tow and handle the GVWR of the RV you select. Review weights and rating of your tow vehicle and consult a competent advisor for questions or advice. Whether you are new to

RVing or a veteran, get a feel for the performance of your tow vehicle and the RV together before heading out on the roadways. **When you tow an RV, you must drive differently than you do when driving a single vehicle.** Practice hooking up, driving, backing up and braking in a safe environment or seek out professional instruction.

See specification chart above. Jayco® affixes a weight label to each new RV which lists weight information for that vehicle.

## 2003 Kiwi® & Kiwi Too® TRAVEL TRAILER INTERIOR COLOR SELECTIONS



Blue Vista



Cinnamon Stick Tan

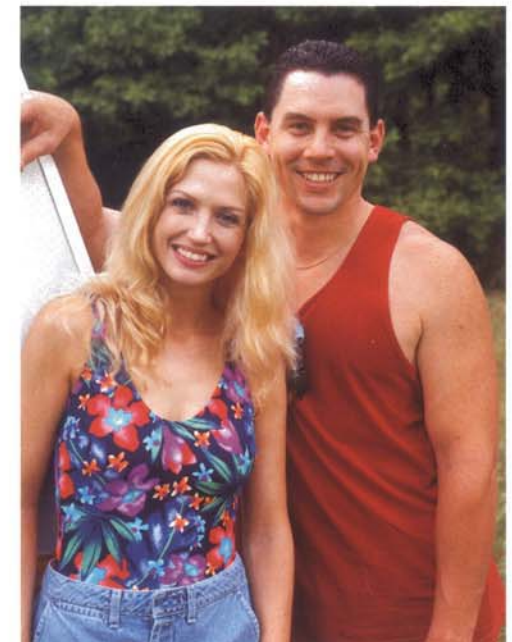



# 2003 Kiwi® & Kiwi Too® Travel Trailers

## WE BACK WHAT WE BUILD

The Jayco 2+3 Warranty is a manufacturer's warranty. It doesn't come from your dealer, and it's not an extended warranty! It comes from the people who build Jayco recreational vehicles to the people who buy them. Each Jayco is warranted to the original purchaser for twenty-four (24) months from the date of purchase against defects in materials and workmanship. This is full hitch-to-bumper coverage on towables and bumper-to-bumper on motorized RVs. The Jayco warranty includes a three-year (3) structural guarantee. In addition, our warranty is transferable within the first two (2) years for a \$100 processing fee. Go ahead and compare the Jayco warranty with other manufacturers' warranties. You'll find it's the best in the business! For a copy of the warranty with full terms and conditions, ask your local Jayco dealer or visit our Web site.

## Five year coverage

We also offer five-year (5) coverage on our tent with parts, labor and freight covered the first two years; parts, factory labor and return freight during years three, four and five.

Jayco® delivers responsive, reliable after-market customer service



When you purchase a Jayco Recreational Vehicle, you'll also get a support staff dedicated to meeting the needs of you and your dealer. To deliver on this promise, we built a 91,000-square-foot, state-of-the-art facility that seamlessly integrates our Warranty, Customer Service and Service Parts divisions (After Market Services — AMS). Staff from each division can now work more closely together to better provide prompt, accurate service.

For example, the AMS staff can quickly access information on the computer and service representatives can better serve the needs of Jayco dealers and retail customers. Our

service area contains 15 bays that feed into a spacious work area for customers who need assistance during their travels through Indiana.

The Parts and Warranty divisions take advantage of our Jayco Xpress online computer network that links Jayco Customer Service to dealers across the country and allows them to place parts orders, check the status of an order and check pricing and availability. Dealers

participating in the online system can also register new Jayco owners 24 hours a day, seven days a week. That way, when you pull off the dealer's lot, your new unit is already registered with the factory.

Our parts warehouse, equipped with automated carousels and stocked with a large inventory of parts, can provide our dealers with the parts you need so you can get back on the road to enjoying your vacation.

You won't find a more caring after-market service group in the recreational vehicle industry. That's our goal and commitment to you.

In the heart of the Midwest, old-world craftsmen have handed down tried-and-true construction methods from generation to generation. At our headquarters in Middlebury, Indiana, Jayco continues this tradition when building all of our recreational vehicles. Our rugged designs, solid construction and commitment to quality add up to a well-built vehicle you can depend on for years.



See above dealer for further information and prices.



Jayco, Inc. P.O. Box 460 Middlebury, IN 46540  
[www.jayco.com](http://www.jayco.com)



As a Jayco owner, you can be part of the Jayco Jafari International Travel Club. Ask your dealer about the Jafari "flight" in your area, write Jayco direct or visit our Web site.

**Please Note:** All information in this brochure is the latest available at the time of publication approval. Jayco reserves the right to make changes and to discontinue models without notice or obligation.

Pictures in this brochure may show optional equipment. RVs built for sale in Canada may differ to conform to Canadian codes.

Printed on recycled paper.



©2002 Jayco, Inc. 0902-125M Litho in U.S.A.