

2005 EAGLE™

Now You're Going Places.

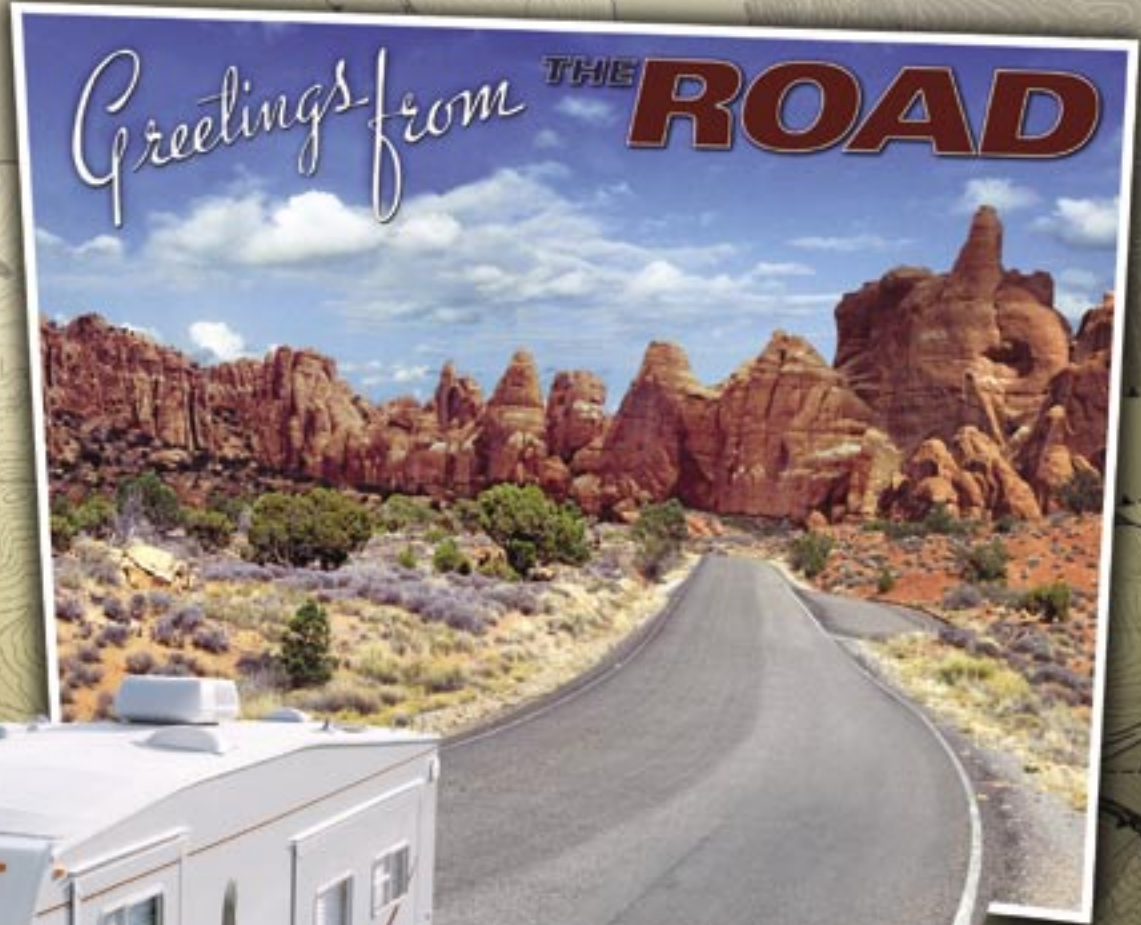

Jayco

2005 EAGLE

TRAVEL TRAILERS AND FIFTH WHEELS



Jayco

www.jayco.com

2005 EAGLE

TRAVEL TRAILERS

Now You're Going Places.

www.jayco.com



282 FKS

GOING IN STYLE

You're on your way to jaw-dropping natural beauty and exhilarating outdoor adventures. Go there in style in an Eagle travel trailer by Jayco®. The Eagle elevates your RV experience to a higher level of luxury, while keeping your costs easily within reach. From the impressive exterior with fiberglass sidewalls, to the well-appointed interior filled with amenities, the Eagle always travels with striking grace.

- *Diamond plate provides protection from rocks and road debris and adds sturdy good looks.*
- *There's space for your fishing poles, oars, and water skis in the convenient pass-through storage area, available on most models.*





- ▲ Standard day/night pleated shades, topped with a scalloped valance, block out the sun's rays for a cooler, more restful environment.
- ◀ Raised panel cabinet drawers and doors add traditional charm.

- ▲ A J-Steel® convertible sofa and cozy dinette provide comfortable seating throughout the day. Dine in spacious comfort at the slideout dinette while you enjoy the view through the large picture window. Freestanding table and chairs are optional.

- ▲ The optional 1.0 cu ft Samsung® microwave oven with carousel helps make meal preparation quick and easy.

GOING IN COMFORT

Outside, you'll be hiking through nature's wonders. But inside, you'll be pampering yourself with comforts that are definitely man-made. An Eagle travel trailer surrounds you with thoughtfully designed features that add both elegance and convenience to your travels. With every mile, and every moment, you'll be glad you're flying higher with an Eagle.



- ▲ Sleep peacefully on the queen-size, pillow-top innerspring mattress, covered with coordinating quilted bedspread. Your clothes will be out of sight in the overhead cabinet, chest and wardrobes, or under the bed that lifts easily on struts.



Whether you're relaxing, dining, or cooking, you'll feel right at home inside an Eagle travel trailer. Every area is built to enhance your enjoyment.

2005 EAGLE

FIFTH WHEELS

Now You're Going Places.

www.jayco.com



291 RLTS

GOING WITH EASE

- ◀ Get both electric front jacks and quick release pins as standard equipment.
- ◀ A spacious front trunk gives you a convenient place to store and protect coolers, lawn chairs, and other bulky gear.
- ◀ The standard outside shower gives you a convenient place to rinse off after outdoor activities.

When it's time to get away from it all, leave behind the complications of everyday living and enjoy the restful ease of an Eagle fifth wheel. Designed to maximize the fun and minimize the work, it's filled with convenient touches from floor to ceiling. We've thought of everything to make your travel adventures easy to love, no matter where the road takes you.



GOING WITH BEAUTY

At its best, RVing brings you closer to beautiful vistas, beautiful sunsets, and beautiful foliage. Traveling with an Eagle fifth wheel adds even more beauty to your explorations with its luxuriously warm, inviting interior. You'll appreciate the attention to detail, from Fairfield Oak cabinetry to richly detailed upholstery to elegant brass and chrome fixtures. As long as you're going, you might as well go with beauty.



▲ The bedroom makes a beautiful end to a busy day with its handsome Fairfield Oak cabinetry, coordinated bedspread and window treatments, and soft carpeting.



Choose from a variety of attractive seating options, including matching swivel rockers and this hide-a-bed with dual foot rests.

291 RLTS



▲ This versatile Dolby® Digital 5.1 Home Theater System features a DVD/CD player and recessed ceiling speakers, and is part of the Customer Value Package.

▲ The 8-cubic-foot, flush-mounted Norcold® double-door refrigerator is roomier than you'll find in the average fifth wheel.

▲ You'll appreciate the refreshing feel of the well-equipped bathroom, featuring ABS shower with tub surround and standard glass shower door.

▲ The bathroom also includes a laundry chute with basket (most fifth wheels).
 ➤ All the ingredients of a great kitchen are here, including a 3-burner range with 9,000-BTU SuperBurner™ and piezo igniter, and deep residential-style sink with white arched-neck faucet.

291 RLTS

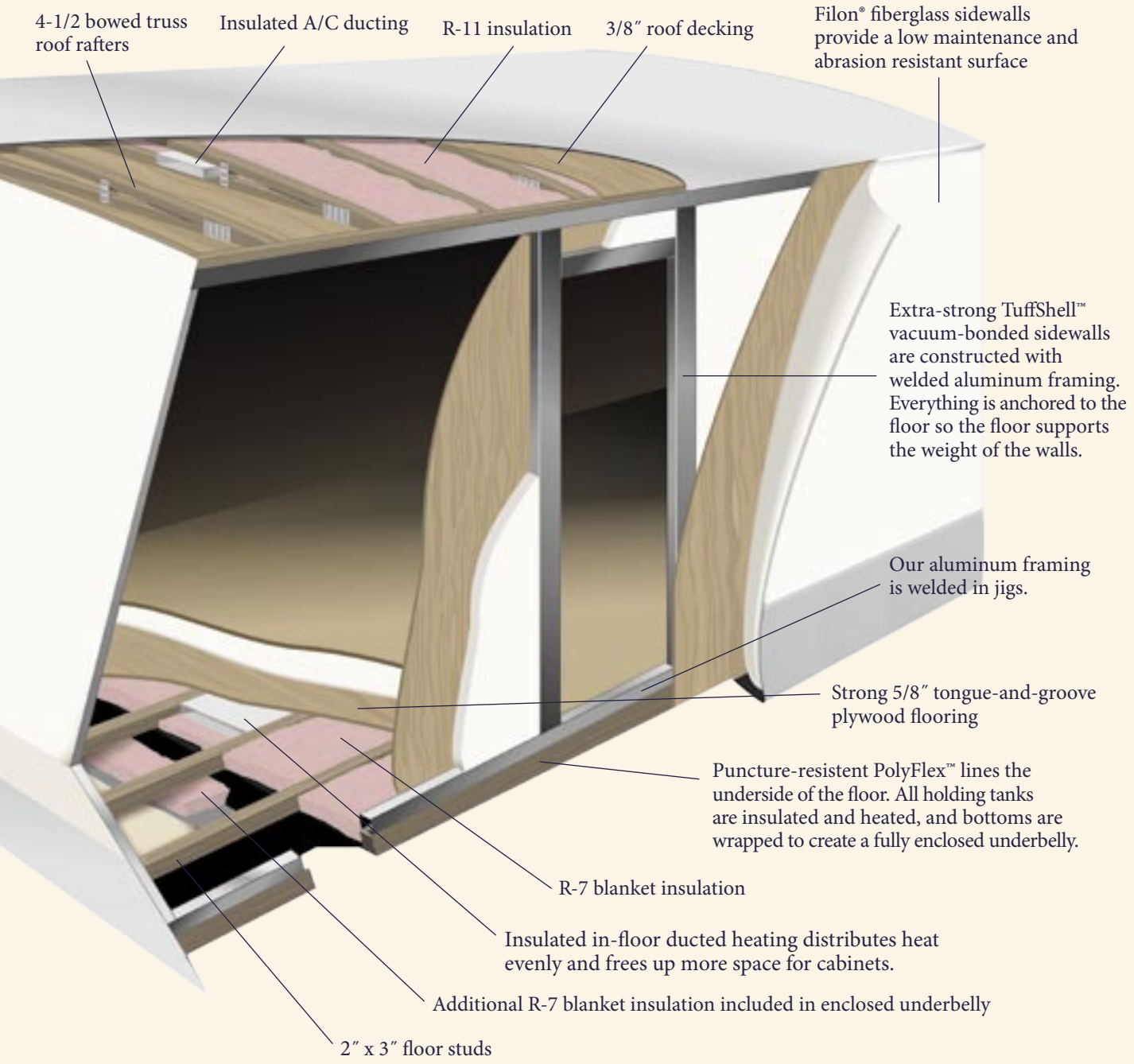

**STEEL AND ALUMINUM FRAMING
 CREATE A STRONG CORE.**



Jayco® Competitor

Jayco's I-Class™ structural steel chassis frame is stronger and more durable than the welded I-beam used by many competitors, which is subject to warping.

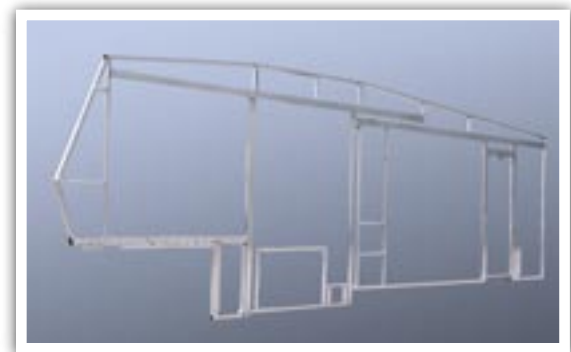

▲ Aluminum sidewall framing is standard

All of our sturdy construction features, including the aluminum framing of our TuffShell™ sidewalls, are there to give you peace of mind.



Adjustable axle hanger plates

STANDARD JAKE PLATE™

The height of your tow vehicle will never be a worry. Eagle fifth wheels feature standard Jake Plate™ adjustable axle hanger plates. Twice as strong as traditional single spring hangers, they allow you to adjust the axle height up to 2" to accommodate tow vehicles of different sizes.

V-TEC™ SLIDEOUT SYSTEM

Enjoy wide-open spaces, outside and in. Jayco's V-Tec™ slideout expands your living space by simply pushing a button. A strong I-Class™ steel frame allows Jayco to utilize a flush-floor slideout system. Our V-Tec™ mechanism consists of rack-and-pinion drive, low-friction gearing, and high-torque electric motor.



JAYCO CRAFTSMANSHIP

Jayco has been blessed with some of America's finest craftsmen who make Middlebury, Indiana and the Jayco plant their home and workplace. Generation after generation, a legacy of tried-and-true construction methods is passed down, continuing the tradition of quality and durability that has helped Jayco grow into a true industry leader.



▲ Eagle travel trailers and fifth wheels feature solid Fairfield Oak cabinet doors with mortise and tenon construction.



FIFTH WHEEL FLOORPLANS

251 RLS

New for 2005!

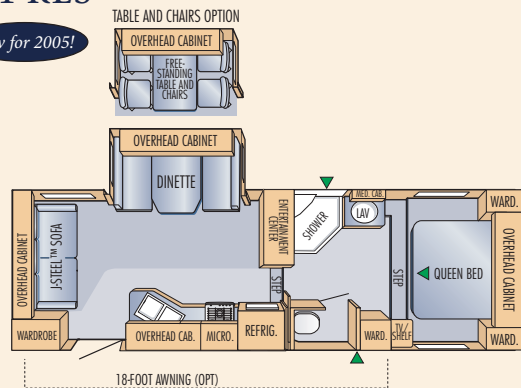

281 RLS

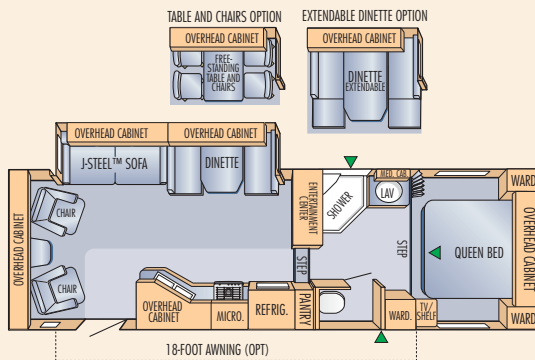

291 RLTS

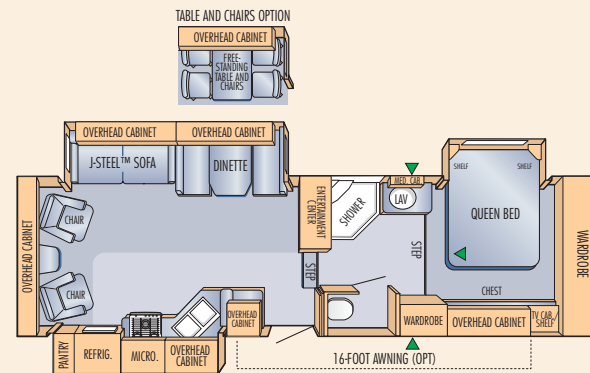

293 RKS

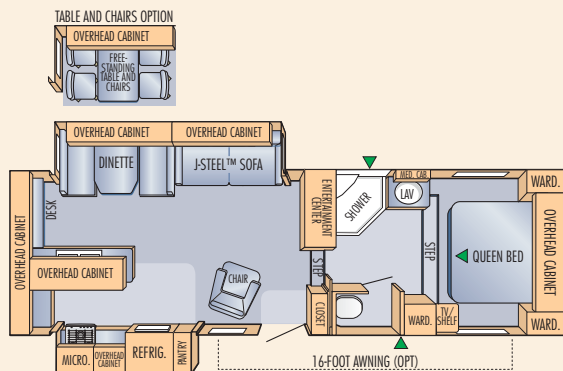

301 RLS

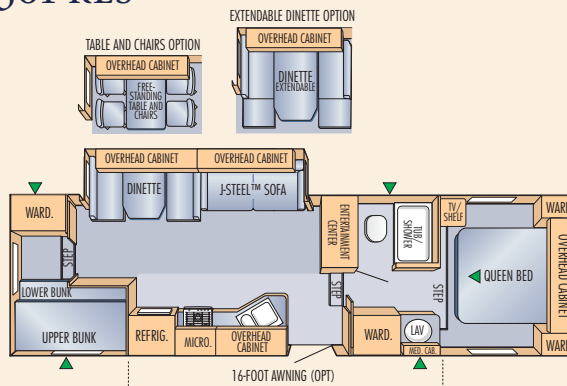

305 BHS

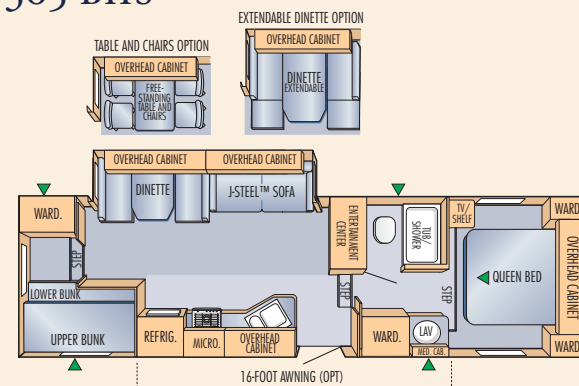

323 RKS

New for 2005!

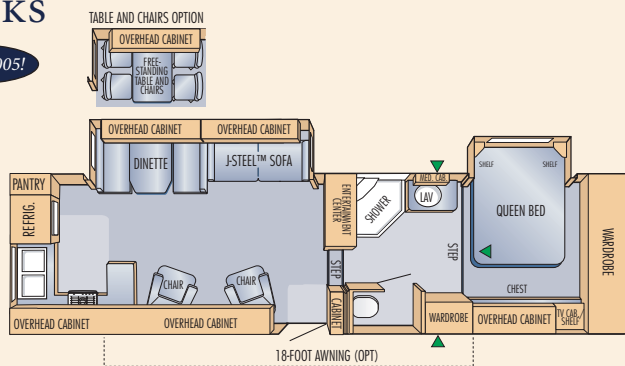

325 BHS

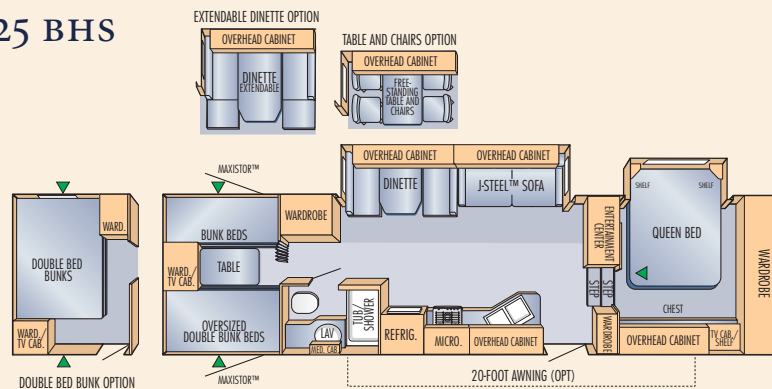

2005 EAGLE STANDARDS AND OPTIONS

	Travel Trailers	Fifth Wheels		Travel Trailers	Fifth Wheels		Travel Trailers	Fifth Wheels
Standard Construction Features				Standard Kitchen Equipment				
2" x 3" Longitudinal floor joists on 16" - 18" centers	✓	✓	Stabilizer jacks (2 pair)	✓		3-burner range with 9,000-BTU SuperBurner™ and piezo igniter	✓	✓
5/8" Tongue and Groove plywood main floor decking	✓	✓	Stabilizer jacks on rear (1 pair)	✓		8 cu ft flush-mount refrigerator with double door	✓	✓
81" living room ceiling height	✓	✓	Triple retractable entrance step	✓	✓	Bi-fold cover for range	✓	✓
Bead-foam insulation in sidewalls (R-9)	✓	✓	Standard Heat, Power, and Water Equipment			Cover for sink/cutting board (1)	✓	✓
Enclosed, insulated, and heated underbelly	✓	✓	110V G.F.C.I. protected exterior receptacle	✓	✓	Deep residential-style sink	✓	✓
Filon® fiberglass sidewall exteriors	✓	✓	12V demand water pump	✓	✓	Drawer for silverware, divided for utensils	✓	✓
Platforms for dinette, bed, and bunks are constructed of 1/2" plywood	✓	✓	12V electrical system with deluxe 110V 45-amp power converter	✓	✓	Knife holder recessed in countertop	✓	✓
Roof is one piece, seamless, and made of rubber	✓	✓	30-amp power cord	✓	✓	Large pedestal dinette table	✓	✓
Roof rafters, constructed of residential-style tapered 4-1/2" trusses	✓	✓	Double 30-lb. LP gas bottles with regulator	✓	✓	Oversized oven	✓	✓
Sidewall framework made of tubular-aluminum	✓	✓	Furnace with wall thermostat, auto-ignition	✓	✓	Range hood with light and exhaust fan	✓	✓
TuffShell™ vacuum-bond laminated sidewalls	✓	✓	Hook-up for city water	✓	✓	Wallpaper border	✓	✓
			In-floor ducted heat	✓	✓	White mixing high-rise faucet	✓	✓
			Monitor panel for all systems	✓	✓	Over-sized picture window at dinette	✓	✓
			Outside shower	✓	✓			
			Water heater bypass system	✓	✓	Standard Safety Equipment		
			Winterization kit	✓	✓	Break-away switch	✓	✓
Standard Exterior Equipment						Dual hitch safety chains	✓	
12V light for hitch	✓	✓	Standard Interior Equipment			Fire extinguisher	✓	✓
15" radial tires	✓		24" flat screen TV		✓	Lock and dead bolt on entrance door	✓	✓
16" radial tires	✓		Cable TV hookup with RG6 Coax	✓	✓	LP/gas leak detector	✓	✓
ABS fender skirts	✓	✓	Carpeting with padding	✓	✓	Multiple egress windows	✓	✓
Baggage doors are lockable and radius-cornered with heavy-duty grab handle	✓	✓	Handsome furniture, designed and made by Jayco	✓	✓	Smoke detector	✓	✓
Battery box for two batteries	✓		Crank-up antenna for TV with signal booster	✓	✓	Windows with clear safety glass	✓	✓
Bumper with drain hose carrier and end caps	✓	✓	Day/night shades	✓	✓			
Chrome hub caps	✓	✓	Decorative brass light at sofa and dinette	✓	✓	Optional Equipment		
Cover for LP gas bottle made of molded ABS	✓		Fabric-covered box valances with lambrequin legs	✓	✓	AM/FM stereo and CD player in bunk (298 BHS, 305 BHS, and 325 BHS)	✓	✓
Diamond-plated panel on front	✓		Fairfield Oak raised-paneled doors and drawers	✓	✓	Black holding tank sprayer	✓	✓
Egress windows with screens in bunk	✓	✓	High-intensity 12V lighting package	✓	✓	Customer Value Package	✓	✓
Electric-powered front jacks	✓		J-Steel™ convertible sofa	✓	✓	Double bunk bed (325 BHS)	✓	
Entrance door is fiberglass and radius cornered with screen door	✓	✓	Linoleum floor in entryway	✓	✓	Extendable dinette (select models)	✓	✓
E-Z Lube® Axles	✓	✓	Nickel/brass cabinetry hardware	✓	✓	Free-standing table with 4 chairs	✓	✓
Front window includes fiberglass stoneguard	✓		Oak trim around main entrance door	✓	✓	Hide-a-bed sofa with foot rest (most models)	✓	✓
Galvanized steel wheel wells	✓	✓	Overhead cabinet for TV (select models)	✓	✓	Ladder to roof	✓	
Jake Plate™ adjustable axle hangers	✓		Overhead cabinetry in slideout room	✓	✓	Linoleum floor in living area (std 325 BHS)	✓	✓
Ladder to roof	✓		Sliding windows in slideout end walls	✓	✓	Portable, outside gas RVQ grill with carrying case	✓	✓
Painted bottom radius skirting	✓	✓	Solid hardwood interior grab handle for entry assistance	✓	✓	Spare tire and tire carrier with vinyl tire cover	✓	
Patio light with inside switch	✓	✓	Swivel rocker(s) (select models)	✓	✓	Swivel rocker (1) (282 FKS)	✓	
Rain guttering, molded with drip spouts	✓	✓				Swivel rocker(s) (2) in lieu of J-steel sofa (261 RLS)	✓	
Shock clips on frame and axles	✓							
Quick-release pins of front jacks	✓							

Customer Value Package

6 gallon gas/electric DSI auto-ignition

water heater	✓ ✓
Central A/C, 15,000 BTU	✓ ✓
Carefree® patio awning	✓ ✓
Deluxe pillow-top mattress	✓ ✓
Extra insulation in roof	✓ ✓
Foldable, exterior grab handle	✓ ✓
Dolby® Digital 5.1 Surround Sound	
Home theater system with DVD	✓ ✓
In-floor, flush-mounted safe	✓ ✓
Microwave oven with carousel	✓ ✓
Powered attic fan in bathroom	✓ ✓
Security lights (2)	✓ ✓
Skylight in tub/shower	✓ ✓
Water purification system	✓ ✓

Travel | Fifth
Trailers | Wheels

2005 EAGLE INTERIOR COLOR OPTIONS



Life is a Cabernet



Oceanside Blue



Peach Grove

EAGLE TRAVEL TRAILER SPECIFICATIONS

Models	Exterior Length	Exterior Height	Bedroom Interior Height	Unloaded Vehicle Weight	Dry Hitch Weight	Gross Vehicle Weight Rating	Cargo Carrying Capacity	Fresh Water Capacity	Gray Wastewater Capacity	Toilet/Black Wastewater Capacity
278 FBS	29'-3"	134"	81"	6915	915	9000	2085	46	74	37
280 FSS	29'-6"	134"	81"	6750*	900*	8500*	1750*	46*	74*	37*
282 FKS	29'-8"	134"	81"	6870	1125	8500	1630	46	74	37
298 BHS	32'-6"	134"	81"	7305	850	9000	1695	46	74	37
308 FBS	33'-4"	134"	81"	7430	950	9000	1570	46	74	37
322 FKS	34'-8"	134"	81"	7500*	1125*	9000*	1500*	46*	74*	37*

EAGLE FIFTH WHEEL SPECIFICATIONS

251 RLS	27'-5"	147"	77"	7060*	1610*	9460*	2400*	46*	74*	37*
281 RLS	30'-5"	147"	77"	7835	1705	10500	2665	46	74	37
291 RLTS	33'-4"	147"	77"	9595	2160	12500	2905	46	74	37
293 RKS	30'-9"	147"	77"	8400*	1610*	10500*	2100*	46*	74*	37*
301 RLS	33'-3"	156"	77"	9170	2220	12000	2830	46	74	37
305 BHS	32'-4"	147"	77"	8355	1400	10500	2145	46	74	37
323 RKS	35'-0"	156"	77"	8200*	1800*	10600*	2400*	46*	74*	37*
325 BHS	35'-4"	156"	72"	9535	1915	12500	2965	46	82	45

* = estimated values

Unloaded Vehicle Weight (UVW): Sometimes referred to as "Dry Weight," UVW means the typical weight of this trailer as built at the factory. The UVW, as used in product literature and other promotional materials, does not include cargo, fresh water, LP gas, options, or dealer-installed accessories.

Gross Vehicle Weight Rating (GVWR): GVWR means the maximum permissible weight of the trailer, including the UVW plus passengers, personal items, all cargo, fluids, options, and dealer-installed accessories. The GVWR is equal to or greater than the sum of the UVW and the CCC.

Cargo Carrying Capacity (CCC): CCC means the maximum weight of all passengers, personal items, food, fresh water, LP gas, tools, other cargo, and dealer-installed accessories* that can be carried by the trailer. CCC is equal to or less than GVWR minus UVW.

*The addition of options will decrease the CCC.

It is important for your safety and enjoyment that your tow vehicle be adequately sized and equipped to tow and handle the GVWR of the RV you select. Review weights and rating of your tow vehicle and consult a competent advisor for questions

or advice. Whether you are new to RVing or a veteran, get a feel for the performance of your tow vehicle and the RV together before heading out on the roadways. When you tow an RV, you must drive differently than you do when driving a single vehicle. Practice hooking up, driving, backing up, and braking in a safe environment or seek out professional instruction.

See specification chart above. Jayco affixes a weight label to each RV which lists weight information for that vehicle.

CUSTOMER FIRST ROADSIDE ASSISTANCE

Travel worry-free in your Eagle recreational vehicle with Jayco's Customer First Roadside Assistance program, yours at no cost during your first year of ownership. This program is offered through Coach-Net®, the largest RV emergency road service in the country, and gives you immediate access to dependable roadside assistance and support services with a simple phone call.

EMERGENCY ROADSIDE ASSISTANCE

- 24-hour Toll-free Emergency Message Service
- \$500 Trip Interruption Reimbursement
- Toll-free Nationwide Service Appointment Assistance
- Free Custom Trip Routing and Full Color Map Service
- Free Dispatch of On-Site Mechanical Service
- Free Jump Starts
- Free Tire Changes
- Free Fuel Delivery
- Free Lockout Service
- Free Travelers Checks
- \$1,000 Auto Theft or Hit-and Run Reward

2005 EAGLE
NOW YOU'RE GOING PLACES.



2 + 3 WARRANTY



The Jayco 2+3 Warranty is a manufacturer's limited warranty. It doesn't come from your dealer and it's not an extended warranty! It comes from the people who build Jayco recreational vehicles to the people who buy them. Each Jayco is warranted to the original purchaser for twenty-four (24) months from the date of purchase against defects in materials and workmanship. The Jayco warranty includes a limited three-year (3) structural guarantee and, in addition, our limited warranty may be transferred one time within the first two (2) years. Go ahead and compare the Jayco warranty with other manufacturers' warranties. You'll find it's the best in the business!

For a copy of the limited warranty with full terms and conditions, ask your local Jayco dealer or visit our web site at www.jayco.com.



FAMILY OWNED. FAMILY FOCUSED.

Jayco, Inc.
P.O. Box 460
Middlebury, IN 46540

www.jayco.com



Ask your dealer about the Jafari "flight" in your area, write to Jayco directly, or visit our web site.

As a Jayco owner, you can be part of the Jayco Jafari International Travel Club.

Please Note: All information in this brochure is the latest available at the time of publication approval. Jayco reserves the right to make changes and to discontinue models without notice or obligation.

Photos in this brochure may show optional equipment. RVs built for sale in Canada may differ to conform to Canadian codes. See dealer for additional information and prices.



©2005 Jayco, Inc. 0501001.2005-6/15/04-100m Printed in the U.S.A.