

**JAY FEATHER**  
2006 Ultra Lite Weight Travel Trailers

THE ULTRA LITE WEIGHT CHAMPION

2006 ULTRA LITE WEIGHT TRAVEL TRAILERS JAY FEATHER



AMERICA'S MOST LIVEABLE RVs.



# JAY FEATHER EXP

2006 Ultra Lite Travel Trailers by Jayco®

To find out more about America's Most Liveable RVs, visit [www.jayco.com](http://www.jayco.com)

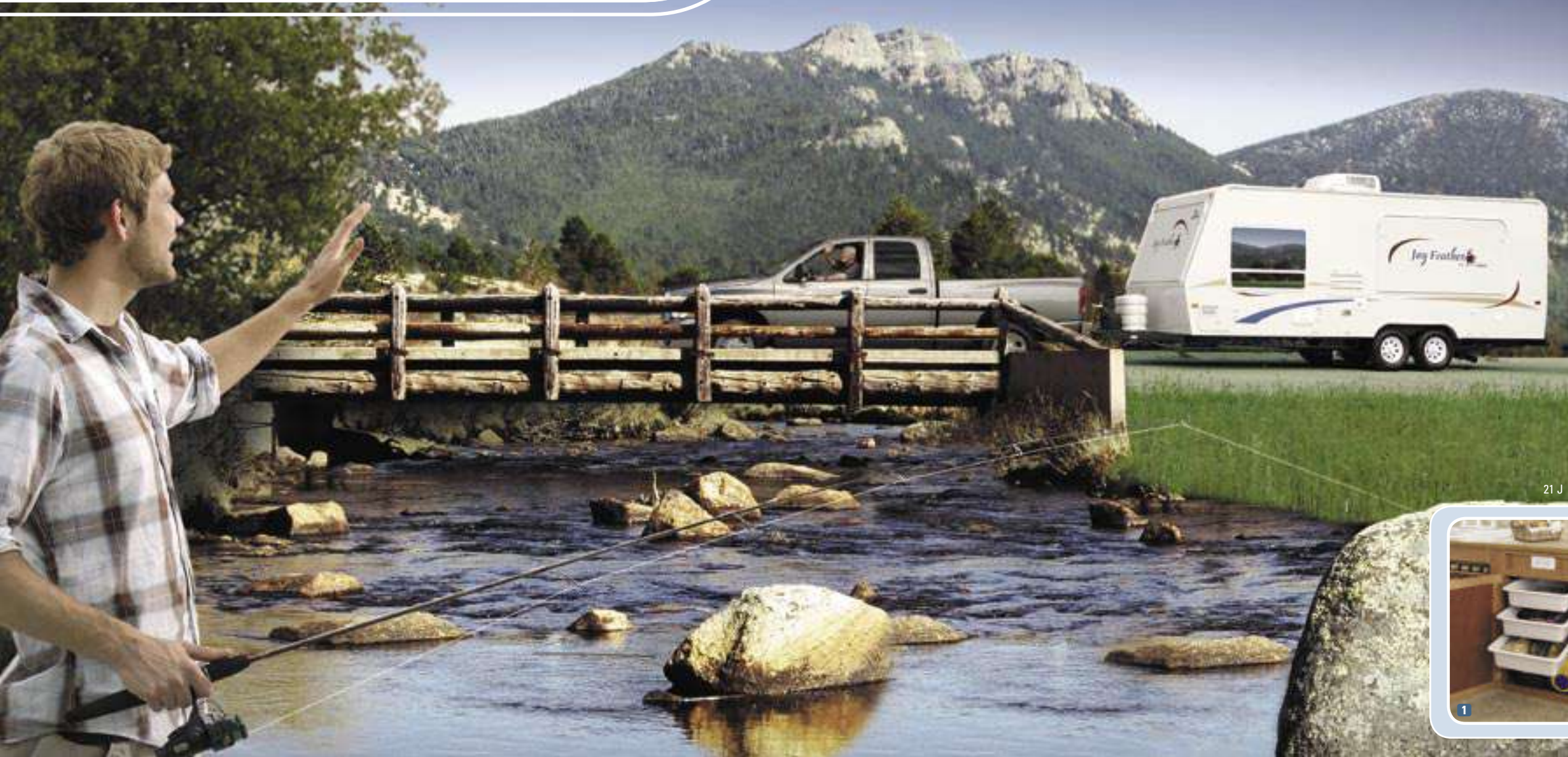

## LIGHT AS A FEATHER. SOLID AS A ROCK.

Just because you can tow a Jay Feather EXP Ultra Lite Weight Travel Trailer with a minivan or SUV doesn't mean we left anything out. Aerospace materials and construction techniques keep the weight down, while ingenious floorplan design keeps the comfort level high.



21 J



1. The kitchen pantry features lightweight, removable plastic tub drawers to make organizing all of your food essentials easy.
2. Our exclusive MaxiStor™ system, with an oversize outer door, gives you plenty of storage room beneath a rear bunk.

**Customer Value Package** (Included on all EXP models)

- 6-gal. gas/electric DSI auto-ignition water heater
- 13,500 BTU A/C
- Carefree® patio awning
- Molded ABS propane gas bottle cover
- Microwave oven with carousel
- Spare tire and tire carrier
- Stabilizer jacks (2 pair) with sand pads
- Powered attic fan in bathroom
- AM/FM/CD stereo with 2 speakers
- Outside shower
- Oversized oven
- Bi-fold cover for range
- ABS tub surround



AMERICA'S MOST **LIVEABLE** RVs.  
 "Liveable," to our customers, it could mean comfort. To our designers, it's a refined, ergonomic floorplan. For those who build them, they see value. The definition is most likely "all of the above" ...and then some.

**THE ULTRA LITE WEIGHT CHAMPION**





# JAY FEATHER LGT

2006 Ultra Lite Travel Trailers by Jayco®

To find out more about America's Most Liveable RVs, visit [www.jayco.com](http://www.jayco.com)

## MORE SPACE. MORE LUXURY.

The LGT means a spacious living room, a queen size bed you can actually walk around and a kitchen you'd be happy to have in your own home. Add some "must haves" like a Dolby® Surround Sound theater system with DVD player and you still can tow all of this with your full size SUV\*.



29 N



29 N



1. Relax and unwind after a fun-filled day in the comfy, walk-around queen bed.
2. The residential-style bathroom looks and feels like home; and comes standard with a medicine cabinet with mirror and powered attic fan (included in the Customer Value Package).
3. The Jay Feather's spacious kitchen includes a 3-burner range top, oversized oven and microwave oven (included in the Customer Value Package).

\*Please refer to your automobile manufacturer specifications for your vehicle's tow rating.



### Customer Value Package

- |   |   |  |
|---|---|--|
| <ol style="list-style-type: none"> <li>1 • 312 coil Innerspring mattress with bed struts</li> <li>• 6-gal. gas/electric DSI auto-ignition water heater</li> <li>• 13,500 or 15,000 BTU central A/C</li> <li>• Dolby® Digital 5.1 Surround Sound home theater system/DVD</li> <li>• Attic fan in bathroom</li> </ol> | <ol style="list-style-type: none"> <li>2 • Chrome wheels</li> <li>3 • Carefree® patio awning</li> </ol> | <ul style="list-style-type: none"> <li>• Outside shower</li> <li>• Oversized oven</li> <li>• ABS tub surround</li> <li>• Bi-fold cover for range</li> <li>• Molded ABS propane gas bottle cover</li> </ul> |
|---|---|--|

## THE ULTRA LITE WEIGHT CHAMPION





# JAY FEATHER SPORT

2006 Ultra Lite Travel Trailers by Jayco®



## THE PERFECT WEEKENDER.

Shrink a full size travel trailer down to around 19 feet ... but keep everything. Full kitchen, bathroom with tub/shower surround and plenty of sleeping for a family of up to 5.



165

The Jay Feather Sport's kitchen has everything you need to cook great meals while on the road, including a flush-mounted 5-cu.-ft. refrigerator, 3-burner range with 9,000-BTU SuperBurner™ and piezo igniter, microwave oven and optional oversize 17" oven.



Over the bed there is a bunk that can hold up to 300 lbs. The bathroom includes all the comforts of home, including a medicine cabinet with mirror and ABS tub/shower surround.

## Customer Value Package (Included on all Sport models)



- 13,500-BTU A/C
- Carefree® patio awning
- AM/FM/CD stereo with 2 speakers
- Spare tire with carrier and vinyl cover

165

# JAY FEATHER BAJA

2006 Ultra Lite Travel Trailers by Jayco®



## IT FOLLOWS YOU EVERYWHERE.

High ground clearance, aggressive tires and an outdoor Bike-Port™ for hauling several bikes or even an ATV. Tough outside, comfortable inside.



1



2



3

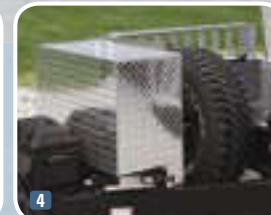

4

1. The Jay Feather Baja features the new Bike-Port™. The locking gate system is great for transporting motorcycles or ATVs.
2. The Bike-Port™ easily folds down to reveal a ramp that makes getting your vehicles from the RV to the land effortless.
3. The Baja's rear storage compartment helps to keep all of your adventure gear organized and accessible.
4. The Baja's rugged diamond plate protects the front end from road debris.

## Customer Value Package (Included on all Baja models)

- 6-gal. gas/electric DSI auto-ignition water heater
- Microwave oven with carousel
- Powered attic fan in bathroom
- AM/FM/CD stereo with 2 speakers
- Carefree® patio awning
- Spare tire and tire carrier
- Molded ABS propane gas bottle cover
- Stabilizer jacks (2 pair) with sand pads
- Bi-fold cover for range
- ABS tub surround
- Outside shower
- 13,500 BTU A/C
- Oversized oven

25K





# JAY FEATHER

2006 Ultra Lite Travel Trailers by Jayco®

## 2006 Standard and Optional Features

### Standard Bathroom Equipment

- 12V roof vent
- Holder for towels
- Marine toilet with foot flush
- Medicine cabinet with mirror
- Shower curtain
- Skylight in tub/shower (select models)
- ABS tub surround

### Standard Bedroom Equipment

- Bi-fold privacy door
- Molded storage tubs under bed base
- Quilted bedspread
- Roof vent
- TV shelf (select models)
- Shirt wardrobe
- Deep quilted cushions for bunk(s)
- Fan Lights in bunk (2)

### Standard Interior Equipment

- Cable TV hookup with RG6 coax
- Choice furniture, designed and made by Jayco®
- Crank-up antenna with signal booster
- Manchester Oak, flat-panel doors and drawers
- Mini-blinds
- Overhead cabinetry is slanted (when possible)
- Swivel rockers (2) (29N)
- Vinyl flooring
- Quilted bed mat

### Standard Kitchen Equipment

- Microwave oven with carousel
- 3-burner range with 9000-BTU SuperBurner™ and piezo igniter
- 6-cu.ft. flush-mount refrigerator
- 5-cu.ft. flush-mount refrigerator
- Cover for sink/cutting board (1)
- High-rise, mixing faucet
- Range hood with light and exhaust fan

- White, residential-style, double-bowl kitchen sink with 1 cover
- Wallpaper border
- Oversized drawer in U-dinette

### Standard Construction Features

- 5/8" Seamless Structurwood mainfloor decking
- 78" ceiling height
- Bead-foam insulation (R-7 roof/floor, R-7 walls)
- Cabinetry crafted with screwed stile construction
- Electric-powered slideout (select models)
- Enclosed underbelly
- FRP smooth fiberglass sidewall exteriors
- One-piece, seamless, TPO roof
- PolyFlex™ one-piece covering for underbelly
- TuffShell™ vacuum-bond laminated roof, floor & sidewalls
- Unitized, 1-1/2" laminated construction of floor
- Welded tubular aluminum sidewall framework
- Weld-free modular HSLA steel frame with E-Coat™ protection

- 2 Cable support system for bunk ends

### Standard Exterior Equipment

- 110V G.F.C.I. protected exterior receptacle
- 14" radial tires
- 13" radial tires
- 2-5/16" hitch coupler
- 2" hitch coupler
- ABS fender skirts
- Baggage doors, lockable, insulated and radius-cornered with heavy-duty grab handles
- 3 E-Z Lube® axles
- Fiberglass, radius-cornered entrance door and screen door
- Front window with flush-mounted stone guard
- HDPE wheel wells
- Metal wheel wells
- 4 Heavy-duty, retractable entrance step
- Molded ABS bumper cover

- Molded rain guttering with drip spouts
- Painted bottom radius skirting
- 5 Pass-through storage compartment
- Patio light with inside switch
- Sewer hose storage compartment
- TorFlex® independent torsion-axle rubber ride suspension system
- Camper-Tex™ water-repellent one-piece vinyl tent
- Composite bumper extensions
- Lockable end-bunks
- MaxiStor™ (26L only)
- White spoked wheels
- Prep for RVQ® outside grill
- Stabilizer jacks (2 pair) with sand pads

### Standard Safety Equipment

- Breakaway switch
- Carbon monoxide detector
- Dual hitch safety chains
- Fire extinguisher
- Lock and dead bolt on entrance door
- Propane/gas leak detector
- Multiple egress windows
- Smoke detector
- Tinted safety glass windows

### Standard Heat, Power and Water Equipment

- 12V demand water pump
- 12V electrical system with deluxe 110V 45-amp power converter
- 30-amp power cord
- Auto-ignition furnace with wall thermostat
- Double 30-lb. propane gas bottles, with auto regulator
- Double 20-lb. propane gas bottles, with auto regulator
- 20-lb. propane gas bottle
- Gravity fill for water
- Hookup for city water
- Monitor panel for all systems
- Rotocast fresh water holding tanks

- Water heater bypass system
- Winterization kit
- Outside shower
- 18,000 BTU furnace with auto-ignition

### Optional Equipment

- Carpeting in bedroom
- Double bed
- 6 Drawer for exterior storage
- 7 Exterior entertainment center
- 8 Portable, outside gas RVQ® grill with carrying case
- Water purification system
- 17" oven
- CSA Standards
- Customer Value Package
- Water purification system
- 2800 Watt generator
- Heated bed Mats (2) (n/a 26L EXP)
- Heated bed Mats (1) (26L EXP only)

### Customer Value Package

- 312 coil Innerspring mattress with bed struts
- 6-gal. gas/electric DSI auto-ignition water heater
- A/C central (13,500 or 15,000 BTU) with wall thermostat
- A/C (13,500 BTU) with wall thermostat
- ABS tub surround
- Bi-fold cover for range
- Carefree® patio awning
- Chrome wheels
- Cover for propane gas bottle made of molded ABS
- Dolby® Digital 5.1 Surround Sound home theater system with DVD
- Microwave oven with carousel
- Outside shower
- Oversized oven
- Spare tire and tire carrier
- Stabilizer jacks (2 pair) with sand pads
- AM/FM/ stereo with 2 speakers
- 9 Powered attic fan in bathroom

## Tow Ratings\*

The following tow ratings are the highest available for the respective 2004 model year vehicles shown. Certain optional equipment may be required and other restrictions may apply. Consult the latest manufacturer's towing guide (available at your automotive dealership) or your vehicle owner's manual to verify the tow ratings provided.

Model	Engine	Tow Capacity	Model	Engine	Tow Capacity	Model	Engine	Tow Capacity
<b>ACURA</b>			Crew Cab	3.5L I-5	4,000	<b>LAND ROVER</b>		
MDX	3.5L V-6	NA/3,500	Denali/Silverado SS	6.0L V-8	NA/8,100	LR3	4.4L V-8	NA/5,500
<b>BMW</b>			Escalade EXT	6.0L V-8	NA/7,300	Freelander	2.5L V-6	NA/2,500
X3	3.0i 3.0L I-6	NA/3,500	Sierra/Silverado1500	4.8L V-8	8,000	Range Rover	4.4L V-8	NA/5,500
X5 4.8is	4.6L V-8	NA/6,000	1500 Crew Cab	5.3L V-8	7,500	<b>LEXUS</b>		
<b>DAIMLER/CHRYSLER</b>			Silverado SS/Denali	6.0L V-8	NA/8,100	GX 470	4.7L V-8	NA/6,500
Dakota			Aztek	3.4L V-6	3,500	LX 470	4.7L V-8	NA/5,000
Club Cab	4.7L V-8	7,150/6,950	Blazer 2-door	4.3L V-6	5,700/5,400	<b>MAZDA</b>		
Quad Cab	4.7L V-8	7,000/6,850	Envoy XUV, XL, TrailBlazer EXT	4.2L I-6	6,000/5,800	B2300	2.3L I-4	2,260/NA
1500 Reg Cab	5.7L	V-8 9,250/8,850	Envoy/TrailBlazer	5.3L V-8	7,000/6,500	B3000	3.0L V-6	2,640/2,300
1500 Quad Cab	5.7L V-8	8,900/8,600	Equinox	3.4L V-6	3,500	B4000	4.0L V-6	5,980/5,660
Durango	5.7L V-8	8,950/8,650	Escalade	6.0L V-8	NA/8,100	Tribute	3.0L V-6	3,500
Grand Cherokee	5.7L V-8	NA/7,200	H1 Station Wagon	6.5L V-8 TD	7,409	<b>MITSUBISHI</b>		
Liberty	3.7L V-6	5,000	H2	6.0L V-8	6,700	Montero	3.8L V-6	NA/5,000
G-Class	5.4L V-8 SC	NA/7,000	Rainier	5.3L V-8	6,700/6,500	<b>NISSAN</b>		
GST	3.7L V-6	3,500	Rendezvous All	3.500 EST	8,000	Armada	5.6L V-8	9,100
ML350	3.7L V-6	NA/6,200	SRX	4.6L V-8	4,250	Frontier	4.0L V-6	6,000
Pacifica	3.8L V-6	3,500/NA	Suburban/			Murano	3.5L V-6	3,500
Wrangler	4.0L I-6	NA/2,000	Yukon XL 1500	5.3L V-8	8,400/8,100	Pathfinder	4.0L V-6	6,000
Wrangler Unlimited	4.0L I-6	NA/3,500	Tahoe/Yukon	5.3L V-8	7,700/7,800	Titan Crew Cab	5.6L V-8	9,400
Caravan LWB	3.8L V-6	3,800/3,500	Yukon Denali	6.0L V-8	8,200	Xterra	4.0L V-6	5,500
Town & Country LWB	3.8L V-6	3,800	VUE	3.5L V-6	2,500	<b>SUBARU</b>		
Sprinter 2500	2.7L I-5	5,000/NA	Astro/Safari CV	4.3L V-6	5,700/5,500	Outback H6	3.0L H-6	3,000
<b>FORD/LINCOLN/MERCUY</b>			G1500 PV	5.3L V-8	6,000/NA	<b>SUZUKI</b>		
Explorer Sport Trac	4.0L V-6	5,300/5,080	G2500 PV	6.0L V-8	8,000/NA	Vitara	2.5L V-6	2,000
F-150 Reg Cab	5.4L V-8	9,900/9,500	Montana/Venture	3.4L V-6	3,500	XL-7	2.7L V-6	3,000
F-150 SuperCab	5.4L V-8	9,500/9,300	<b>HONDA</b>			<b>TOYOTA</b>		
F-150 SuperCrew	5.4L V-8	9,500/9,200	Odyssey	3.5L V-6	3,500	4Runner	4.7L V-8	7,300/7,000
Ranger	4.0L V-6	5,980/5,660	Pilot	3.5L V-6	3,500	Land Cruiser	4.7L V-8	NA/6,500
Aviator	4.6L V-8	5,000/7,100	<b>INFINITI</b>			Sequoia	4.7L V-8	6,500/6,200
Escape	3.0L V-6	3,500	FX35	3.5L V-6	3,500	Sienna	3.3L V-6	3,500
Expedition	5.4L V-8	8,900/8,600	FX45	4.5L V-8	NA/3,500	Tacoma Reg Cab	4.0L V-6	6,500
Explorer	4.6L V-8	7,140/7,000	QX56	5.6L V-8	9,000/8,900	Tacoma Access/Dbl. Cab	4.0L V-6	6,500
Mountaineer	4.6L V-8	7,040/6,900	<b>ISUZU</b>			Tundra Reg Cab	4.7L V-8	NA/7,200
Navigator	5.4L V-8	8,600/8,300	Ascender	5.3L V-8	6,800/6,300	Tundra Access Cab	4.7L V-8	7,100/6,900
E-150	5.4L V-8	6,500/NA	Axiom	3.5L V-6	4,500	Tundra Double Cab	4.7L V-8	6,800/6,500
E-250 CV	5.4L V-8	7,500/NA	Rodeo	3.2L V-6	4,500	<b>VOLKSWAGEN</b>		
E-350 CV	5.4L V-8	7,300/NA	<b>KIA</b>			Eurovan	2.8L V-6	NA/4,400
<b>GENERAL MOTORS</b>			Sedona	3.5L V-6	3,500/3,500	Touareg	5.0L V-10 TDI	NA/7,716
Avalanche 1500	5.3L V-8	8,200/7,900	Sorento	3.5L V-6	3,500	<b>VOLVO</b>		
Canyon/Colorado	3.5L I-5	4,000	Sportage	2.0L I-4	2,000	XC70	All	3,300
						XC90	All	5,000

\*This information repurposed with permission from Trailer Life.  
© 2004, TL Enterprises, Inc., 2575 Vista Del Mar Dr., Ventura, CA 93001



THE ULTRA LITE WEIGHT CHAMPION

# JAY FEATHER FLOORPLANS

2006 Ultra Lite Travel Trailers by Jayco®

## 2006 Ultra Lite Travel Trailer Floorplans

### EXP Floorplans

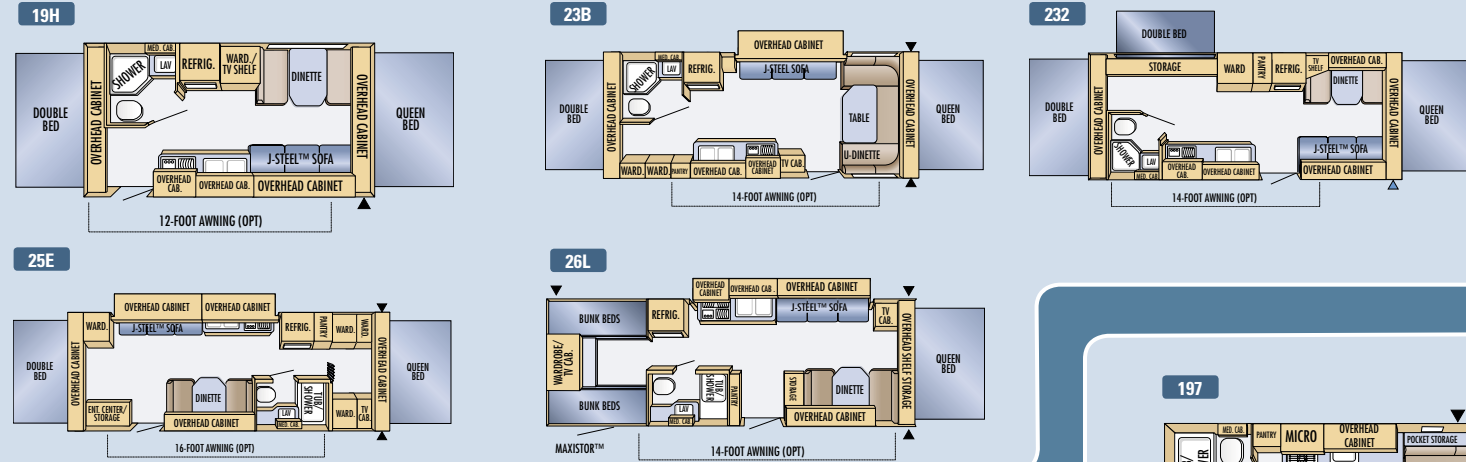

### Sport Floorplans

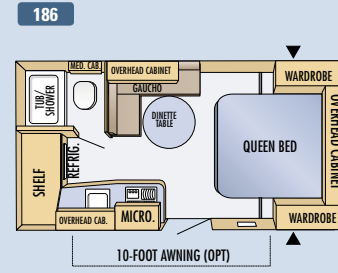
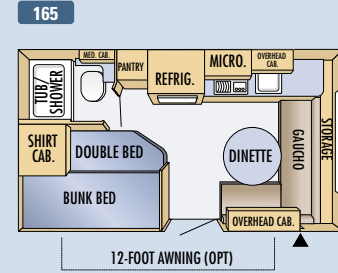

### LGT Floorplans

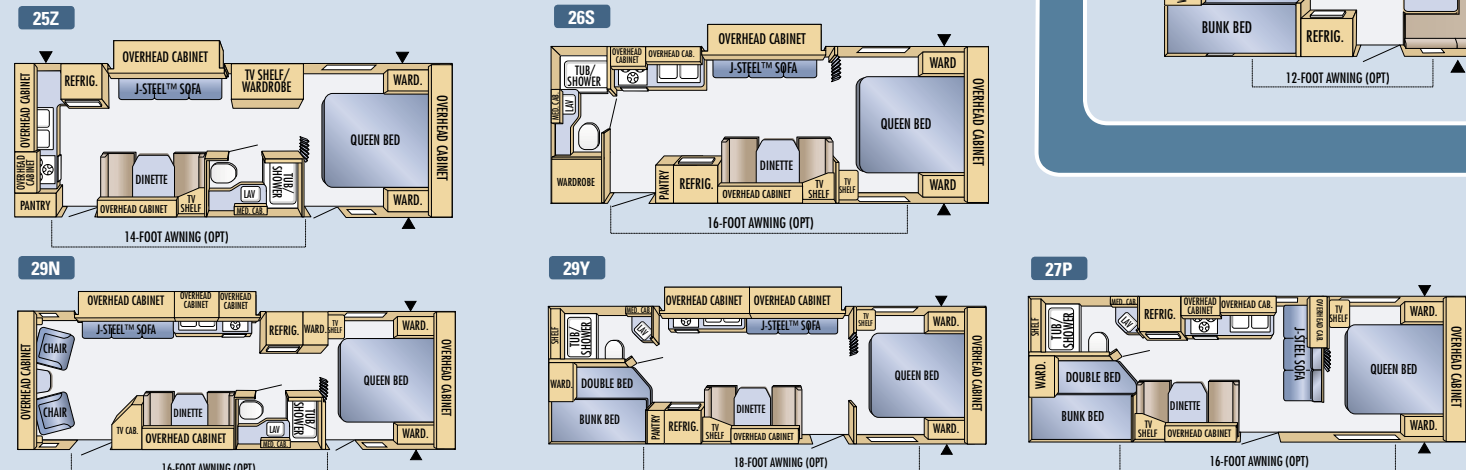

### Baja Floorplan

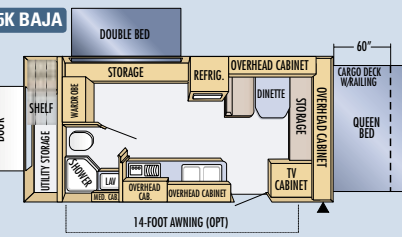

### LEGEND

○ = Carpeted Areas ▲ = Outside Storage Compartments LAV. = Bathroom Sink MICRO. = Microwave OHC = Overhead Cabinets REFRIG = Refrigerator WARD. = Wardrobe

For the latest in the most liveable floorplans available, visit

[www.jayco.com](http://www.jayco.com)

## Interior Color Options

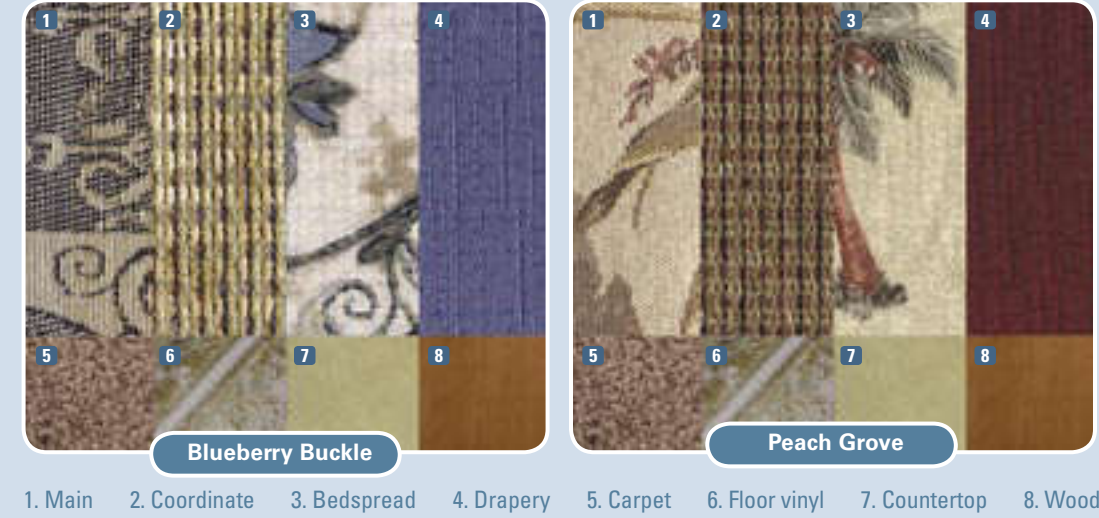

## Jay Feather Specifications

	Models	Exterior Travel Length	Exterior Campsite Length	Exterior Height	Exterior Height with opt. AC	Interior Headroom	Unloaded Vehicle Weight	Dry Hitch Weight	Gross Vehicle Weight Rating	Cargo Carrying Capacity	Fresh Water Capacity*	Gray Water Capacity	Toilet/Black Wastewater Capacity
Sport	165	18' - 0"	—	105"	114"	78"	2781	405	3500	719	30	30	11
	186	19' - 0"	—	105"	114"	78"	2920	320	3750	830	30	30	11
	197	19' - 0"	—	105"	114"	78"	2935	390	3750	815	30	30	11
EXP	23 B	23' - 11"	27'	105"	114"	78"	3990	390	4950	960	30	29	22
	232	NA	NA	NA	NA	NA	NA	NA	NA	NA	NA	NA	NA
	25 E	26' - 3"	29' - 3"	103"	117"	78"	4525	695	5800	1275	30	29	22
	19 H	20' - 2"	23' - 4"	106"	116"	78"	3480	405	4550	1070	30	22	22
	25 K Baja	28' - 8"	25' - 11"	114"	122"	78"	4380	490	6500	2120	30	29	22
	26 L	27' - 7"	27' - 2"	108"	117"	78"	4475	770	5800	1325	30	22	22
LGT	29 N	30' - 8"	—	110"	119"	78"	5120	765	6500	1380	36	30	22
	27 P	29' - 3"	—	110"	119"	78"	4580	690	6000	1420	36	30	22
	26 S	27' - 3"	—	110"	119"	78"	4435	560	6000	1565	36	30	22
	29 Y	30' - 8"	—	110"	119"	78"	4970	530	6500	1530	36	30	22
	25 Z	27' - 7"	—	110"	119"	78"	4690	635	6000	1310	36	30	22

## Customer First Roadside Assistance

Travel worry-free in your Jay Feather travel trailer with Jayco's Customer First Roadside Assistance program, yours at no cost during your first year of ownership. This program is offered through Coach-Net®, the largest RV emergency road service in the country, and gives you immediate access to dependable roadside assistance and support services with a simple phone call.

### Emergency Roadside Assistance

- 24-hour toll-free emergency message service
- \$500 trip interruption reimbursement
- Toll-free nationwide service appointment assistance
- Free custom trip routing and full color map service
- Free dispatch of on-site mechanical service
- \$1,000 auto theft or hit-and-run reward
- Free jump starts
- Free tire changes
- Free fuel delivery
- Free lockout service
- Free travelers checks



**Unloaded Vehicle Weight (UVW):** Sometimes referred to as "Dry Weight," UVW means the typical weight of this trailer as built at the factory. The UVW, as used in product literature and other promotional materials, does not include cargo, fresh water, LP gas, options, or dealer-installed accessories.

**Gross Vehicle Weight Rating (GVWR):** GVWR means the maximum permissible weight of the trailer, including the UVW plus passengers, personal items, all cargo, fluids, options, and dealer-installed accessories. The GVWR is equal to or greater than the sum of the UVW and the CCC.

\*Includes water heater capacity

**Cargo Carrying Capacity (CCC):** CCC means the maximum weight of all passengers, personal items, food, fresh water, LP gas, tools, other cargo, and dealer-installed accessories that can be carried by the trailer. CCC is equal to or less than GVWR minus UVW. The addition of options will decrease the CCC.

**Hitch Weight (HW):** The hitch weight, as used in product literature and other promotional materials, does not include cargo, fresh water, propane gas, options or dealer-installed accessories. The addition of these types of items will either add to or subtract from the stated hitch weight.

It is important for your safety and enjoyment that your tow vehicle be adequately sized and equipped to tow and handle the GVWR of the RV you select. Review weights and rating of your tow vehicle and consult a competent advisor for questions or advice. Whether you are new to RVing or a veteran, get a feel for the performance of your tow vehicle and the RV together before heading out on the road. When you tow an RV, you must drive differently than you do when driving a single vehicle. Practice hooking up, driving, backing up, and braking in a safe environment or seek out professional instruction. Jayco affixes a weight label to each RV which lists weight information for that vehicle. **See specification chart above.**



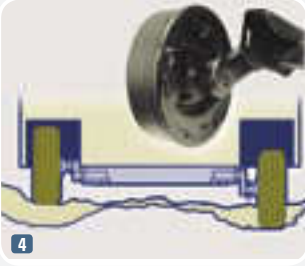

### Built to Last.

1. Our corrosion-resistant frames are finished with a 12-stage E-Coat™ finishing system and come with a lifetime warranty.
2. Our TuffShell™ walls and floor are constructed using a vacuum-bonded lamination process. TuffShell™ construction results in a smoother finish and a more durable body than traditional pinch-roller construction.
3. The Jay Feather frame is 10-15% lighter and significantly more rigid than the frame of conventional travel trailers. Tapered rails place the strongest part of the frame over the axles. Instead of welding, our modular frame design features “huck” bolt assembly and interlocking dimples.
4. Tor-Flex® independent torsion-axle suspension gives more ground clearance, provides a smooth ride, makes towing easier and reduces wear and tear by absorbing bumps.
5. Our one-piece PolyFlex™ underfloor covering design protects your Jay Feather from road debris and improves aerodynamics.
6. Jayco has been blessed with some of America’s finest craftsmen who make Middlebury, Indiana and the Jayco plant their home and workplace. Generation after generation, a legacy of tried-and-true construction methods is passed down, continuing the tradition of quality and durability that has helped Jayco grow into a true industry leader.



### We Back What We Build.

The Jayco Co-Pilot Warranty is a manufacturer’s limited warranty. It doesn’t come from your dealer and it’s not an extended warranty! It comes from the people who build Jayco recreation vehicles to the people who buy them. Each Jayco is warranted to the original purchaser for twenty-four (24) months or twenty-four thousand (24,000) miles (mileage limitation applies to motorized products only), whichever occurs first, from the original date of purchase against defects in materials and workmanship. In addition, our limited warranty may be transferred one time within the warranty period. Go ahead and compare the Jayco warranty with other manufacturers’ warranties. You’ll find it’s the best in the business!

For a copy of the limited warranty with full terms and conditions, ask your local Jayco dealer or visit our website at [www.jayco.com](http://www.jayco.com).

### Your Jayco Dealer

See above dealer for further information and prices.

As a Jayco owner, you can be part of the Jayco Jafari International Travel Club. Ask your dealer about the Jafari “flight” in your area, write Jayco, or visit our web site.



**Please Note:** All information in this brochure is the latest available at the time of publication approval. Jayco reserves the right to make changes and to discontinue models without notice or obligation. Photos in this brochure may show optional equipment. RVs built for sale in Canada may differ to conform to Canadian codes.



©2006 Jayco, Inc. 06-JFTR-PL 0705-100K Printed in U.S.A.

RVQ is a registered trademark of Vitco, Inc. E-Z Lube is a registered trademark of the Dexter Axle Company. Carefree is a registered trademark of Carefree of Colorado. Dolby and the double-D symbol are registered trademarks of Dolby Laboratories.



AMERICA’S MOST LIVEABLE RVs.