

JAY SERIES™ • SELECT™ • BAJA™

2006 Camping Trailers by Jayco®

LIVEABLE CAMPING TRAILERS



AMERICA'S MOST LIVEABLE RVs.

JAY SERIES | SELECT | BAJA | 2006 Camping Trailers

Jay Series™
2006 Camping Trailers by Jayco®



AMERICA'S MOST **LIVEABLE** RVs.

"Liveable," to our customers, it could mean comfort. To our designers, it's a refined, ergonomic floorplan. For those who build them, we see value. The definition is most likely "all of the above" ...and then some.



1206

GET COMFORTABLE WITH NATURE.

Camping trailers and the word "comfort" have rarely been seen in the same sentence, let alone a dealer showroom. Until now. Introducing the Jay Series.

Outside you have the patented, tubular lifting system and a one-piece Camper-TeX™ tent. Inside, you have the famous Jayco comfort of a travel trailer.



1207



1



2

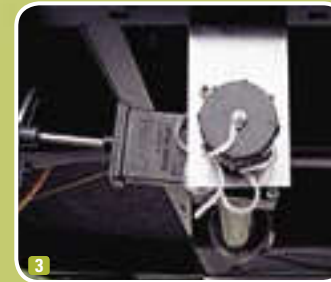

3

1. Our Camper-TeX™ one-piece Velcro® tent attachment system seals tightly, keeping the warmth in and the rain and insects out.
2. The secure retractable step makes getting in and out simple and safe.
3. A 17-gallon water tank is positioned beneath the floor in order to maximize cabinet storage space.

~~LIVEABLE CAMPING TRAILERS~~



Select™

2006 Camping Trailers by Jayco®

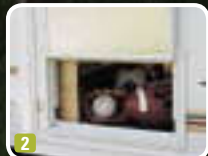
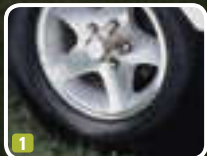

MORE THAN FUN IS INCLUDED.

1. The Select comes with many attractive touches like polished aluminum rims. 2. Store extra items in the large space underneath the dinette area. Storage is accessible from both the inside and outside. 3. The front trunk storage area is perfect for storing long items, such as skis or golf clubs. This storage area is also accessible from inside of the camper and outside through the baggage door.



ENJOY THE WIDE-OPEN SPACES.

The Jayco Select is all about space. Higher walls get countertops up to "home" level allowing for larger refrigerators, more headroom and lets cooktops become full ranges. The wide-body construction also adds more storage space and storage of larger items.



1. The standard microwave and the optional oven and range allow you to cook your favorite meals while you're on the road.
2. Select includes a large 3-cu.-ft, 3-way refrigerator that keeps your favorite travel foods cold and fresh.
3. Courtesy floor lights help your family get around safely during the night.

LIVEABLE CAMPING TRAILERS



Baja™

2006 Camping Trailers by Jayco®



Baja
by Jayco

NO ROAD? NO PROBLEM.

You want to rough it. You crave the real camping experience, far away from campsites and groomed trails. For you, the ultimate adventure is shooting down a mountain on a bike or scaling a sheer cliff. No matter how far-flung your destination, the Baja camping trailer will get you there.



IT FOLLOWS YOU EVERYWHERE.

Here's what you need to know. 13 inches of ground clearance, running on 15" off-road Dunlops, all suspended by shocks and leaf springs ... siick!

If that's not enough, how about an outdoor Bike-Port™, big enough for two bikes or an ATV! ... ramps included.



10Y



1. Conquer the roughest terrain with 15" Dunlop® Mud Rover off-road tires. Dent-proof rubber fenders and protective mud flaps are also standard.
2. Store your adventuring essentials in the optional diamond plate tool box.
3. Going off the beaten path is no problem for the Baja camping trailer, thanks to its shock absorbers and leaf springs.

LIVEABLE CAMPING TRAILERS



Jay Series™ • Select™ • Baja™

2006 Camping Trailers by Jayco®

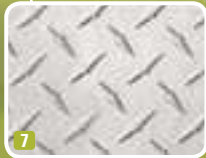

1. Jayco's unique Velcro® tent-to-bunk end attachment system is stronger than the bungee cord system used by competitors. 2. You won't have to crouch down and reach underneath the camper, thanks to our crank-down stabilizer jacks. 3. The optional powered attic fan in the bathroom improves ventilation. 4. EZ Lube® axles with removable caps make maintenance a snap. 5. The single-piece Structurwood® floor is undercoated and edge-sealed to repel moisture and maintain its durability. It comes with a lifetime warranty. 6. Spills are no match for our reversible, anti-slide dinette cushions with vinyl backs. Simply wipe off or remove for a more thorough cleaning. 7. The front diamond plate and sturdy LP gas bottle cover protect the front end from road debris. 8. Jayco's rugged end bunks can handle a substantial amount of weight (1,050 lb. capacity per bunk). The bunks, made from 5-ply exterior-grade, weather-treated plywood, are mounted on steel slides with smooth rollers to make it easy to set up in minutes.

Where Durability and Livability Meet.



Jayco's Patented, Fully Enclosed Roof Lifter System

- a. Jayco uses tubular lifter posts instead of C-channels. They have smooth walls and no edges to chafe or soil the tent with grease. They also have no openings. Fingers can't get inside, eliminating the chance of injury!
- b. Stop worrying about cables or pulleys getting caught in lifter posts. Strong flexible steel push-rods guide the roof up as you crank.
- c. For years of trouble-free operation, Jayco camping trailers use nylon bushings in the lifter posts. This reduces friction, wear, and tear.
- d. The automatic brake on our lifter system winch helps prevent the roof from falling before it's all the way up so it's OK to take a break while cranking.
- e. Our lifter system crank is set at an ergonomic height. You don't have to bend way over or scrape your knuckles to use it. We also made it easier to turn, so setup is a cinch.
- f. The roof-lifter system on all Jayco camping trailers is fully enclosed above the floor. This eliminates damage to parts from road debris and weather as a result of transit—a common problem with competitors' underfloor-mounted lifter systems. It also eliminates rodent or insect access points found where competitors' cables pass through the floor.

9. Our patented, fully enclosed roof lifter system has a lifetime warranty and is easy to set up.

10. Jayco's exclusive TorFlex® independent torsion-axle suspension provides more ground clearance, simplifies towing and absorbs bumps that cause wear and tear.

11. Our robust, corrosion-resistant frames are finished with our 12-stage E-Coat™ finishing system and come with a lifetime warranty.

12. Double-laminated wall construction with wood backers reinforces the strength of sidewalls, protecting it from bows and dents. Unlike competitors' single wall, non-backed units, Jayco goes the extra mile by screwing the sidewalls to both the floor and frame.

13. Jayco's old-world Amish craftsmen build RVs with the same tried-and-true construction methods used for generations.

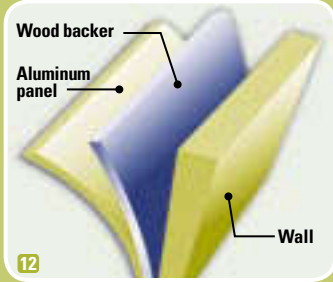
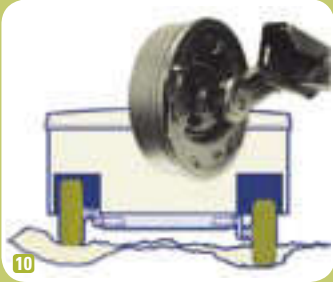

LIVEABLE CAMPING TRAILERS



Jay Series™ • Select™ • Baja™

2006 Camping Trailers by Jayco®

2006 Standard and Optional Features

JS=Jay Series S=Select B=Baja C=Camouflage

Standard Interior Features

	JS	S	B	C
12V high-intensity lighting	•	•	•	•
Automatic cut-off switch for interior lights	•	•	•	•
Bar for hanging clothes	•	•	•	•
Bed flaps that cover edge of bed	•	•	•	•
Bunk end bows with adjustable tension	•	•	•	•
Cable TV hookup with RG6 coax	•	•	•	•
Clear vinyl windows	•	•	•	•
Deep-quilted bunk cushions	•	•	•	•
Door pulls with roller catch	•	•	•	•
Drawers made of real wood with nylon guides	•	•	•	•
1 Bunk-end fan lights (1 or 2)	•	•	•	•
Floor-level courtesy lights	•	•	•	•
Coordinated furniture, designed and made by Jayco®	•	•	•	•
Hinged dinette seat bases	•	•	•	•
Manchester Oak cabinetry	•	•	•	•
Mildew-resistant aluminum ceiling	•	•	•	•
Non-sliding, 4" deep cushions for dinette with reversible EZ-clean™ vinyl backs	•	•	•	•
Prep for A/C	•	•	•	•
Privacy curtains for end-bunks	•	•	•	•
SoftShade™ window shades and valances	•	•	•	•
Vinyl flooring	•	•	•	•

Standard Kitchen Features

3-cu.ft. 3-way gas/electric refrigerator (110V/12V/LP)	•	•	•	•
6-gal. water heater (N/A 806)	•	•	•	•
Appliances are pre-plumbed for LP gas	•	•	•	•
Carry-out dinette table	•	•	•	•
Cutting board/sink cover (1)	•	•	•	•
Double-bowl white acrylic sink with high-rise faucet	•	•	•	•
2 Fluorescent light above sink	•	•	•	•
Microwave oven with carousel	•	•	•	•
Spice rack	•	•	•	•
Tray for silverware	•	•	•	•
White acrylic sink and faucet	•	•	•	•
White enamel carryout oven (2-burner, depending on model)	•	•	•	•

Standard Heat, Power and Water Features

12V electrical system with 20-amp. 110V converter	•	•	•	•
17 gal. fresh water system with demand pump	•	•	•	•
Double 20-lb. gas bottles with vinyl cover	•	•	•	•
Hookup for city water	•	•	•	•

Standard Exterior Features

	JS	S	B	C
110V G.F.C.I. protected exterior receptacle	•	•	•	•
12" C-range tires (806, 1007)	•	•	•	•
13" C-range tires (1006, 1207, 1206)	•	•	•	•
14" D-range tires	•	•	•	•
14" x 14" roof vent	•	•	•	•
15" off-road Dunlop® Mud Rover tires	•	•	•	•
3 20-lb. LP gas bottle	•	•	•	•
30-amp. power cord	•	•	•	•
Bumper made with welded steel construction	•	•	•	•
Camper-TEX™ water-repellent one-piece vinyl tent	•	•	•	•
Crank-down stabilizer jacks	•	•	•	•
Crank-down stabilizer jacks with sand pads	•	•	•	•
Diamond-plate walls on front and rear	•	•	•	•
Domed, fiberglass roof with no center seam	•	•	•	•
Double entrance step	•	•	•	•
E-Coat™ protected frame	•	•	•	•
Electric brakes (standard Jay Series 1206 only)	•	•	•	•
Entrance door access with roof lowered	•	•	•	•
Entrance door caddy	•	•	•	•
Entrance door is 1-piece construction	•	•	•	•
Extrusions for box top are painted (powder-coated) white with white corner caps	•	•	•	•
E-Z Lube® axles	•	•	•	•
Floor is undercoated and constructed of edge-sealed Structurwood™	•	•	•	•
Front storage deck with diamond-plate surface and deck railing	•	•	•	•
Jayco's original, fully enclosed lifter system	•	•	•	•
Leveling jacks and heavy-duty A-frame construction	•	•	•	•
Lifter post covers	•	•	•	•
Light in front trunk	•	•	•	•
Mud flaps	•	•	•	•
One-piece high-density polyethylene wheel wells	•	•	•	•
Outside shower (N/A 806)	•	•	•	•
Patio light with amber lens	•	•	•	•
Prep wiring for battery	•	•	•	•
Rear bumper made of 4" tubular steel	•	•	•	•
Rubber truck-style fenders	•	•	•	•
Scratch resistant, embossed aluminum exterior finish	•	•	•	•
Self-storing step	•	•	•	•
Shock absorbers (yellow)	•	•	•	•
4 Spare tire and tire carrier	•	•	•	•
Black, polished steel wheels	•	•	•	•

Standard Exterior Features (continued)

	JS	S	B	C
Storage compartment in front trunk (select models)	•	•	•	•
4 Tent attachment velcros around entrance door	•	•	•	•
Vinyl spare tire cover	•	•	•	•
Wide-body construction	•	•	•	•

Standard Safety Equipment

Breakaway switch	•	•	•	•
Carbon monoxide detector	•	•	•	•
Dual hitch safety chains	•	•	•	•
Fire extinguisher	•	•	•	•
LP/gas leak detector	•	•	•	•
Smoke detector	•	•	•	•

Optional Features

5 Bath/Shower option (1206 only) (10Y and 10C)	•	•	•	•
16,000 BTU furnace with auto-ignition and thermostat	•	•	•	•
CSA Standards	•	•	•	•
Deluxe screen room	•	•	•	•
U-Dinette	•	•	•	•
Drawer for exterior storage	•	•	•	•
Electric brakes (standard on 1206)	•	•	•	•
Extra table with pedestal leg (1007 and 1207 only)	•	•	•	•
6 Front storage box	•	•	•	•
Quilted, heated bed mats (2)	•	•	•	•
Hydraulic surge brakes (10Z adn 10D)	•	•	•	•
Slide in range with oven and range cover	•	•	•	•
Portable, outside gas RVQ® grill with carrying case	•	•	•	•
Powered attic fan	•	•	•	•
Customer Value Package	•	•	•	•

Customer Value Package

2-cu.ft. 3-way gas/electric refrigerator (110V/12V/LP)	•	•	•	•
7 AM/FM/CD stereo	•	•	•	•
Battery gauge	•	•	•	•
1 Bunk storage shelf	•	•	•	•
Bunk-end fan lights (2)	•	•	•	•
Polished aluminum wheels	•	•	•	•
Prep for solar power	•	•	•	•
8 Self-storing awning made by Jayco®	•	•	•	•
Water purification system	•	•	•	•



2006 Jay Series

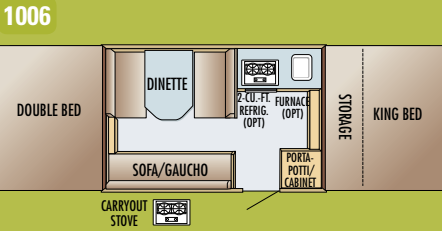
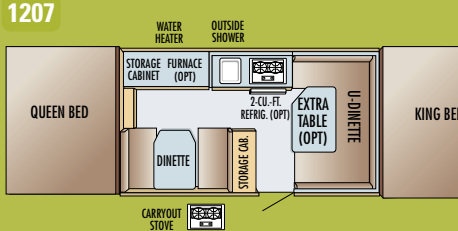
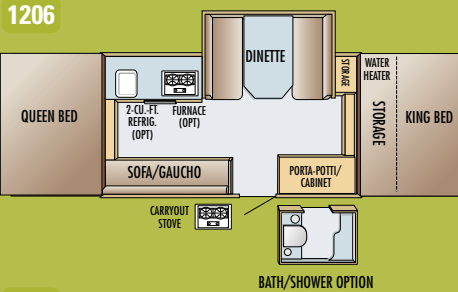
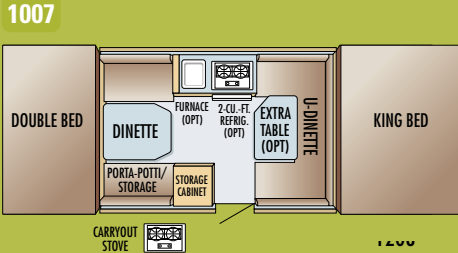
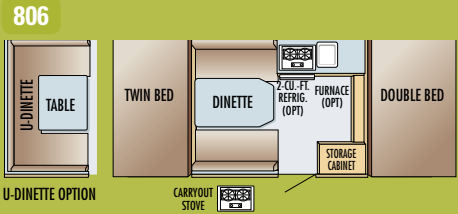

2006 Baja

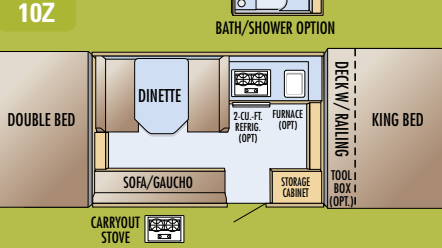
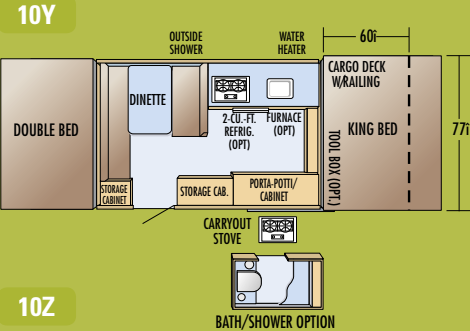

2006 Select

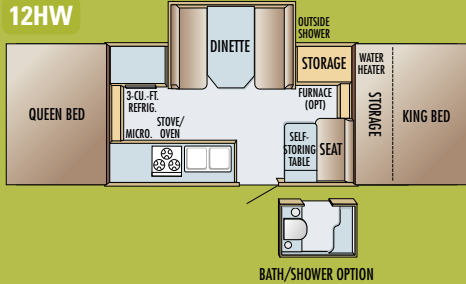

2006 Camouflage

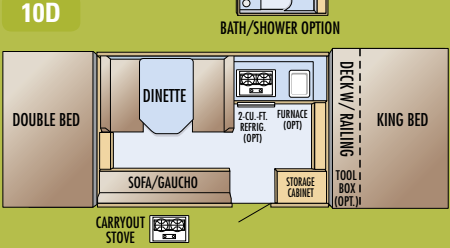
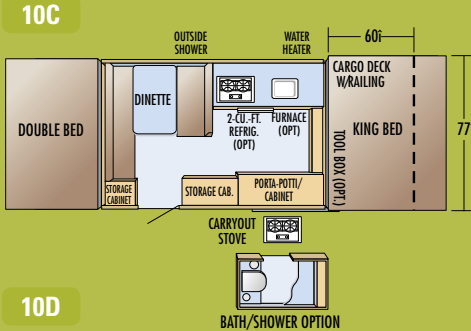

LIVEABLE CAMPING TRAILERS



JAY SERIES | SELECT | BAJA 2006 Camping Trailers

2006 Specifications & Measurements

JAY SERIES	Travel Length	Campsite Length	Approx. Travel Height	Unloaded Vehicle Weight (lbs.)	Approx. Hitch Weight (lbs.)	Gross Vehicle Weight Rating (lbs.)	Cargo Carrying Capacity (lbs.)	Fresh Water Capacity (gal.) <small>Includes Water Heater</small>	Sleeping Capacity
806	11' 10"	16' 3"	53"	1370	180	2000	630	17	4-6
1006	16' 9"	20' 4"	56"	1890	200	2950	1060	23	5-7
1007	14' 2"	20' 4"	54"	1635	165	2300	665	23	4-6
1206	18' 8"	22' 10"	56"	2400	305	3450	1050	23	5-7
1207	16' 2"	23' 4"	56"	1870	185	2950	1080	23	5-7
SELECT									
12HW	18' 9"	22' 10"	63"	2670	450	3750	1080	23	4-6
BAJA									
10Y	19' 6"	20' 10"	66"	2270	210	4000	1730	23	4-6
10Z	16' 7"	20' 10"	66"	2005	225	3000	995	17	5-7
CAMOUFLAGE									
10C	19' 6"	20' 10"	66"	2200	230	4000	1800	23	4-6
10D	16' 7"	20' 10"	66"	2005	225	3000	995	17	5-7

It is important for your safety and enjoyment that your tow vehicle be adequately sized and equipped to tow and handle the GVWR of the RV you select. Review weights and rating of your tow vehicle and consult a competent advisor for questions or advice. Whether you are new to RVing or a veteran, get a feel for the performance of your tow vehicle and the RV together before heading out on the roadways. When you tow an RV, you must drive differently than you do when driving a single vehicle. Practice hooking up, driving, backing up, and braking in a safe environment or seek out professional instruction. Jayco affixes a weight label to each RV which lists weight information for that vehicle. See specification chart above. This chart is for guidance only, specifications may vary.

Unloaded Vehicle Weight (UWV): Sometimes referred to as "Dry Weight," UWV means the typical weight of this trailer as built at the factory. The UWV, as used in product literature and other promotional materials, does not include cargo, fresh water, LP gas, options, or dealer-installed accessories.

Gross Vehicle Weight Rating (GVWR): GVWR means the maximum permissible weight of the trailer, including the UWV plus passengers, personal items, all cargo, fluids, options, and dealer-installed accessories. The GVWR is equal to or greater than the sum of the UWV and the CCC.

Cargo Carrying Capacity (CCC): CCC means the maximum weight of all passengers, personal items, food, fresh water, LP gas, tools, other cargo, and dealer-installed accessories that can be carried by the trailer. CCC is equal to or less than GVWR minus UWV. The addition of options will decrease the CCC.

Hitch Weight (HW): The hitch weight, as used in product literature and other promotional materials, does not include cargo, fresh water, propane gas, options or dealer-installed accessories. The addition of these types of items will either add to or subtract from the stated hitch weight.

Your Jayco Dealer

See above dealer for further information and prices.

Please Note: All information in this brochure is the latest available at the time of publication approval. Jayco reserves the right to make changes and to discontinue models without notice or obligation. Photos in this brochure may show optional equipment. RVs built for sale in Canada may differ to conform to Canadian codes.

©2006 Jayco, Inc. 06-FDCT-PL 0705-100K Printed in U.S.A.

RVQ is a registered trademark of Vitco, Inc. TorFlex is a registered trademark of the Dexter Axle Company. E-Z Lube is a registered trademark of the Dexter Axle Company. Carefree is a registered trademark of Carefree of Colorado. Onan is a registered trademark of Cummins Engine Corporation. Strukturwood is a registered trademark of Weyerhaeuser Corporation.

As a Jayco owner, you can be part of the Jayco Jafari International Travel Club. Ask your dealer about the Jafari "flight" in your area, write Jayco, or visit our website.



We Back What We Build.

The Jayco Co-Pilot Warranty is a manufacturer's limited warranty. It doesn't come from your dealer and it's not an extended warranty! It comes from the people who build Jayco recreation vehicles to the people who buy them. Each Jayco is warranted to the original purchaser for twenty-four (24) months or twenty-four thousand (24,000) miles (mileage limitation applies to motorized products only), whichever occurs first, from the original date of purchase against defects in materials and workmanship. In addition, our limited warranty may be transferred one time within the warranty period. Go ahead and compare the Jayco warranty with other manufacturers' warranties. You'll find it's the best in the business!

For a copy of the limited warranty with full terms and conditions, ask your local Jayco dealer or visit our web site at www.jayco.com.



Lifetime Coverage.

Jayco offers to the original purchaser additional industry-leading lifetime parts and labor coverage on our lifter system, roof, floor, and frame. We also offer five-year (5) coverage on our tent with parts, labor, and freight covered the first two years; parts, factory labor, and return freight during years three, four, and five.



AMERICA'S MOST LIVEABLE RVs.