

2010 Recon ZX Toy Haulers by Jayco®

# Take It All.

With room for all your toys, the Recon ZX really lets you take it all.





# 2010 Recon ZX™



Optional dual electric queen beds in the cargo area are easy to lower and raise.

The 2,000 lb. capacity garage features a 96" ramp door opening.

Recon's full kitchen allows you to cook a hot breakfast before you head out and a hearty dinner when you get home.

## Have It All.

No other toy hauler gives you the same combination of garage space, rugged construction, high-end interiors and convenient amenities. With room for up to four ATV's, an extra-wide ramp and 2,500 pound tie-downs, the Recon can handle all your toys. And with multiple slideouts, loft beds and up to two queen beds in the garage, there's plenty of room for friends to come along as well.

### FLOORPLANS

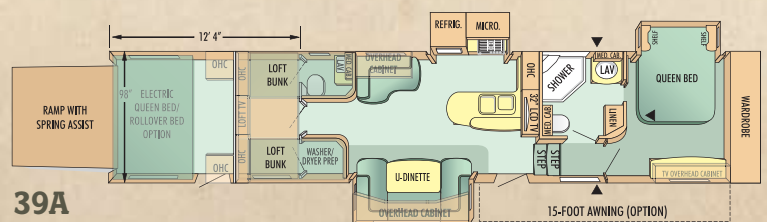
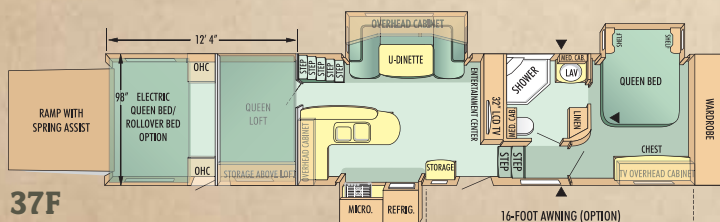



# Designed to Hold Its Own.

## Lightweight and Durable

Our Tuffshell® sidewall construction features a lightweight welded aluminum frame, efficient bead foam insulation **1** and luan board **2** that is vacuum-bonded for superior strength and weight reduction.

## A Firm Foundation

The R-24 floor construction combines 2" x 3" aluminum floor joists **3**, fiberglass insulation, reflective foil **4** and 5/8" tongue-and-groove plywood **5** to create a firm foundation.

## Convenience and Comfort

Design features like lockable storage compartments **6**, tinted safety glass windows **7**, central air conditioning **8**, a Carefree® electric patio awning **9** and high rise retractable entrance steps **10** make life comfortable and convenient.



## Keeping Cargo Safe

The garage floor and ramp door feature an anti-slip, non-skid floor **11** and ramp door with spring-hinge assist system **12**. With a 2,500 pound capacity, the wide ramp makes it easy to load and unload large toys. Ten flush-floor mounted D-rings anchored to the frame hold 2,500 pounds each, ensuring toys will remain safely in place.

## Impressive Sound Capabilities

Nothing gets you more inspired to ride than listening to music on Recon's Sony® 12V AM/FM/CD/DVD stereo with iPod® adapter/charger and four Sony® speakers. Recon ZX's versatile sound system allows for a premium sound experience wherever you want—indoor or outdoor. If you're the type who likes to take it up a notch, add the optional Sony® subwoofer and amplifier.

## Protection From the Elements

Our seamless one-piece rubber roof **13** covers a 5" thick vacuum-bonded laminated R-25 roof **14** and ceiling paneling **15** and offers superior protection from rain, heat and noise.

## INTERIOR COLOR OPTIONS

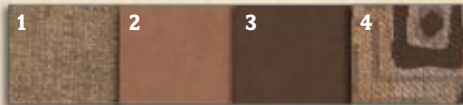

DUNES

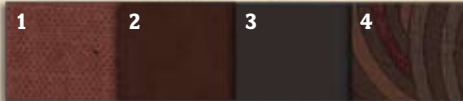

FLAME

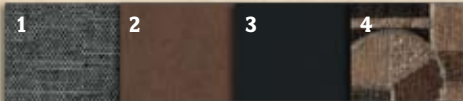

JAVA

**1.** Drapery **2.** Bedspread **3.** Upholstery **4.** Main

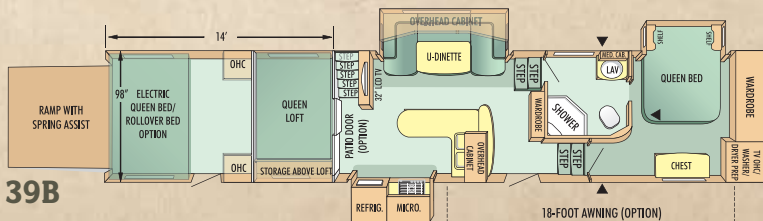

39B

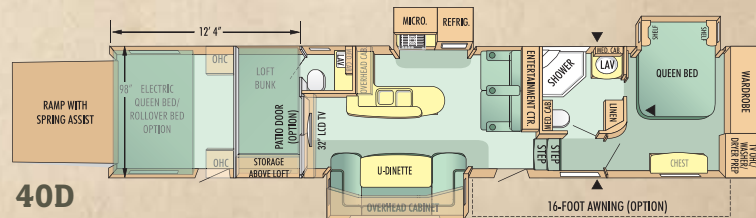

40D

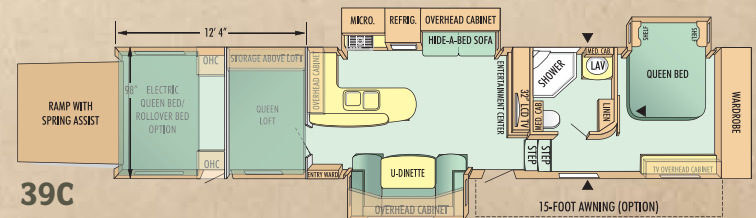

39C



## STANDARDS AND OPTIONS

### STANDARD BATHROOM EQUIPMENT

Large sink in bathroom
Medicine cabinet with mirror
Switches for all lights
Theford Porcelain toilet with foot flush
Toilet paper holder
Towel holder

### STANDARD BEDROOM EQUIPMENT

Below countertop waste basket location
Carpeting with padding
Quilted fitted bedspread
Shoe shelf in closet
TV Prep
Under bed storage, bed lifts on gas struts

### STANDARD CONSTRUCTION FEATURES

10½" solid steel outriggers
102" wide body
12" I-Class cambered structural steel I-Beam frame
¾" Tongue and Groove plywood main floor decking
Bead foam insulation in sidewalls and roof
Cabinetry crafted with screwed stile construction
Electric-powered slideout (select models)
High-Gloss Lamilux 4000 fiberglass sidewalls
One piece, seamless, rubber roof
Polar Barrier™ insulation package
PolyFlex™ one-piece underbelly cover
R-25 insulation in roof, R-9 in sidewalls, R-24 in floor and underbelly, R-15 in slide-out floors
Reflective foil insulation in main and bedroom floor and all slideout floors
Steel backers welded onto frame to mount D-rings
TuffShell™ vacuum-bonded laminated sidewalls
Vacuum-bonded 5" crowned laminated roof
Vacuum-bonded laminated 2" garage floor
Welded tubular-aluminum sidewall and floor framework
Wired and framed for second A/C

### STANDARD EXTERIOR EQUIPMENT

12V light for hitch
16" radial tires
ABS fender skirts
Back up mirror, mounted on front cap
Battery box for two batteries
Big Easy™ triple retractable main entrance step (2)
Cable and satellite TV prepped

Electric brakes
Electric-powered front jacks
Entrance doors are fiberglass and radius cornered with screen door
Entrance step light, main door
E-Z Lube® axles
Heated and Enclosed Underbelly
High-intensity rear ramp lights (2)
L.E.D tail lights
Large Entry Assist Grab Handle
Leaf spring axles
Lockable, radius-cornered baggage doors with heavy-duty grab handle
MOR/ryde® CRE/3000 Suspension
Patio light with inside switch
Rain gutturing, molded with drip spouts
Sony® marine grade exterior speakers
Stor-Galore™ basement storage
Street-side utility light
Triple axles with Nev-R-Adjust™ brakes
Under Frame pull-out storage drawer

### STANDARD INTERIOR EQUIPMENT

32" LCD HDTV
Ball-bearing drawer guides throughout
Brushed nickel hardware
Brushed nickel lighting package
Ceiling Fan
Crank-up digital TV antenna with signal booster
Deep-lipped overhead cabinetry
Drawer storage below dinette seats (Select Models)
Driveable wheel wells
Fabric-covered box valances with lambrequin legs
Hardwood Grab Handle at entrance door
Hide-a-bed sofa with air mattress (Select Models)
High-intensity 12V lighting package
Jayco ZX furniture
Multi-directional louvered central A/C vents
Pleated night shades throughout
Raised panel cabinet doors throughout
Six panel passage doors throughout
Storage drawers built into steps (Select Models)
Transom Window above Main Slideout
Wall-mounted ladder (Select Models)

### STANDARD KITCHEN EQUIPMENT

3-burner range with 9000 BTU Super Burner™ and piezo igniter
--

Below countertop waste basket location
Brushed nickel mixing faucet with Pull Out Sprayer
Cover for sink/cutting board (2)
Deep recessed residential-style sink
Drawer for silverware, divided for utensils
Granite-look countertops
Overhead range hood with light and exhaust fan
Oversized Kitchen Window, (select models)
Oversized oven

### STANDARD POWER, WATER AND HEAT

110V G.F.C.I. protected exterior receptacles
12V demand water pump
12V electrical system with deluxe 110V 75-amp power converter
135 gallon fresh water capacity
1800 watt Xantrex inverter
50-amp electric service
50-amp quick-connect power cord and storage bracket
A/C chill grill
Automatic transfer switch with generator or generator prep
Battery disconnect switch
Black holding tank sprayer
Concealed black and gray tank valves
Double 30-lb. propane gas bottles, with regulator
Fuel station with 27 gallon fuel tank
Furnace with wall thermostat, auto-ignition
Generator prep, includes wiring and location
Hook-up for city water
Monitor panel for all systems
Outside shower
Recessed command center with sliding glass door
Sewer hose storage compartment
Uni-Dock™ utility center, heated and enclosed
Washer and Dyer Prep
Water heater bypass system
Water system winterization kit

### STANDARD RAMP AND CARGO EQUIPMENT

7' 10" door/ramp, 2500 lbs. capacity
96" wide ramp door opening
Anti-slip, non-skid flooring on ramp door
Automotive-style locks for ramp door
Beaver tail transition ramp
Flush floor-mounted tie-down rings anchored to frame, 2,500 lb. capacity each
Garage vent ports
Hinge spring assist ramp door
Overhead storage cabinets
Tow-Rax™ work station
Tuff-ply™, rubberized floor liner on garage floor
Welded steel storage compartment in garage floor

### STANDARD SAFETY EQUIPMENT

Break-away switch
Carbon monoxide alarm
Fire extinguisher
Lock and dead bolt on entrance doors
Multiple egress windows
Propane alarm
Smoke alarm
Static Line with Fuel Station
Tinted safety glass windows

### OPTIONS

2nd A/C in Bedroom
5500-Watt Generator
Beverage Cooler
Cargo Area Powered Roof Vent
Carpet, Cargo Area
Customer Value Package
Electric Queen Bunk Bed w/Rollover Sofa
Electric Stabilizer Jacks (Rear)
Foldaway Sink in Garage
High-Gloss Gelcoat Sidewalls
MOR/ryde® Pin Box
Patio Door
Power Package: Power Jump Pack, Power Pressure Washer and Air Compressor
Retractable Screen Wall
Satellite Kit
Slideout Awnings (3)
Sony® Xplod® Subwoofer and Amplifier w/Remote

### CUSTOMER VALUE PACKAGE

12 gal. gas/electric DSI auto-ignition water heater
12V AM/FM/CD/DVD Sony® stereo, iPod adapter/charger and 4 Sony® speakers
16" spare tire w/carrier mounted under cargo area
8 cu. ft. flush-mount double door refrigerator
Aluminum Rims with Torq-N-Go™ two piece wheel nuts
Bathroom power vent
Bi-fold cover for range
Carefree® Travl'r 12 volt electric patio awning
Central A/C 15,000 BTU
Deluxe mattress 60x80
Detachable Ladder
Insulated and Heated holding tanks
Microwave oven with carousel
Neo-angle shower with ABS surround
Provincial Glazed Maple raised-paneled doors and drawers throughout
Rear stabilizer jacks (2)
Security lights (2)
Skylight in tub/shower
Water purification system

## SPECIFICATIONS AND MEASUREMENTS

FLOORPLANS	37F	39A	39B	39C	40D
EXTERIOR LENGTH	40'	40' 5"	TBD	TBD	TBD
EXTERIOR HEIGHT (WITH A/C)	159"	159"	TBD	TBD	TBD
INTERIOR HEIGHT	101"	101"	TBD	TBD	TBD
UNLOADED VEHICLE WEIGHT (LBS.)	12,860	13,375	TBD	TBD	TBD
DRY HITCH WEIGHT (LBS.)	3,300	3,325	TBD	TBD	TBD
GROSS VEHICLE WEIGHT RATING (LBS.)	18,000	18,000	TBD	TBD	TBD
CARGO CARRYING CAPACITY	5,140	4,625	TBD	TBD	TBD
FRESH WATER (GAL.) INCLUDES WATER HEATER	148	148	TBD	TBD	TBD
GRAY WASTEWATER (GAL.)	64	60	TBD	TBD	TBD
TOILET/BLACK WASTEWATER (GAL.)	28	60	TBD	TBD	TBD

It is important for your safety and enjoyment that your tow vehicle be adequately sized and equipped to tow and handle the GVWR of the RV you select. Review weights and rating of your tow vehicle and consult a competent advisor for questions or advice. Whether you are new to RVing or a veteran, get a feel for the performance of your tow vehicle and the RV together before heading out on the roadways. When you tow an RV, you must drive differently than you do when driving a single vehicle. Practice hooking up, driving, backing up and braking in a safe environment or seek out professional instruction. Jayco affixes a weight label to each RV which lists weight information for that vehicle. See specification chart above.

**Unloaded Vehicle Weight (UVW):** Sometimes referred to as "Dry Weight," UVW means the typical weight of this trailer as built at the factory. The UVW, as used in product literature and other promotional materials, does not include cargo, fresh water, propane, options or dealer-installed accessories.

**Gross Vehicle Weight Rating (GVWR):** GVWR means the maximum permissible weight of the trailer, including the UVW plus passengers, personal items, all cargo, fluids, options, and dealer-installed accessories. The GVWR is equal to or greater than the sum of the UVW and the CCC.

**Cargo Carrying Capacity (CCC):** CCC means the maximum weight of all passengers, personal items, food, fresh water, propane, tools, other cargo and dealer-installed accessories that can be carried by the trailer. CCC is equal to or less than GVWR minus UVW. The addition of options will decrease the CCC.

**Hitch Weight (HW):** The hitch weight, as used in product literature and other promotional materials, does not include cargo, fresh water, propane gas, options or dealer-installed accessories. The addition of these types of items will either add to or subtract from the stated hitch weight.



AMERICA'S MOST LIVEABLE RVs.

Jayco, Inc., P.O. Box 460, Middlebury, IN 46540, [www.jayco.com](http://www.jayco.com)

See dealer for further information and prices. All information in this brochure is the latest available at the time of publication approval. Jayco reserves the right to make changes and to discontinue models without notice or obligation. Photos in this brochure may show optional equipment and props for photography purposes. RVs built for sale in Canada may differ to conform to Canadian codes. E-Z Lube is a registered trademark of the Dexter Axle Company. Carefree is a registered trademark of Carefree of Colorado. Dolby and the double-D symbol are registered trademarks of Dolby Laboratories. ©2009 Jayco, Inc. 09-JFTR-PL 0708-100K Printed in U.S.A.