

Fifth Wheels by Jayco



Jayco

AMERICA'S MOST **LIVEABLE** RVs.

2010 DESIGNER

Traveling Companion



Common



LUXURIOUS

An oversized sofa, Cloud Ten™ pillowtop mattress, optional Optima leather matching recliners and Provincial Glazed Maple hardwood cabinetry combine to put Designer in a class by itself.

DESIGNER®
Fifth Wheels by Jayco®

LIVEABILITY MEETS SENSIBILITY

sense luxury.

Just because you can afford to spend more on a luxury fifth wheel doesn't mean you should. The 2010 Jayco Designer offers everything you'd expect to find in a high-end fifth wheel, but for less than you'd expect to spend. Created as a luxury suite on wheels, the Designer is ideal for extended stays, long trips or winters in sunnier climates. Because at Jayco, we believe the best things in life shouldn't cost the most.



EFFICIENT

Extend the camping season with our Polar Barrier™ thermal insulation package. Designed for efficient heating and cooling, Polar Barrier™ protects against freezing, even when temperatures drop as low as 0°F (-17°C).

DURABLE

With its TuffShell™ vacuum-bonded laminated sidewalls, one-piece seamless rubber roof and I-Class™ cambered structural steel I-Beam frames, your Designer is built to tackle the elements in style.

A TRADITION OF LIVEABILITY

Starting with our first lifter system in 1968, which made for an easier, more enjoyable camping experience, Jayco has always been about liveability. Today, we're the world's largest family-owned RV manufacturer, yet our priorities remain the same: making RVs more liveable and family time more memorable.



DESIGNER 37RLQS | MOCHA



DESIGNER 35RLTS | ASPEN



DESIGNER 37RLQS | MOCHA



DESIGNER 35RLTS | ASPEN



LIVEABLE AND LOVEABLE

For 2010, we took everything you love about the Designer and made it even better. The new Designer features spacious slideouts, well-designed living spaces, a high-end kitchen with DuPont® Corian® countertops and sleeping for up to six adults, making it the first fifth wheel designed to satisfy all your senses.

COZY

At the end of a long day, retire to your private retreat, complete with a Cloud Ten™ pillowtop mattress and a 22" LCD HDTV television in the bedroom.

ELEGANT

A roomy radius shower, an adjustable shower head, glass shower door and skylight are just a few of the bathroom highlights.

Jayco construction

At Jayco, we've built a reputation for superior construction and craftsmanship. We always use top-quality materials and production techniques, giving our products **reliable resale value** and our owners peace of mind.

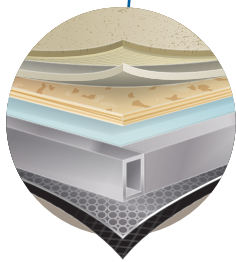

FLOOR

A 5/8" tongue-and-groove plywood deck on a welded aluminum frame, together with fiberglass and foil insulation (R-22) and a Poly-Flex™ covering, create one of the strongest foundations in the industry.

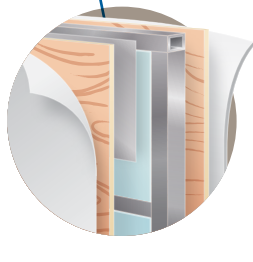

WALLS

TuffShell™ vacuum-bonded lamination combined with welded aluminum frames and metal backers create a durable structure designed to withstand use and travel.

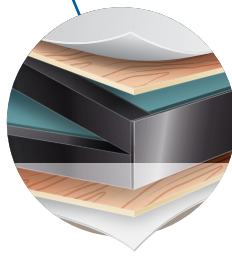

ROOF

The laminated, vacuum-bonded roof is comprised of 1/4" plywood decking on 5" arched aluminum trusses with bead-foam insulation (R-21) and a seamless rubber shield that protects against moisture and resists aging.

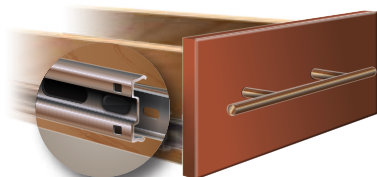

BALL BEARING DRAWER GUIDES

Our new residential-style ball bearing drawer guides provide smooth operation and full drawer extension for a stronger, more substantial drawer and a true home-like feel.



POLAR BARRIER

Our exclusive Polar Barrier™ thermal insulation package lets you extend the camping season by providing protection against freezing (temperatures as low as 0°F or -17°C), greatly increasing your options for winter travel destinations.

Jayco craftsmanship

Jayco's dedicated production team includes Amish craftsmen who build with well-honed woodworking techniques passed down for generations and skilled seamstresses who produce our upholstery, bedding and draperies with great attention to detail.



Jayco liveability

At Jayco, it's always been about liveability.

STOR-GALORE™ BASEMENT STORAGE

Keep your gear safe, dry and out of the way in our exclusive, easy-access storage area with four tie-down rings.

HEATED, ENCLOSED UNDERBELLY

The weather outside may be frightful, but inside it's always warm and comfy.

FIREPLACE

An optional 5,100-BTU electric fireplace gives your living room a cozy ambiance.

HDTVs

The living area boasts an impressive 32" LCD HDTV, while the bedroom features a 22" LCD HDTV.

PATIO AWNING

Extend your living space even farther with the optional Carefree® Travel'r™ 12-volt electric patio awning.

COUNTERTOPS

DuPont® Corian® countertops with a high-gloss finish and bullnose edging add elegance and durability.

Standards and options

STANDARD BATHROOM EQUIPMENT

Accordion door or passage door to bedroom
Adjustable shower head
Ducted heating
Fiberglass radius shower
Oil-rubbed bronze fixtures
Radius glass shower door
Residential medicine cabinet with mirror
Skylight in tub/shower
Switches for all lights
Theford® porcelain stool with foot pedal
Toilet paper holder
Towel ring
Vanity light fixture
Vinyl flooring
Window in commode area (select models)

STANDARD BEDROOM EQUIPMENT

Accordion-style bedroom door (select models)
Bed lifts up easily on struts, 2 ABS storage bins below
Decorative headboard
Decorative pillows for bed
Deluxe Cloud Ten™ pillowtop mattress (60" x 80")
Dresser drawers, residential-style
Dresser lamp
Laundry hamper
Nightstands next to bed
Quilted bedspread with 2 pillow shams
Reading lights over bed
TV cabinet with satellite and cable jacks

STANDARD KITCHEN EQUIPMENT

3-burner range with 9,000-BTU SuperBurner™ and piezo igniter
8 cu. ft. flush-mount refrigerator with double door
Bi-fold, recessed cover for stove
DuPont® Corian® cover for sink/cutting board (2)
DuPont® Corian® kitchen countertops
Extendable free-standing table with 4 chairs
Fluorescent lighting under cabinet
Hardwood spindle corner accents on kitchen bases
High-rise single-lever faucet with pull-out sprayer
Microwave oven with carousel
Oversized 21" oven
Paper towel holder
Provincial Glazed Maple raised hardwood refrigerator fronts
Sponge holder under sink
Stainless steel sink
Wallpaper border

STANDARD CONSTRUCTION FEATURES

5/8" tongue and groove plywood main floor decking
Bead-foam insulation (R-9 in sidewalls, R-21 in roof)
Electric-powered slideout
Enclosed, insulated and heated underbelly
FRP smooth fiberglass sidewall exteriors
Hardwood cabinetry crafted with screwed-stile construction
I-Class® cambered structural steel I-Beam frames
Pin box, long
Polar Barrier™ insulation package
Reflective foil insulation in main and bedroom floor and all slideout floors
Seamless one-piece rubber roof
Seamless one-piece underbelly covering
TuffShell™ vacuum-bonded 5" crowned laminated roof
TuffShell™ vacuum-bonded laminated sidewalls
Welded aluminum floor studs on 16" centers
Welded tubular-aluminum sidewall framework

STANDARD EXTERIOR EQUIPMENT

12V hitch light
16" radial tires

ABS fender skirts
Aerodynamic caps on front and rear made of fiberglass with radius corners
Amber patio light with inside switch
Baggage doors — lockable, insulated and radius-cornered with heavy-duty grab handles
Big Easy™ entrance step with 10" deep treads
Bracketry for 50-amp power cord in front basement
Electric-powered front jacks
Entrance door — fiberglass and radius-cornered with screen door
Galvanized steel wheel wells
L.E.D. taillights
Nev-R-Adjust™ Dexter® brakes
Nev-R-Lube® axles
Outdoor media center
Painted bottom radius skirting
Prep for outside grill
Rain guttering, molded with drip spouts
Rear electric stabilizer jacks (2)
Roof ladder
Sidewall corners radiused at top and bottom
Stor-Galore™ basement storage
Street-side utility light
Torg-n-Go™ Wheel nuts
White-framed radius-cornered fiberglass main entry door with screen and storm door
Wide-stance front jacks with quick-release pins

STANDARD INTERIOR EQUIPMENT

32" LCD HDTV in living area
Ball bearing drawer guides throughout
Ball bearing drawer guides, 75-lb. capacity with full drawer extension
Cabinet door hinges, hidden throughout
Cable and satellite TV prepped
Ceiling fan with light
Crank-up digital TV antenna with signal booster
Decorative oil-rubbed bronze lighting throughout
Decorative throw pillows for hide-a-bed
End table with built-in magazine rack
Hardwood cabinet stiles
Hardwood message center (select models)
Hide-a-bed sofa (air mattress)
High-intensity halogen recessed 12V lighting package with dimmers
Linoleum floor in entryway
Overhead cabinetry in slideout room with raised panel doors
Pleated day/night shades
Prep for satellite dish for roof and sidewall
Provincial Glazed Maple raised-paneled doors and drawers throughout
Residential trim package throughout
Rocker recliner(s)
Solid hardwood interior grab handle for main entrance door
Trackless carpeting with pad
Transom window with wood trim above main slideout room
Ventilating windows on slideout end walls

STANDARD HEAT, POWER & WATER EQUIPMENT

120V G.F.C.I. protected exterior receptacle
12-gal. gas/electric DSI auto-ignition water heater
12V demand water pump
12V electrical system with 120V, 80-amp power converter
50-amp electric service
50-amp quick-connect power cord
A/C Chillgrille™
Arched step treads into bathroom
Auto-ignition furnace with wall thermostat
Battery disconnect switch
Double 30-lb. propane gas bottles, with regulator (in side compartment on sliding tray)
Holding and fresh water tanks made with rotocast design
Hook-up for city water

In-floor ducted heat
Interior Command Center®
Prep for solar panel
Prep for washer/dryer
Systems monitor panel
Uni-Dock™ utility center, heated and enclosed
Vents pre-wired for attic fan in bedroom and living room
Water heater bypass system
Water system winterization kit

STANDARD SAFETY EQUIPMENT

Breakaway switch
Carbon monoxide alarm
Deadbolt lock on entrance door
Egress window
Fire extinguisher
Propane alarm
Smoke alarm
Tinted safety glass windows

OPTIONS

10 cu. ft. refrigerator
2 leather recliners in lieu of fabric recliners
2nd 13,500-BTU A/C in bedroom with wall thermostat
40" LCD HDTV in lieu of 32" (35RLTS, 37RLQS)
Bike rack
Booth dinette with 2 drawers (select models)
Canadian standards
Carefree® SideOut Cover II™ awnings for slideouts
Convection microwave
Customer Value Package
Deluxe entertainment center with 40" LCD HDTV (34RLQS, 35RLSA)
Fiberglass garden tub in lieu of fiberglass shower
Fireplace, 5,100-BTU
Front and rear powered roof vents
Front powered roof vents
Generator prep
High-gloss, gel-coat fiberglass sidewall exteriors
Key fob remote control for patio awning, light, slideouts and front jacks
King bed
Ledgestone fireplace (select models)
NOR/ryde® pin box
Onan® 5,500-watt MicroLite™ generator with auto changeover (generator prep included)
Portable outside gas grill
Rear powered roof vent
Satellite kit
Thermal pane tinted safety glass windows
Washer/dryer combination

CUSTOMER VALUE PACKAGE

15,000-BTU central A/C with quick cool feature, louvered directional ceiling vents
22" LCD HDTV in bedroom
8-lug polished aluminum wheels
Bathroom power vent
Black holding tank sprayer
Carefree® Travel™ 12V patio awning
Central vacuum system
Decorative fascia board
Floor-mounted safe
Foldable, exterior grab handle
NOR/ryde® rubber equalizer suspension
Multi-Media Premium Sound System™ AM/FM/CD/DVD stereo with MP3 input jack
Outside shower
Security lights (2)
Undermount spare tire with carrier
Water purification system

Specifications

DESIGNER	FLOORPLAN	EXTERIOR LENGTH	EXTERIOR HEIGHT (WITH A/C)	INTERIOR HEIGHT	UNLOADED VEHICLE WEIGHT (LBS.)	DRY HITCH WEIGHT (LBS.)	GROSS VEHICLE WEIGHT RATING (LBS.)	CARGO CARRYING CAPACITY (LBS.)	FRESH WATER CAPACITY (GAL.) (WITH WATER HEATER)	GRAY WASTEWATER CAPACITY (GAL.)	TOILET/BLACK WASTEWATER CAPACITY (GAL.)
	34RLQS	37' 5"	158"	77"	11,235	2,325	15,800	4,565	87	87	52
	35RLTS	38' 5"	157"	77"	11,615	2,630	15,800	4,185	87	87	52
	35RLSA	38' 11"	159"	77"	11,045	2,290	15,800	4,755	87	87	52
	37RLQS	39' 3"	160"	77"	11,835	2,165	15,800	3,965	87	87	52

It is important for your safety and enjoyment that your tow vehicle be adequately sized and equipped to tow and handle the GVWR of the RV you select. Review weights and rating of your tow vehicle and consult a competent advisor for questions or advice. Whether you are new to RVing or a veteran, get a feel for the performance of your tow vehicle and the RV together before heading out on the roadways. When you tow an RV, you must drive differently than you do when driving a single vehicle. Practice hooking up, driving, backing up and braking in a safe environment or seek out professional instruction. Jayco affixes a weight label to each RV which lists weight information for that vehicle. See specification chart above.

Unloaded Vehicle Weight (UVW): Sometimes referred to as "Dry Weight," UVW means the typical weight of this trailer as built at the factory. The UVW, as used in product literature and other promotional materials, does not include cargo, fresh water, propane, options or dealer-installed accessories.

Gross Vehicle Weight Rating (GVWR): GVWR means the maximum permissible weight of the trailer, including the UVW plus passengers, personal items, all cargo, fluids, options, and dealer-installed accessories. The GVWR is equal to or greater than the sum of the UVW and the CCC.

Cargo Carrying Capacity (CCC): CCC means the maximum weight of all passengers, personal items, food, fresh water, propane, tools, other cargo and dealer-installed accessories that can be carried by the trailer. CCC is equal to or less than GVWR minus UVW. The addition of options will decrease the CCC.

Hitch Weight (HW): The hitch weight, as used in product literature and other promotional materials, does not include cargo, fresh water, propane gas, options or dealer-installed accessories. The addition of these types of items will either add to or subtract from the stated hitch weight.

Floorplans

◀ = outside storage MICRO. = microwave REFRIG. = refrigerator
 LAV. = bathroom sink OHC. = overhead cabinets WARD. = wardrobe

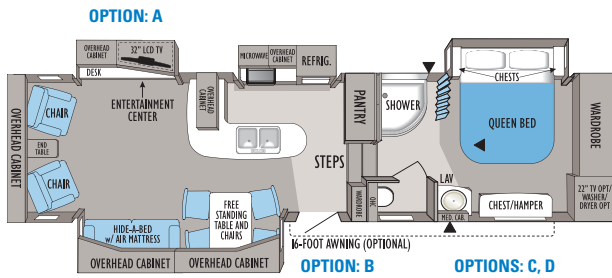

DESIGNER | 34RLQS

Ext. Length: 37' 5" Ext. Height: 158" Unloaded Weight (lbs.): 11,235

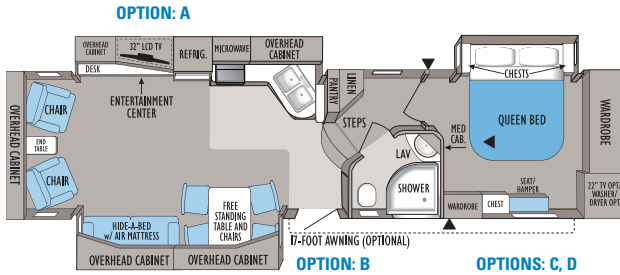

DESIGNER | 35RLSA

Ext. Length: 38' 11" Ext. Height: 159" Unloaded Weight (lbs.): 11,045

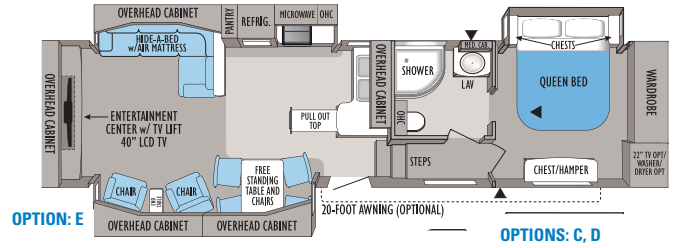

DESIGNER | 35RLTS

Ext. Length: 38' 5" Ext. Height: 157" Unloaded Weight (lbs.): 11,615

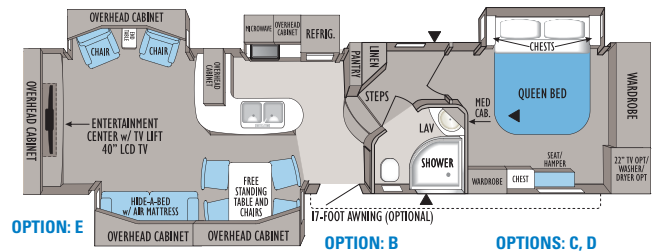

DESIGNER | 37RLQS

Ext. Length: 39' 3" Ext. Height: 160" Unloaded Weight (lbs.): 11,835

Floorplan options (available on select models only)

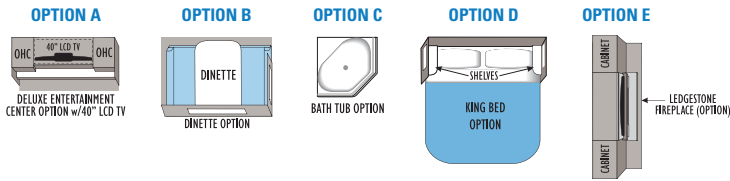

Interior color options

- 1 Sofa (two-tone)
- 2 Bedspread
- 3 Kitchen chair
- 4 Accent fabric
- 5 Drapery
- 6 Wall panel
- 7 Countertop
- 8 Flooring
- 9 Wood
- 10 Carpet

ASPEN



BRICK



MOCHA



CORDOVAN





AMERICA'S MOST **LIVEABLE** RVs.

2 YEAR WARRANTY

The Jayco Co-Pilot Warranty is a manufacturer's limited warranty. It comes from the people who build Jayco recreation vehicles to the people who buy them. Each Jayco is warranted to the original purchaser for twenty-four (24) months or twenty-four thousand (24,000) miles (mileage limitation applies to motorized products only), whichever occurs first, from the original date of purchase against defects in materials and workmanship. Jayco's limited warranty is not transferable. **Go ahead and compare the Jayco warranty with other manufacturers' warranties. You'll find it's the best in the business!**

For a copy of the limited warranty with full terms and conditions, ask your local Jayco dealer.

300 JAYCO DEALERS

Establishing a solid relationship with your local Jayco dealer is a key component in the enjoyment of your new Jayco. By purchasing from a local dealer, you will have a convenient location for sales, parts and service support.

Jayco dealers are required to deliver all products at the site of the sale to ensure a full product orientation and walkthrough at the time of delivery. It's a good way to become familiar with your Jayco and to meet the service, parts and warranty staff members who will be assisting you. If you live in Canada, there are regulations that must be met when buying a Jayco RV. Your local Canadian dealer is a professional at meeting these requirements and regulations. There simply is no substitute for a good relationship with your local Jayco dealer.

1 YEAR ROADSIDE ASSISTANCE

Travel worry-free with Jayco's Customer First Roadside Assistance program, yours at no cost during your first year of ownership. This program is offered through Coach-Net®, the largest RV emergency road service in the country, and gives you immediate access to dependable roadside assistance and support services with a simple phone call.

- Free jump starts
- Free tire changes
- Free fuel delivery
- Free lockout service
- Free travelers checks
- Toll-free nationwide service appointment assistance
- 24-hour toll-free emergency message service
- Free custom trip routing and full-color map service
- Free dispatch of on-site mechanical service
- \$2,000 trip-interruption reimbursement
- RV technical assistance hotline
- Free towing to nearest qualified service

Your Jayco Dealer



Jayco proudly sponsors Tread Lightly!®, a nonprofit organization whose mission is to empower generations to enjoy the outdoors responsibly through education and restoration.

JayPlus

From RV insurance to extended warranties, JayPlus has it covered. Ask your Jayco dealer about our exclusive JayPlus program today.



As a Jayco owner, you can be part of the Jayco Jafari International Travel Club. Ask your dealer about the Jafari "flight" in your area, write Jayco or visit our website.

Jayco, Inc., P.O. Box 460, Middlebury, IN 46540, www.jayco.com 

See dealer for further information and prices. All information in this brochure is the latest available at the time of publication approval. Jayco reserves the right to make changes and to discontinue models without notice or obligation. Photos in this brochure may show optional equipment and props for photography purposes. RVs built for sale in Canada may differ to conform to Canadian codes. ©2010 Jayco, Inc. 10-DSGN-PL 0709-50K Printed in U.S.A.