



AMERICA'S MOST **LIVEABLE** RVs.

2010 GREYHAWK

# Freedom Fighter



# Ready,



GREYHAWK®  
2010 Motorhomes by Jayco®

## POWERFUL

A Triton™ 6.8L EFI V-10 305 HP engine, five-speed automatic transmission, power anti-lock brakes and power steering means Greyhawk can handle mountain passes as easily as it does the straightaways.



LIVEABILITY MEETS OPPORTUNITY

# set, go.

Are you ready to answer the call of the open road? To see the sun rise on the east coast and set on the west? And to do it with all the comforts and conveniences of home? Then you're ready for the Jayco Greyhawk, a Class-C motorhome with more high-end features and amenities than anything else in its price range. While the decision to buy a motorhome is a big step, when you're ready, Greyhawk makes it an easy one.



## COMFORTABLE

Traveling's a breeze with standard features like a lockable exterior storage compartment, central air conditioning, tinted safety-glass windows and an electric Carefree® patio awning.

## DURABLE

TuffShell™ vacuum-bonded laminated sidewalls, a one-piece rubber roof with 12-year warranty, and bead-foam insulation guarantee Greyhawk can withstand the elements.

## AERODYNAMIC

With its redesigned roofline, the 2010 Greyhawk not only looks sleeker than ever, but it's also more aerodynamic, which improves gas mileage and saves money.

## A TRADITION OF LIVEABILITY

Starting with our first lifter system for fold-down campers in 1968, which made for an easier, more enjoyable camping experience, Jayco has always been about liveability. Today, we're the world's largest family-owned RV manufacturer, yet our priorities remain the same: making RVs more liveable and family time more memorable.





GREYHAWK 31FK | CHESTNUT



## LIVE IT UP.

Tastefully decorated with Northridge Maple cabinetry, oil-rubbed bronze hardware, halogen recessed ceiling lights, Jayco-designed furniture and a choice of three contemporary color schemes, the Greyhawk combines luxury, liveability and value into one beautiful package you'll want to open again and again.

## INTIMATE

You'll appreciate Greyhawk's cozy bedroom, with a Cloud Ten™ pillowtop queen mattress, quilted bedspread, large wardrobe and under-bed storage.

## EFFICIENT

With a three-burner range, molded double-bowl sink and plenty of cabinet space, Greyhawk's kitchen makes cooking fun and easy.

## HOME-LIKE

Greyhawk's bathroom features a comfortable shower, mirrored medicine cabinet, residential-style linoleum floor and a large skylight.





GREYHAWK 31FK | CHESTNUT



GREYHAWK 31FK | CHESTNUT



GREYHAWK 31FK | CHESTNUT

## Jayco construction

At Jayco, we've built a reputation for superior construction and craftsmanship. We always use top-quality materials and production techniques, giving our products **reliable resale value** and our owners peace of mind.

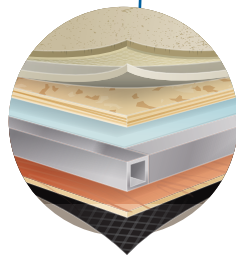

### FLOOR

Vacuum bonding joins our aluminum frame with a heavy-duty Structurwood® floorboard to create one of the strongest foundations in the industry.

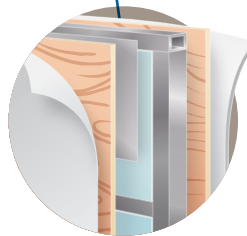

### WALLS

TuffShell™ vacuum bonding with welded aluminum frames and metal backers creates a durable structure designed to withstand use and travel.

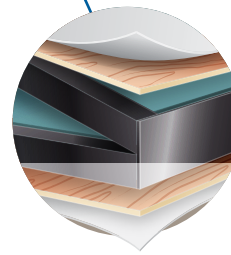

### ROOF

The laminated, vacuum-bonded roof is comprised of ¼" plywood decking on 4" arched aluminum trusses with bead-foam insulation (R-15) and a seamless rubber membrane that protects against moisture and resists aging.

## Jayco craftsmanship

Jayco's dedicated production team includes Amish craftsmen who build with well-honed woodworking techniques passed down for generations.



## Jayco liveability

### POWER TO SPARE

The Greyhawk features a powerful 4,000-watt Onan® generator with auto-changeover and an Energy™ command center.

### DREAM DINETTE

Easily raise and lower your dinette table for extra sleeping space whenever you need it.

### HIDDEN CABINET DOOR HINGES

Hidden cabinet door hinges are now standard for increased beauty throughout Greyhawk's interior.

### COMMAND CENTER

Control all your generator and slideout functions from one convenient interior location.

### DRAWER GUIDES

New ball bearing drawer guides provide smooth operation and full-drawer extension.

# Standards and options

## STANDARD BATHROOM EQUIPMENT

6-panel residential-style passage doors
ABS shower with one-piece surround
Decorative headboard
Halogen oil-rubbed bronze reading lights
Marine toilet with foot flush
Oil-rubbed bronze fixtures
Removable clothing rod in tub
Residential linoleum floor
Residential medicine cabinet with mirror
Skylight in shower with light (select models)
Toilet paper holder
Towel holder
Towel ring

## STANDARD BEDROOM EQUIPMENT

Large wardrobes
Queen bed with Cloud Ten™ pillowtop mattress
Quilted bedspread
Under-bed storage, bed lifts easily on gas struts (select models)

## STANDARD KITCHEN EQUIPMENT

3-burner range with 9,000-BTU SuperBurner™ and piezo igniter
8 cu.ft. flush-mount refrigerator with double door
Ball bearing drawer guides 100-lb. capacity with full-drawer extension
Bi-fold range cover
Cutting board cover for sink
Drawer for silverware, divided for utensils
Dream Dinette™ mechanism, raises and lowers dinette table top
High-rise single-lever faucet with pull-out sprayer
Microwave oven with carousel
Mini-blind
Oversized oven
Residential linoleum floor in kitchen
Splash guard, made of Plexiglas® (select models)
Water purification system
White, residential-style, double-bowl kitchen sink

## STANDARD CAB EQUIPMENT

3-point lap and shoulder safety belts (driver and passenger)
Auxiliary start switch
Headliner padded fabric
Non-power, Optima leather passenger-side seat

Power, Optima leather driver-side seat
Privacy curtains for cab area
Remote keyless entry
Upgraded seats with full front/back adjustment

## STANDARD CHASSIS EQUIPMENT

5-speed automatic Torqueshift® series transmission with overdrive
55-gal. fuel tank
130-amp alternator
5,000-lb. hitch with 7-pin plug
A/C and cruise control from factory
Dome lights
Hellwig® helper springs
Power anti-lock brakes with power steering
Power windows and door locks
Rubber body mounts
Tilt steering wheel
Triton™ 6.8L EFI V-10 305 HP engine

## STANDARD CONSTRUCTION FEATURES

84" ceiling height
Bead-foam insulation (R-15 max roof, R-9 max floor, R-7 max walls)
Cabinetry crafted with screwed-stile construction
Electric-powered slideout
Seamless one-piece rubber roof
TuffShell™ vacuum-bonded 5" crowned laminated roof
TuffShell™ vacuum-bonded laminated roof, floor and sidewalls
Unitized, 1-1/2" laminated construction of floor
Welded tubular-aluminum sidewall framework

## STANDARD EXTERIOR EQUIPMENT

80"-tall fiberglass, radius-cornered entrance door and screen door
120V G.F.C.I. protected exterior receptacle
Carefree® Travel'r™ 12V electric patio awning
Electric-powered, double entrance step
Exterior speakers, high-output marine-grade (2)
Fiberglass running boards
Fiberglass wings
Front molded fiberglass cap
FRP Lamilux® 4,000 smooth fiberglass sidewall exteriors
Heavy-duty grab handle for entry assistance
Lockable, exterior storage compartment with door pulls
One-piece polyethylene storage compartments

Pass-through storage compartment with light (select models)
Patio light with inside switch
Powder-coated steel rear bumper
Roof ladder
Slideout battery tray
Spare tire and tire carrier with tire cover
Undercoating
Wheel liners

## STANDARD INTERIOR EQUIPMENT

26" digital LCD HDTV (31SS, 31FK)
32" digital LCD HDTV (31GS, 31FS)
Cable TV hookup with RG6 coax
Crank-up digital antenna with signal booster
Decorative oil-rubbed bronze lighting
Decorative pillows for sofa
Deluxe hidden cabinet hinges
Fabric-covered box valances with lambrequin legs
High-intensity halogen recessed 12V lighting package
J-Steel™ sofa
Northridge Maple cabinetry
Overhead cabinet for TV (N/A with front entertainment center)
Padded ceiling vinyl
Padded wings behind cab
Prep for satellite dish for roof and sidewall
Residential furniture, designed and made by Jayco®
Trackless carpeting with padding throughout unit

## STANDARD HEAT, POWER AND WATER

6-gal. gas/electric DSI auto-ignition water heater
12V demand water pump
12V electrical system with 120V, 45-amp power converter
30-amp power cord
56-lb. chassis-mounted propane gas tank
13,500-BTU ducted A/C
Auto-ignition furnace with wall thermostat
Black holding tank sprayer
Conveniently placed water pump switches
Heated holding tanks, 12V pads
Hookup for city water
Interior Command Center®
Onan® 4,000-watt MicroQuiet™ generator with auto-changeover
Outside shower
Water heater bypass system

## STANDARD SAFETY EQUIPMENT

Battery disconnect switch
Driver and passenger air bags
Egress window
Fire extinguisher
Lap safety belts in living area
Lock and deadbolt on entrance door
Propane/carbon monoxide alarm
Smoke alarm
Third brake light
Tinted safety-glass windows

## OPTIONS

22" LCD HDTV in bedroom
400-watt inverter
Bunk DVD players (2) (31FS)
Comfort lounge sofa
Canadian standards
Customer Value Package
Diamond Shield™ paint protection film
Driver/passenger side-view cameras
Front entertainment center with 32" LCD HDTV
Navigation system
Provincial Glazed Maple cabinetry
Satellite kit
Sofa in lieu of dinette (31GS)
Winegard® dome satellite dish

## CUSTOMER VALUE PACKAGE

Attic fan
Bathroom power vent
Deluxe, remote-control, heated, side-view mirrors
Glass shower door
Pleated day/night shades throughout
Portable, outside gas grill
Touch-Screen Premium In-Dash Sound System™ AM/FM/CD/DVD with back-up camera monitor
Woodgrain dash kit

# Specifications

FLOORPLAN	EXTERIOR LENGTH	EXTERIOR HEIGHT W/AC	INTERIOR HEIGHT	GROSS VEHICLE WEIGHT RATING (LBS.)	GROSS COMBINED WEIGHT RATING (LBS.)	ENGINE/SIZE	WHEEL BASE	FURNACE AUTO-IGNITION (BTUS)	FRESH WATER CAPACITY (GALS.) (INCLUDES WATER HEATER)	GRAY WASTE WATER CAPACITY (GALS.)	BLACK WASTE WATER CAPACITY (GALS.)
31FK	32' 6"	136"	84"	14,500	19,500	6.8L Triton EFI V10	223"	31M	39	41	32
31FS	32' 6"	136"	84"	14,500	19,500	6.8L Triton EFI V10	223"	31M	39	44	32
31GS	32' 6"	136"	84"	14,500	19,500	6.8L Triton EFI V10	223"	31M	39	41	32
31SS	32' 1"	136"	84"	14,500	19,500	6.8L Triton EFI V10	218"	31M	39	41	32

# Floorplans

◀ = outside storage    MICRO. = microwave    REFRIG. = refrigerator  
 LAV. = bathroom sink    OHC. = overhead cabinets    WARD. = wardrobe

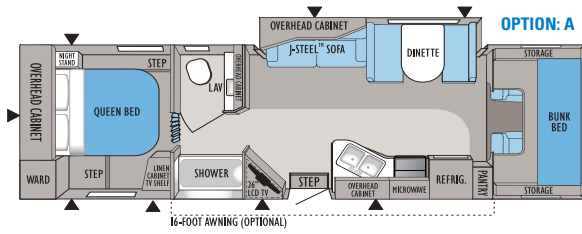

## GREYHAWK | 31FK

Ext. Length: 32' 6" Ext. Height: 136"

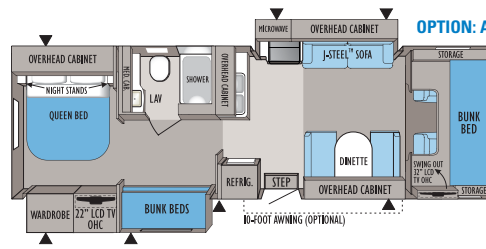

## GREYHAWK | 31FS

Ext. Length: 32' 6" Ext. Height: 136"

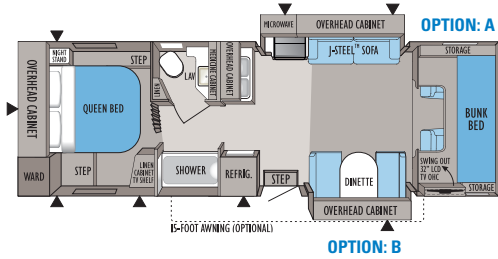

## GREYHAWK | 31GS

Ext. Length: 32' 6" Ext. Height: 136"

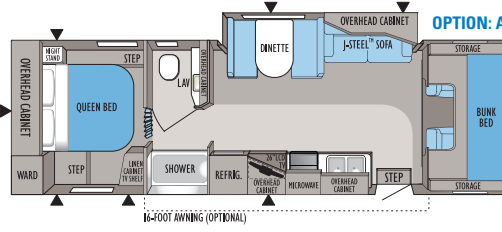

## GREYHAWK | 31SS

Ext. Length: 32' 1" Ext. Height: 136"

# Floorplan options (available on select models only)

OPTION A



OPTION B



# Interior color options



CEDAR

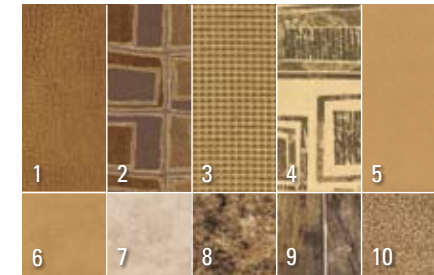

CHESTNUT

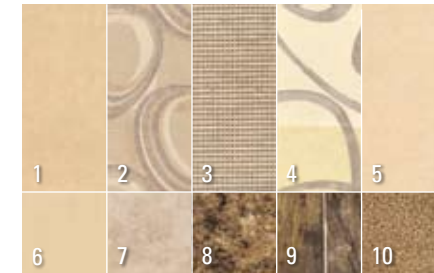

SANDSTONE



WOOD OPTIONS

- 1 Sofa and driver/passenger chairs
- 2 Accent fabric
- 3 Accent fabric
- 4 Bedroom accent
- 5 Bedroom accent
- 6 Drapery
- 7 Wall panel
- 8 Countertop
- 9 Flooring
- 10 Carpet

**Gross Vehicle Weight Rating (GVWR):** GVWR means the maximum permissible weight of the motorhome, including the Unloaded Vehicle Weight (UVW) plus passengers, personal items, all cargo, fluids, options and dealer-installed accessories. The GVWR is equal to or greater than the sum of the UVW and the Cargo Carrying Capacity.

**Gross Combined Weight Rating (GCWR):** The maximum allowable combined weight of the motorhome used as a tow vehicle and the attached towed vehicle.

It is important for your safety and enjoyment that you are aware of the weights and tow ratings of the RV you select. Consult a competent advisor for questions or advice. Whether you are new to RVing or a veteran, get a feel for the performance of your RV before heading out on the roadways. When you tow a vehicle with your RV, you must drive differently than when you drive a single vehicle. Practice hooking up, driving, backing up and braking in a safe environment or seek out professional instruction. Jayco affixes a weight label to each RV which lists weight information for that vehicle. Refer to that label to verify the vehicle will meet your requirements.



AMERICA'S MOST **LIVEABLE** RVs.

## 2 YEAR WARRANTY

The Jayco Co-Pilot Warranty is a manufacturer's limited warranty. It comes from the people who build Jayco recreation vehicles to the people who buy them. Each Jayco is warranted to the original purchaser for twenty-four (24) months or twenty-four thousand (24,000) miles (mileage limitation applies to motorized products only), whichever occurs first, from the original date of purchase against defects in materials and workmanship. Jayco's limited warranty is not transferable.

**Go ahead and compare the Jayco warranty with other manufacturers' warranties. You'll find it's the best in the business!**

For a copy of the limited warranty with full terms and conditions, ask your local Jayco dealer.

Your Jayco Dealer

## 300 JAYCO DEALERS

Establishing a solid relationship with your local Jayco dealer is a key component in the enjoyment of your new Jayco. By purchasing from a local dealer, you will have a convenient location for sales, parts and service support.

Jayco dealers are required to deliver all products at the site of the sale to provide a full product orientation and walkthrough at the time of delivery. It's a good way to become familiar with your Jayco and to meet the service, parts and warranty staff members who will be assisting you. If you live in Canada, there are regulations that must be met when buying a Jayco RV. Your local Canadian dealer is a professional at meeting these requirements and regulations. There simply is no substitute for a good relationship with your local Jayco dealer.

## 1 YEAR ROADSIDE ASSISTANCE

Travel worry-free with Jayco's Customer First Roadside Assistance program, yours at no cost during your first year of ownership. This program is offered through Coach-Net®, the largest RV emergency road service in the country, and gives you immediate access to dependable roadside assistance and support services with a simple phone call.

- Free jump starts
- Free tire changes
- Free fuel delivery
- Free lockout service
- Free travelers checks
- Toll-free nationwide service appointment assistance
- 24-hour toll-free emergency message service
- Free custom trip routing and full-color map service
- Free dispatch of on-site mechanical service
- \$2,000 trip-interruption reimbursement
- RV technical assistance hotline
- Free towing to nearest qualified service



Jayco proudly sponsors Tread Lightly!®, a nonprofit organization whose mission is to empower generations to enjoy the outdoors responsibly through education and restoration.



From RV insurance to extended warranties, JayPlus has it covered. Ask your Jayco dealer about our exclusive JayPlus program today.



As a Jayco owner, you can be part of the Jayco Jafari International Travel Club. Ask your dealer about the Jafari "flight" in your area, write Jayco or visit our website.

Jayco, Inc., P.O. Box 460, Middlebury, IN 46540  
[www.jayco.com](http://www.jayco.com) 

See dealer for further information and prices. All information in this brochure is the latest available at the time of publication approval. Jayco reserves the right to make changes and to discontinue models without notice or obligation. Photos in this brochure may show optional equipment and props for photography purposes. RVs built for sale in Canada may differ to conform to Canadian codes. ©2010 Jayco, Inc. 10-GREY-PL 0809-50K Printed in U.S.A.