

2011

# Embark

MOTORHOMES BY JAYCO



**Jayco**<sup>®</sup>

AMERICA'S MOST LIVEABLE RVs.



## TRUE VALUE OF OWNERSHIP

With Jayco, you get more amenities, more liveable, home-like features and superior construction for better durability and greater resale value. **Simply put, you won't find another RV packed with more TRUE VALUE — from the time of purchase to the time you sell.**

- + 2-year warranty
- + more standard features
- + more brand-name components
- + less maintenance
- + better resale value

---

### True Value of Jayco Ownership

Learn more about Jayco's True Value by finding the blue arrows  throughout this brochure.



AMERICA'S MOST LIVEABLE RVs.



### CERTIFIED GREEN

All Jayco products are green certified by TRA Certification Inc., an independent, third-party certification agency. Embark earned gold certification through the use of sustainable materials, environmentally-friendly production methods, energy-efficient components and reduction of waste.



WE BACK OUR PRODUCTS FOR 2 YEARS. ASK OUR COMPETITION WHY THEY DON'T.

You want your RV to last a long time. And nobody backs their RVs better than we do. Our exclusive two-year Co-Pilot Warranty is the best in the business and provides assurance that you'll enjoy your purchase for many years.



## Power broker.

Sit back and enjoy the ride in the Jayco Embark, an unprecedented combination of unrivaled luxury and unbridled horses. Built on a Freightliner M2 chassis with an 8.3L, 350 HP Cummins ISC diesel engine, 3200 TRV six-speed Allison automatic transmission and 10-ton towing capacity, Embark has enough power to tow virtually any boat, vehicle or trailer. The interior boasts a level of luxury and sophistication usually reserved for five-star hotels, making Embark a Class C motorhome like no other, and the ultimate home away from home.



### ↑ FREIGHTLINER CHASSIS

Embark is built on a Freightliner Business Class M2 chassis, delivering a surprisingly tight 55-degree turning radius, making it as easy to park as it is to drive.



### ↑ MEGA STORAGE

Embark's extra-large exterior storage features convenient pass-through access, side-hinged baggage doors and plenty of room to keep your gear safe, secure and out of your way.

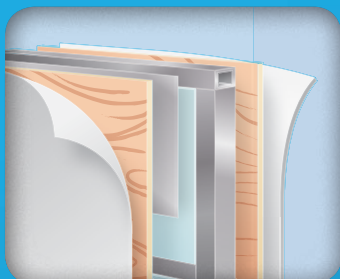

### ↑ DURABLE CONSTRUCTION

Our TuffShell sidewall construction features a light-weight welded aluminum frame, bead-foam insulation, plywood and steel backer plates that are vacuum bonded for superior strength and weight reduction.



# Embark



## ↑ LIVEABLE FEATURES

Every Jayco comes packed with features and amenities designed to make your life easier and family time more enjoyable.



### POWER

You can safely and easily tow up to 10 tons thanks to Embark's 20,000-lb. hitch, 8.3L, 350 HP Cummins ISC diesel engine and a 3200 TRV six-speed Allison automatic transmission with overdrive.



### SAFETY

With safety as a top priority, Jayco includes a seat belt for every built-in seating position.



### EXTERIOR ENTERTAINMENT

You'll love Embark's exterior entertainment system, with AM/FM/CD/DVD stereo and 32" LCD HDTV (Customer Value Package).







EMBARK TB390 | CHAMPAGNE



EMBARK TB390 | CHAMPAGNE



EMBARK TB390 | CHAMPAGNE



# JAYCO CONSTRUCTION

At Jayco, we've built a reputation for superior construction and craftsmanship. We always use top-quality materials and production techniques, giving our products reliable resale value and our owners peace of mind.



## INSIDE ENGINEERING

Much of what gives a Jayco its reputation for durability and strength is inside the walls and under the chassis. The Embark features 1 aerodynamic seamless front and rear fiberglass caps, 2 thermal pane windows, 3 premium full-body paint package, 4 20,000-lb. towing capacity, 5 Freightliner Business Class M2 chassis, 6 Cummins ISC 8.3L, 350 HP engine and 7 rear air-ride suspension.

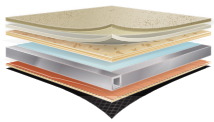

### FLOOR

Vacuum-bonded lamination joins our aluminum frame with a heavy-duty Structurwood floorboard to create one of the industry's strongest foundations.

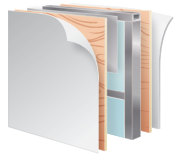

### WALLS

TuffShell vacuum-bonded lamination combines welded aluminum frames, high-gloss, gel-coated fiberglass exterior siding and metal backers to create a durable structure designed to withstand use and travel.

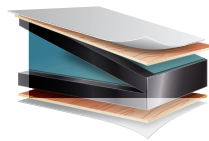

### ROOF

The laminated, vacuum-bonded roof is comprised of 3/16" plywood decking on 5" arched welded aluminum trusses with bead-foam insulation (R-23) and a seamless fiberglass shield that protects against moisture and resists aging.

## Embark | EXTERIOR COLORS



ESPRESSO PREMIUM PAINT (STANDARD)



MAHOGANY PREMIUM PAINT (OPTIONAL)

## Embark | FLOORPLANS

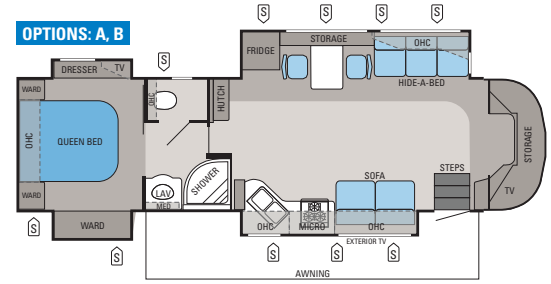

### EMBARK | QX390

Ext. Length: 39' 1" Exterior Height: 145"

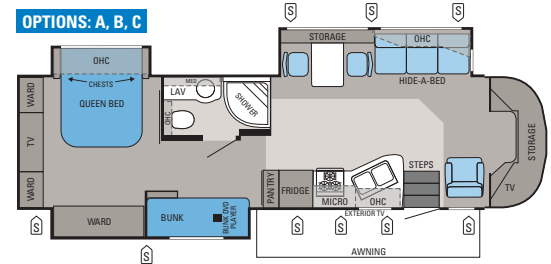

### EMBARK | TB390

Ext. Length: 39' Exterior Height: 145"

#### OPTION A

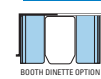

#### OPTION B



#### OPTION C



- OUTSIDE STORAGE
- TRAILER HITCH
- BATHROOM SINK
- MICROWAVE
- OVERHEAD CABINETS
- REFRIGERATOR
- WARDROBE

## INTERIOR DÉCOR CHOICES

### CORDOVAN

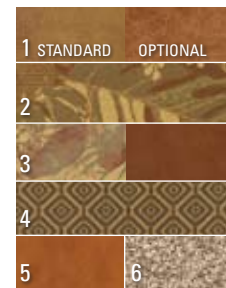

### IVORY

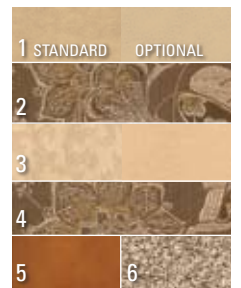

### CHAMPAGNE

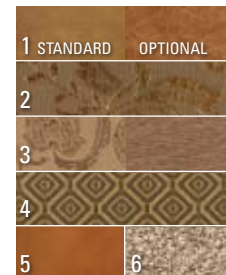

### CASHMERE

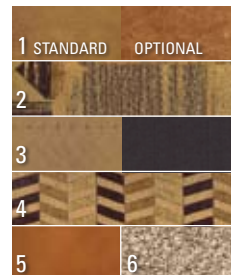

- 1 Sofa & driver/passenger seats
- 2 Accent fabric
- 3 Bedroom accent fabrics
- 4 Kitchen chairs
- 5 Wood
- 6 Carpet

# Embark | STANDARDS AND OPTIONS

## STANDARD BATHROOM EQUIPMENT

6-panel residential-style passage doors
† DuPont Corian countertops with integrated sink bowl
Fiberglass radius shower
Nickel fixtures
Overhead cabinet above stool
Residential laminate flooring
Residential medicine cabinet with mirror
Skylight in shower with light
Thetford porcelain stool with foot pedal
Toilet paper holder
Towel holder
Towel ring
Vanity light fixture

## STANDARD BEDROOM EQUIPMENT

22" digital LCD HDTV (QX390)
40" digital LCD HDTV (TB390)
Decorative headboard
Dresser drawers, residential-style
Halogen nickel reading lights over bed
Large wardrobe in bedroom
Queen bed with pillowtop mattress (60" x 74")
Quilted bedspread with pillow shams

## STANDARD KITCHEN EQUIPMENT

† 10 cu. ft. flush-mount refrigerator with ice maker
Ball bearing drawer guides 75-lb. capacity with full-drawer extension
† Convection microwave oven GE 1.4 cu. ft. with carousel
† DuPont Corian kitchen countertops with integrated sink bowls
Fluorescent lighting under cabinet
Free-standing table with (2) chairs and (2) folding chairs
High-rise single-lever faucet with pull-out sprayer
Mini-blind
Recessed 3-burner range with 9,000-BTU SuperBurner and piezo igniter
† Recessed solid-surface stove covers (2)
† Residential hardwood plank flooring
Silverware drawer, divided for utensils
Splash guard, made of Plexiglas
Water purification system

## STANDARD CAB EQUIPMENT

3-point, lap and shoulder safety belts (driver and passenger)
12V auxiliary in-dash receptacle
Air horn (mounted under cab)
Aluminum cab
Auxiliary start switch
Bug screen in grille
† Chassis battery disconnect
† Full-front cab sound insulation
Intermittent windshield wipers
One-piece 2,500-sq. in. windshield
Overhead directional reading lights
Padded fabric headliner
Privacy curtains for cab area
Upgraded driver/passenger seat with full front/back adjustment and map pockets
Wing dash

## STANDARD CHASSIS EQUIPMENT

2 chassis batteries
4.78 rear axle ratio
6-speed automatic Allison 3200 TRV Series transmission with overdrive
22.5" radial tires
55-degree turning radius

100-gal. fuel capacity
160-amp alternator
275" wheel base
12,000-lb. front axle with taper-leaf suspension
† 20,000-lb. hitch with 7-pin plug
23,000-lb. rear axle with airliner suspension
120,000-KSI frame
† Accuride aluminum rims
Air brakes with ABS (Anti-lock Braking System)
Air inflation hose
Auxiliary driving lights
Cruise control
† Cummins ISC 8.3L engine with 350 HP 1,000-lb.-ft. torque at 1,400 RPM
Dash A/C
† Deluxe, heated, remote-control, side view mirrors
Dome lights
Driver-controlled axle lock
† Dual rear leveling valves
Engine exhaust brake
Freightliner Business M2 106 chassis
† Leather-wrapped steering wheel
Power door locks
Power windows
Tilt and telescoping steering
Transmission temperature gauge

## STANDARD CONSTRUCTION FEATURES

Bead-foam insulation (R-23 roof, R-9 floor, R-9 walls)
Deluxe hidden cabinet hinges
Electric-powered slideout
† Hardwood cabinetry crafted with screwed-stile construction
One-piece fiberglass roof
Smooth gel-coat fiberglass exterior walls
† TuffShell vacuum-bonded 5" crowned laminated roof
† TuffShell vacuum-bonded laminated curved sidewalls
Unitized, 1-1/2" laminated construction of floor
Welded tubular-aluminum sidewall framework

## STANDARD EXTERIOR EQUIPMENT

84" tall fiberglass, radius-cornered curved entrance door and screen door
120V G.F.C.I. protected exterior receptacle
† Carefree 120V Apex electric roof-mount patio awning
Door for dump valve access
Electric-powered, triple entrance step
Espresso Premium Paint Package
Fiberglass caps on front and rear with radius corners
Heavy-duty grab handle for entry assistance
Hydraulic automatic leveling jacks
One-piece polyethylene pass-through storage compartments
Patio light with inside switch
Roof ladder
Side-hinged baggage doors
Slideout awning toppers (on select slideouts)
Sliding battery tray
Undercoating
† Uni-Dock utility center, heated and enclosed

## STANDARD INTERIOR EQUIPMENT

Cable TV hookup with RG6 coax
Crank-up digital antenna for TV with signal booster
Decorative lighting throughout
Decorative pillows for sofa and hide-a-bed
Decorative trim package
Entertainment center, includes 32" digital LCD HDTV
Heavy-duty grab handle for entry assistance
High-intensity halogen recessed 12V lighting package

Optima leather hide-a-bed sofa
Overhead cabinetry in slideout rooms
Padded vinyl ceiling throughout
Prep for satellite dish for roof and sidewall
Residential trackless carpeting with padding (bedroom and living room)
† Washington Glazed Maple solid hardwood cabinetry and raised-panel doors throughout

## STANDARD HEAT, POWER & WATER EQUIPMENT

10-gal. gas/electric DSI auto-ignition water heater
12V demand water pump
12V electrical system with 120V, 80-amp power converter
50-amp, quick-connect power cord
106-lb. propane gas tank, chassis-mounted
1,800-watt inverter with 4 batteries
† 15,000-BTU low-profile central A/C with heat pump and Chillrille in both living room and bedroom
Auto-ignition furnace with wall thermostat
Battery disconnect switch
Black holding tank sprayer
Conveniently placed water pump switches
Digital thermostat
† Dual full-length insulated ceiling ducts with adjustable air vents
Holding and fresh water tanks
Hookup for city water
† Onan 8,000-watt Quiet Diesel generator with auto-changeover
† Onan Energy Command center
Outside shower
Systems monitor panel
Water heater bypass system

## STANDARD SAFETY EQUIPMENT

Daytime running lights
Deadbolt lock on entrance door
Egress window
Fire extinguisher
Lap safety belts in living area
Propane/carbon monoxide alarm
Recessed fog lights
Smoke alarm
† Thermal pane tinted safety-glass windows
Third brake light

## OPTIONS

12 cu. ft. refrigerator with ice maker (TB390)
Booth dinette
Customer Value Package
Diamond Shield paint protection film
Exterior refrigerator/freezer
Leather furniture upgrades
Mahogany Premium Paint Package
Satellite kit
Ultra leather dinette and sofa ensemble
Winegard dome satellite dish

## CUSTOMER VALUE PACKAGE

Attic fan
Bathroom power vent
† Exterior entertainment center with AM/FM/CD/DVD stereo and 32" digital LCD HDTV
Pleated day/night shades
Powered driver and passenger seat
Radius-glass shower door
† Touch-Screen AM/FM/CD/DVD with back-up camera monitor, navigation and Bluetooth

# Embark | SPECIFICATIONS

FLOORPLAN	EXT. LENGTH	EXT. HEIGHT (WITH A/C)	INT. HEIGHT	GROSS VEHICLE WEIGHT RATING (LBS.)	GROSS COMBINED WEIGHT RATING (LBS.)	ENGINE/SIZE	WHEEL BASE	FURNACE AUTO-IGNITION (BTU)	FRESH WATER CAPACITY (INCLUDES WATER HEATER) (GALS.)	GRAY WASTE WATER CAPACITY (GALS.)	BLACK WASTE WATER CAPACITY (GALS.)
QX390	39' 1"	145"	80"	33,000	53,000	CUMMINS ISC-350 8.3L	275"	40M	105	52	52
TB390	39'	145"	80"	33,000	53,000	CUMMINS ISC-350 8.3L	275"	40M	105	52	52



AMERICA'S MOST **LIVEABLE** RVs.



WARRANTY

### INDUSTRY-LEADING WARRANTY

The Jayco Co-Pilot Warranty is a manufacturer's limited warranty. It comes from the people who build Jayco recreation vehicles to the people who buy them. Each Jayco is warranted to the original purchaser for twenty-four (24) months or twenty-four thousand (24,000) miles (mileage limitation applies to motorized products only), whichever occurs first, from the original date of purchase against defects in materials and workmanship. Jayco's limited warranty is not transferable. Go ahead and compare the Jayco warranty with other manufacturers' warranties. You'll find it's the best in the business!

For a copy of the limited warranty with full terms and conditions, ask your local Jayco dealer.



### OVER 300 LOCAL DEALERS

Establishing a solid relationship with your local Jayco dealer is a key component in the enjoyment of your new Jayco. By purchasing from a local dealer, you will have a convenient location for sales, parts and service support.

Jayco dealers are required to deliver all products at the site of the sale to provide a full product orientation and walkthrough at the time of delivery. It's a good way to become familiar with your Jayco and to meet the service, parts and warranty staff members who will be assisting you. If you live in Canada, there are regulations that must be met when buying a Jayco RV. Your local Canadian dealer is a professional at meeting these requirements and regulations. There simply is no substitute for a good relationship with your local Jayco dealer.



### 1-YEAR ROADSIDE ASSISTANCE

Travel worry-free with Jayco's Customer First Roadside Assistance program, yours at no cost during your first year of ownership. This program is offered through Coach-Net, the largest RV emergency road service in the country, and gives you immediate access to dependable roadside assistance and support services with a simple phone call.

- Free jump starts
- Free tire changes
- Free fuel delivery
- Free lockout service
- Free travelers checks
- Toll-free nationwide service appointment assistance
- 24-hour toll-free emergency message service
- Free custom trip routing and full-color map service
- Free dispatch of on-site mechanical service
- \$2,000 trip-interruption reimbursement
- RV technical assistance hotline
- Free towing to nearest qualified service



Jayco proudly sponsors Tread Lightly!, a nonprofit organization whose mission is to empower generations to enjoy the outdoors responsibly through education and restoration.



From RV insurance to extended warranties, JayPlus has it covered. Ask your Jayco dealer about our exclusive JayPlus program today.



As a Jayco owner, you can be part of the Jayco Jafari International Travel Club. Ask your dealer about the Jafari "flight" in your area, write Jayco or visit our website.

**Gross Vehicle Weight Rating (GVWR):** The maximum permissible weight of the motorhome, including the Unloaded Vehicle Weight (UVW) plus passengers, personal items, all cargo, fluids, options and dealer-installed accessories. The GVWR is equal to or greater than the sum of the UVW and the Cargo Carrying Capacity.

**Gross Combined Weight Rating (GCWR):** The maximum allowable combined weight of the motorhome used as a tow vehicle and the attached towed vehicle.

It is important for your safety and enjoyment that you are aware of the weights and tow ratings of the RV you select. Consult a competent advisor for questions or advice. Whether you are new to RVing or a veteran, get a feel for the performance

of your RV before heading out on the roadways. When you tow a vehicle with your RV, you must drive differently than when you drive a single vehicle. Practice hooking up, driving, backing up and braking in a safe environment or seek out professional instruction. Jayco affixes a weight label to each RV which lists weight information for that vehicle. Refer to that label to verify the vehicle will meet your requirements. See specifications chart inside.

Jayco, Inc., P.O. Box 460, Middlebury, IN 46540, [www.jayco.com](http://www.jayco.com) 

See dealer for further information and prices. All information in this brochure is the latest available at the time of publication approval. Jayco reserves the right to make changes and to discontinue models without notice or obligation. Photos in this brochure may show optional equipment and props for photography purposes. RVs built for sale in Canada may differ to conform to Canadian codes. ©2010 Jayco, Inc. 11-EMBK-PL 0810-50K Printed in U.S.A.