

EAGLE HALF-TON FIFTH WHEELS BY JAYCO

# EAGLE<sub>HT</sub>



*built for*  
**HALF-TON TRUCKS**





*exterior excellence*

ALUMINUM RIMS



EXTERIOR KITCHENETTE



ELECTRIC AWNING



**YOU WANT PEACE OF MIND**

That's why we offer our exclusive 2-year Co-Pilot Warranty, the industry's best and most comprehensive warranty program.



*the half-ton towable,*  
**MIDWEIGHT**  
*marvel*



**WEIGHING IN UNDER 7,200 POUNDS, the Eagle HT fifth wheel is designed for today's smaller trucks. Delivering on every exterior detail, Jayco has combined towability with convenience for an ultimate, affordable, midweight package.**

*Got what it takes*  
**TO TOW**  
**A FIFTH WHEEL?**

Here are just a few of the nearly 100 half-ton trucks up to the challenge.

**CHEVROLET SILVERADO**

1500 Ext. Cab, Std. Bed, 2WD, 6.2L V-8

**DODGE RAM**

1500 Reg. Cab, Short Bed, 2WD, 4.7L V-8

**FORD F-150**

Reg. Cab, Short Bed, 2WD, 5.0L V-8

**GMC SIERRA 1500**

Ext. Cab, Std Bed, 2WD, 6.2L V-8

**NISSAN TITAN**

King Cab, Short Bed, 2WD, 5.6L V-8

**TOYOTA TUNDRA**

Reg. Cab, Long Bed, 2WD, 5.7L V-8

\* Consult with your authorized automobile manufacturer or vehicle owner's manual.

**BLACK TANK FLUSH**



**EXTERIOR SPEAKERS**



**WITH YOUR PURCHASE**

Every Jayco RV undergoes rigorous quality control testing before it leaves the factory, so you can be confident your new Jayco will continue to provide the ultimate in reliability for years to come.

For a copy of our 2-year limited warranty with full terms and conditions, ask your local Jayco dealer.



TO LEARN MORE ABOUT OUR QUALITY CONTROL TESTING, SCAN HERE WITH YOUR SMARTPHONE.





EAGLE HALF-TON FIFTH WHEELS

# SPACIOUS INTERIORS

The Eagle HT features everything you love about its larger counterpart, but in a much lighter package. With space-making slideouts, a private bedroom and a full-featured bathroom, you won't have to sacrifice amenities for towability.







EAGLE HT 27.5BHS | BROWNSTONE



EAGLE HT 26.5RKS | COCOA



EAGLE HT 27.5BHS | BROWNSTONE



EAGLE HT 26.5RKS | COCOA

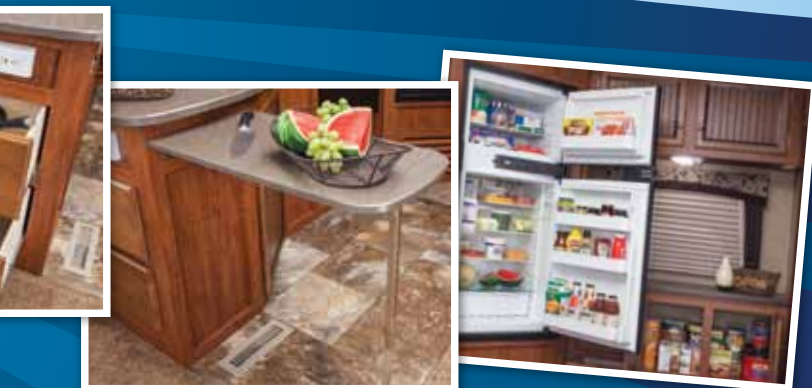

## EFFICIENT KITCHEN

Pack the whole kitchen. In an Eagle HT, there's no shortage of usable space thanks to a select model pots and pans drawer, countertop extension and 6 cu. ft. Norcold refrigerator with magnet-friendly panels.





# jayco CONSTRUCTION

At Jayco, we've built a reputation for superior construction and quality craftsmanship. We pride ourselves on always using top-quality materials and innovative manufacturing techniques. That commitment has led to our latest construction advancement, the all-new exclusive Magnum Roof System, 50 percent stronger than other roofs in the industry, built to outlast everything but your memories.



## OUR NEW ROOF FEATURES ...

- 1 4 1/2" crowned wood trusses: Uses 2" x 2" vertical studs to maximize load capacity, while oversized nail plates provide a tighter design
- 2 3/8" roof decking, screwed down at every seam: More durable than typical stapled construction, provides fully walkable roof
- 3 Residential attic-style insulation: Maintains interior temperatures while allowing for room to run wiring, reducing risky electrical shorts
- 4 One-piece, sidewall-wrapped Alpha Ply material: Provides leak protection



## WALL CONSTRUCTION

- 5 TuffShell vacuum-bonded sidewalls, slideouts, back wall
- 6 Smooth fiberglass exterior
- 7 Welded aluminum frames
- 8 Double-layer of front cap fiberglass insulation

## FLOOR CONSTRUCTION

- 9 5/8" tongue-and-groove plywood on 2" x 3" wooden floor joists on 16" centers
- 10 Full-width outriggers
- 11 Bedroom floor Flexfoil and fiberglass insulation



## CLIMATE SHIELD

ULTIMATE WEATHER PROTECTION

**12 Extend your camping season.** Offering weather protection against extreme temperatures (as low as 0° F or as high as 100° F), the Climate Shield combines the industry's most-protected underbelly with the class's highest-BTU output furnace. The enclosed underbelly, tucked and foamed inside the I-beam rails, features blown heat for the ultimate four-season camping experience.

The Climate Shield features the following R-values.

VALUE	UNIT AREA	TYPE OF INSULATION
R-5	All vertical walls	Block foam
R-15	Behind front cap	Double R-7 insulation
R-27	Roof	Double R-7 insulation + R-14 foil
R-29	Main floor	Double R-7 insulation + R-14 foil
R-14	Slide floor	R-14 foil
R-22	Bedroom floor	R-7 insulation + R-14 foil
R-14	Inside open pinbox	R-14 foil

\* Eagle HT was tested in 0°F and 100°F weather over an extended period of time in a controlled environment and all functions of the coach were fully operational. Testing cannot account for natural elements, such as wind or moisture. In actual use, unit may not perform as well. In addition, outside components are subject to freezing and require steps to properly insulate. Jayco's warranty does not cover damage caused by freezing.



**eco advantage™** [www.jayco.com/ecoadvantage](http://www.jayco.com/ecoadvantage)

THE JAYCO ECOADVANTAGE IS OUR COMPANY'S COMMITMENT TO PROTECTING THE ENVIRONMENT. Scan this QR code with your smartphone to watch a video about our efforts and the impact we're having on our world.

## FLOORPLANS

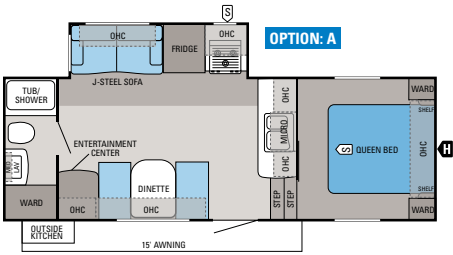

### EAGLE HT FIFTH WHEEL | 23.5RBS

Ext. Length: 25' 10" Ext. Height: 143" Unloaded Wt. (lbs.): 5,975 Sleeps: 4-6

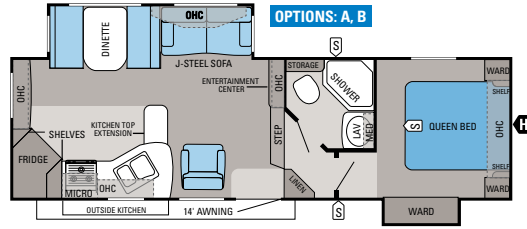

### EAGLE HT FIFTH WHEEL | 26.5RKS

Ext. Length: 30' Ext. Height: 145" Unloaded Wt. (lbs.): 6,920 Sleeps: 6

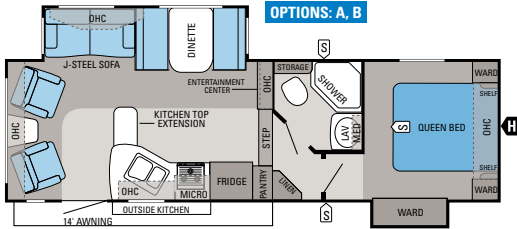

### EAGLE HT FIFTH WHEEL | 26.5RLS

Ext. Length: 29' 10" Ext. Height: 147" Unloaded Wt. (lbs.): 6,845 Sleeps: 5

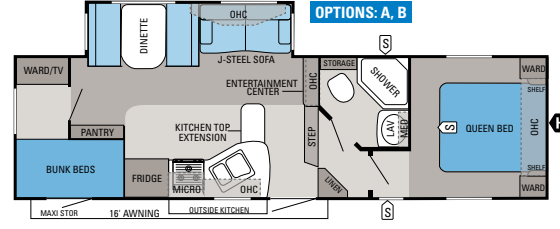

### EAGLE HT FIFTH WHEEL | 27.5BHS

Ext. Length: 31' 8" Ext. Height: 145" Unloaded Wt. (lbs.): 7,135 Sleeps: 8

## OPTIONS

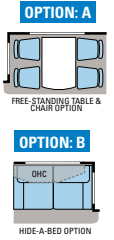

## SPECIFICATIONS

FLOORPLAN	EXT. LENGTH	EXT. WIDTH	EXT. HEIGHT (WITH A/C)	INT. HEIGHT (BEDROOM)	UNLOADED VEHICLE WEIGHT (LBS.)	DRY HITCH WEIGHT (LBS.)	GROSS VEHICLE WEIGHT RATING (LBS.)	CARGO CARRYING CAPACITY (LBS.)	FRESH WATER CAPACITY (GAL.) (WITH WATER HEATER)	GRAY WASTEWATER CAPACITY (GAL.)	TOILET/BLACK WASTEWATER CAPACITY (GAL.)
23.5RBS	25' 10"	96"	143"	74"	5,975	1,160	9,950	3,975	48	65	32.5
26.5RKS	30'	96"	145"	78"	6,920	1,320	9,950	3,030	48	65	32.5
26.5RLS	29' 10"	96"	147"	78"	6,845	1,285	9,950	3,105	48	65	32.5
27.5BHS	31' 8"	96"	145"	78"	7,135	1,350	9,950	2,815	48	65	32.5

The weights of certain options and/or option packages are not included in the UWW listed above.

## STANDARDS AND OPTIONS

### STANDARD EXTERIOR EQUIPMENT

- Unique, slate grey exterior
- TuffShell vacuum-bonded laminated sidewalls, slideout walls and rear wall
- I-Class cambered structural I-beam frame
- Fully enclosed and heated underbelly
- Magnum truss roof system
- Glacier Package (see package details)
- Radial tires
- Aluminum wheels
- E-Z Lube axles
- Nev-R-Adjust brakes
- Completely enclosed and protected slideout mechanisms
- 30" x 72" main entrance door
- Oversized entry step with safety light
- Extendable grab handle at main entry
- Exterior-marine grade speakers (2)
- Large pass-through basement storage (n/a 23.5RBS)
- Large patio scare light
- G20 dark-tinted safety glass windows
- Black tank flush
- Outside shower
- Hidden kitchenette compartment for outdoor cooking
- Cable/satellite prep
- Digital TV antenna
- 30-amp power service
- Battery disconnect switch
- 3,000-lb. integrated rear hitch receiver (23.5RBS)
- Stabilizer jacks (2)

### STANDARD INTERIOR EQUIPMENT

- Concord Cherry, Victorian-style cabinetry
- Lumbercore screwed cabinet construction
- Oversized pots and pans drawers (n/a 23.5RBS)
- Full-height kitchen cabinetry
- Large, split kitchen sink
- High-rise mixing faucet
- Kitchen countertop extension (n/a 23.5RBS)
- Ball bearing drawer guides, steel, 50-lb. capacity, full extension
- 6 cu. ft. refrigerator with magnet-friendly front panels
- 18 gal./hr. quick recovery gas/electric
- DSI water heater (6 gal.)
- Command center for switches with 12V cell phone charger
- Pleated night shades
- 26" LED HDTV
- Private bath
- Glass shower enclosure (n/a 23.5RBS)
- 60" x 80" deluxe master bedroom mattress
- 300-lb. rated bunk bed capacity (select models)

### CUSTOMER VALUE PACKAGE (MANDATORY)

- Electric patio awning
- Dual 30-lb. propane gas bottles with auto regulator
- 13,500-BTU A/C with Chillgrille feature and closeable, directional A/C vents
- Water heater bypass
- Microwave oven
- Kitchen sink cutting board covers (2)
- Multi Media Premium Sound System with AM/FM, CD/DVD and MP3 input jack

- Bath skylight
- Tile look tub/shower surround
- Quilted bedspread
- Dual shirt closets in main bedroom

### OPTIONS

- Satellite kit: Dish, tripod, 20' cable and handheld satellite locator
- Reese Revolution pin box (allows for 90-degree turn on 6' bed)
- MOR/ryde pin box
- Electric rear stabilizer jacks
- Spare tire
- Bolt-on rear hitch
- Rear bumper-mount grill
- Thermal-pane tinted safety-glass windows
- 15,000-BTU A/C
- Free-standing table and 4 chairs (n/a 23.5RBS)
- Linoleum in living area (standard 23.5RBS)
- Recliner rocker in lieu of swivel rocker (26.5RKS and 26.5RLS)
- Air mattress hide-a-bed sofa



FOR A COMPLETE LIST OF STANDARDS AND OPTIONS, SCAN HERE WITH YOUR SMARTPHONE OR VISIT JAYCO.COM.

## INTERIOR DÉCOR CHOICES

### AMBER



### BROWNSTONE

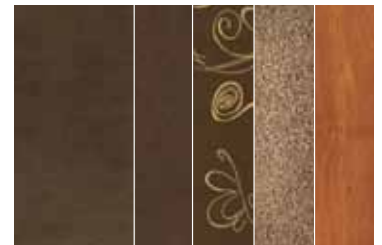

### COCOA

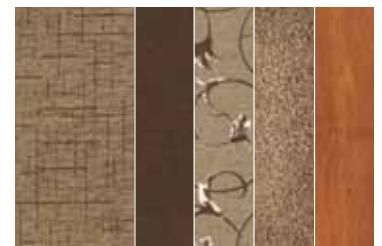





# THE Jayco® family STORY

**THE JAYCO STORY BEGAN IN 1968 WITH OUR FAMILY—THE BONTRAGERS.** Lloyd Bontrager created an innovative, easy-to-use lifter system that led to a better fold-down camper. Loaded with more conveniences, he believed his camper would bring families closer together.

Since then, the Jayco family has grown. From our factory to our front office, from our salespeople to our suppliers, our family bond is four decades strong with the support of more than 300 Jayco dealers.

Together, we're helping make new family stories. **YOUR FAMILY STORY.**

*welcome* to the Jayco family



Establishing a solid relationship with your local Jayco dealer is a key component in the enjoyment of your new Jayco. By purchasing from a local dealer, you will have a convenient location for sales, parts and service support. We hope you enjoy working with them as much as we do.

**Coach-Net**  
RV Technical & Roadside Assistance

Travel worry-free with Jayco's Customer First Roadside Assistance program, yours at no cost during your first year of ownership. This program is offered through Coach-Net, the largest RV emergency road service in the country, and gives you immediate access to dependable roadside assistance and support services with a simple phone call.

tread lightly!  
OFFICIAL SPONSOR

Jayco proudly sponsors Tread Lightly!, a nonprofit organization whose mission is to empower generations to enjoy the outdoors responsibly through education and restoration.

**JayPlus**

From RV insurance to extended warranties, JayPlus has it covered. Ask your Jayco dealer about our exclusive JayPlus program today.

**Jafari** Discover  
America

As a Jayco owner, you can be part of the Jayco Jafari International Travel Club. Ask your dealer about the Jafari "flight" in your area, write Jayco or visit our website.

**Unloaded Vehicle Weight (UWV):** Sometimes referred to as "Dry Weight," UWV means the typical weight of this trailer as built at the factory. The UWV, as used in product literature and other promotional materials, does not include cargo, fresh water, propane, options or dealer-installed accessories.

**Gross Vehicle Weight Rating (GVWR):** GVWR means the maximum permissible weight of the trailer, including the UWV plus passengers, personal items, all cargo, fluids, options, and dealer-installed accessories. The GVWR is equal to or greater than the sum of the UWV and the CCC.

**Cargo Carrying Capacity (CCC):** CCC means the maximum weight of all passengers, personal items, food, fresh water, propane, tools, other cargo and dealer-installed accessories that can be carried by the trailer. CCC is equal to or less than GVWR minus UWV. The addition of options will decrease the CCC.

**Hitch Weight (HW):** The hitch weight, as used in product literature and other promotional materials, does not include cargo, fresh water, propane gas, options or dealer-installed accessories. The addition of these types of items will either add to or subtract from the stated hitch weight.

It is important for your safety and enjoyment that your tow vehicle be adequately sized and equipped to tow and handle the GVWR of the RV you select. Review weights and rating of your tow vehicle and consult a competent advisor for questions or advice. Whether you are new to RVing or a veteran, get a feel for the performance of your tow vehicle before heading out on the roadways. When you tow an RV, you must drive differently than when you drive a single vehicle. Practice hooking up, driving, backing up and braking in a safe environment or seek out professional instruction. Jayco affixes a weight label to each RV which lists weight information for that vehicle. See specifications chart inside.

Jayco, Inc., P.O. Box 460, Middlebury, IN 46540, [www.jayco.com](http://www.jayco.com)

See dealer for further information and prices. All information in this brochure is the latest available at the time of publication approval. Jayco reserves the right to make changes and to discontinue models without notice or obligation. Photos in this brochure may show optional equipment and props for photography purposes. RVs built for sale in Canada may differ to conform to Canadian codes. ©2012 Jayco, Inc. 13-EGHT-PL 1212-20K Printed in U.S.A.