

LOADED WITH VALUE **REDHAWK**



REDHAWK

MOTORHOMES BY JAYCO



## LUXURY STARTS WITH ATTENTION TO DETAIL

### A. REDHAWK'S WELL-APPOINTED CAB

Three-point lap and shoulder safety belts, power windows and locks, and deluxe remote control side view mirrors make driving to your destination a delight.



A

### B. MEGA STORAGE

Lockable exterior storage with door pulls provide easy access to your gear.



B

### C. SPACIOUS LIVING AREA

With residential-style furniture and kitchen, along with cable TV hookup with RG6 coax and digital antenna with signal booster, the Redhawk becomes your home away from home.



C

### D. SLEEP IN COMFORT

Redhawk's bedroom includes a queen-sized bed with quilted bedspread, large wardrobes and under-bed storage (select models), providing ample space for stowing the essentials.



D

### E. TRITON 6.8L EFI V-10 305 HP ENGINE

Redhawk combines the robust Triton engine with a Ford E-450 chassis for ultimate handling.

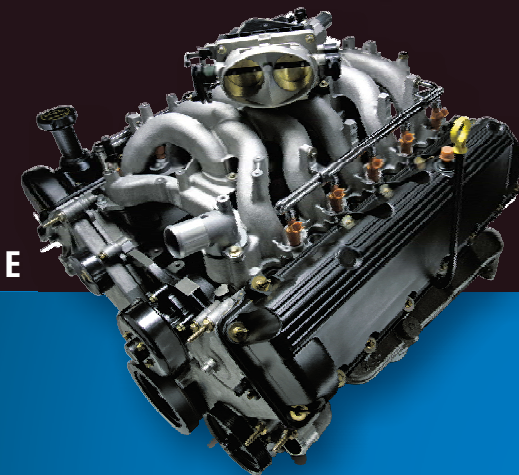

E



TO LEARN MORE ABOUT OUR QUALITY CONTROL TESTING, SCAN HERE WITH YOUR SMARTPHONE.

## eco advantage™

[www.jayco.com/ecoadvantage](http://www.jayco.com/ecoadvantage)



THE JAYCO ECOADVANTAGE IS OUR COMPANY'S COMMITMENT TO PROTECTING THE ENVIRONMENT. Scan this QR code with your smartphone to watch a video about our efforts and the impact we're having on our world.



## STANDARDS AND OPTIONS

### CUSTOMER VALUE PACKAGE

- Dometic 12V electric patio awning
- Front molded seamless fiberglass cap
- High gloss fiberglass sidewalls
- 32" digital LCD HDTV
- Black holding tank sprayer
- Heated holding tanks, 12V pads
- Rear back-up camera & monitor
- 8 cu. ft. flush-mount refrigerator with double doors
- i-Pod input jack
- 400 watt inverter

### STANDARD EXTERIOR FEATURES

- 80" tall fiberglass, radius-cornered entrance door and screen door
- 120V G.F.C.I. protected exterior receptacle
- Electric-powered, double entrance step
- Aluminum running boards
- Fiberglass front cap
- Heavy-duty grab handle for entry assistance
- Lockable exterior storage compartment
- Pass-through storage compartment with light (select models)
- Patio light with inside switch
- Roof ladder
- Slideout battery tray
- Undercoating

### STANDARD INTERIOR EQUIPMENT

- Cable TV hookup with RG6 coax
- Digital antenna with signal booster
- Brushed nickel cabinet hardware
- Fabric-covered box valances with lambrequin legs
- Pancake lights throughout
- Overhead cabinet for TV
- Flat-panel cabinet doors throughout
- Residential furniture by Jayco
- Linoleum throughout unit
- Washington Glazed cabinetry
- Decorative slideout fascia board
- Full cabover bunk mat with headboard

### STANDARD BATHROOM EQUIPMENT

- ABS shower with one-piece surround
- Accordion shower door
- Toilet with foot pedal flush

- Removable clothing rod in tub
- Skylight in shower
- Vent fan

### STANDARD BEDROOM EQUIPMENT

- Large wardrobes
- Queen bed
- Quilted bedspread, under-bed storage with gas struts (select models)
- TV hookups-recept and coax
- Roof vent

### STANDARD KITCHEN EQUIPMENT

- 8 cu. ft. flush-mount refrigerator
- 3-burner range with 9,000-BTU SuperBurner and piezo igniter
- Ball bearing drawer guides
- Dream Dinette mechanism, raises and lowers dinette tabletop (select models)
- High rise double-handle faucet
- Microwave oven with carousel
- Water purification system

### STANDARD HEAT, POWER AND WATER

- 12V demand water pump
- 12V electrical system with 120V, 60-amp power converter
- 6 gal. gas/electric DSI auto-ignition water heater
- 30-amp power cord
- LP gas tank 12.2 gal. / 53 lbs.
- 15,000-BTU ducted A/C
- 31,000 BTU furnace with wall thermostat
- Multiple water pump switches
- Hookup for city water
- Interior Command Center
- Onan 4,000-watt MicroQuiet generator
- Outside shower

### STANDARD CAB EQUIPMENT

- 3-point lap and shoulder safety belts
- Auxiliary start switch
- Factory driver and passenger seats
- Padded fabric headliner
- Privacy curtains for cab area

### STANDARD CHASSIS EQUIPMENT

- Ford E450 chassis
- Triton 6.8L EFI V-10 305 HP engine/ 420 lbs./ft. torque

- 130-amp alternator
- 5-speed automatic Torqueshift series transmission with overdrive
- 55-gal. fuel tank
- 5,000-lb. hitch with 7-pin plug
- A/C and cruise control from factory
- Tilt steering wheel
- Hellwig helper springs
- Power anti-lock brakes with power steering
- Power windows and door locks
- Rubber body mounts
- Deluxe remote control side view mirrors

### STANDARD CONSTRUCTION FEATURES

- 84" ceiling height
- Bead-foam insulation (R-15 max roof, R-9 max floor, R-7 max walls)
- Electric-powered slideout
- Seamless one-piece rubber roof
- TuffShell vacuum-bonded 5" crowned laminated roof
- TuffShell vacuum-bonded laminated roof, floor and sidewalls
- Unitized, 1-1/2" laminated floor construction
- Tubular-aluminum sidewall framework
- 4" tube bumper/ sewer hose storage

### STANDARD SAFETY EQUIPMENT

- Battery disconnect switch
- Driver and passenger air bags
- Egress window
- Fire extinguisher
- Lap safety belts on all seats in living area
- Lock and deadbolt on entrance door
- Propane/carbon monoxide alarm
- Smoke alarm
- Third brake light
- Tinted safety-glass windows

### OPTIONS

- Customer Value Package

## FLOORPLANS

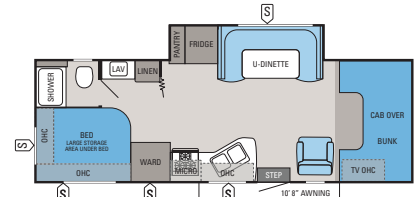

### REDHAWK | 26XS

Ext. Length: 28' 9" Exterior Height: 139" Sleeps: 4-6

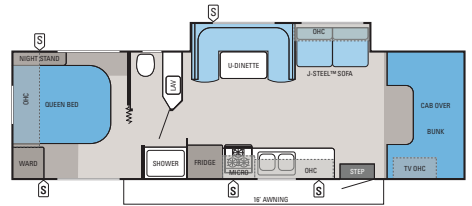

### REDHAWK | 29XK

Ext. Length: 32' 5" Exterior Height: 139" Sleeps: 6

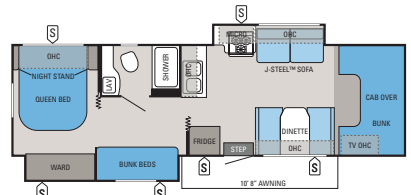

### REDHAWK | 31XL

Ext. Length: 32' 5" Exterior Height: 139" Sleeps: 7-9

## EXTERIOR



## INTERIOR DÉCOR CHOICES

### TOFFEE



### PRALINE



### WOOD



FLOORPLAN	EXT. LENGTH	EXT. WIDTH	EXT. HEIGHT (WITH A/C)	INT. HEIGHT	GROSS VEHICLE WEIGHT RATING (LBS.)	GROSS COMBINED WEIGHT RATING (LBS.)	ENGINE/SIZE	WHEEL BASE	FURNACE AUTO-IGNITION (BTUS)	FRESH WATER CAPACITY (INCLUDES WATER HEATER) (GALS.)	GRAY WASTE WATER CAPACITY (GALS.)	BLACK WASTE WATER CAPACITY (GALS.)
26XS	28' 9"	100"	139"	84"	14,500	19,500	6.8L TRITON EFI V10	181"	31M	32	40	32
29XK	32' 5"	100"	139"	84"	14,500	19,500	6.8L TRITON EFI V10	223"	31M	32	40	32
31 XL	32' 5"	100"	139"	84"	14,500	19,500	6.8L TRITON EFI V10	223"	31M	32	40	32

## YOU WANT PEACE OF MIND WITH YOUR PURCHASE

That's why we offer our exclusive 2-year Co-Pilot Warranty, the industry's best and most comprehensive warranty program.

Every Jayco RV undergoes rigorous quality control testing before it leaves the factory, so you can be confident your new Jayco will continue to provide the ultimate in reliability for years to come.

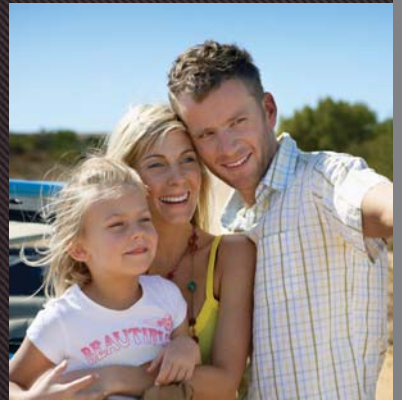
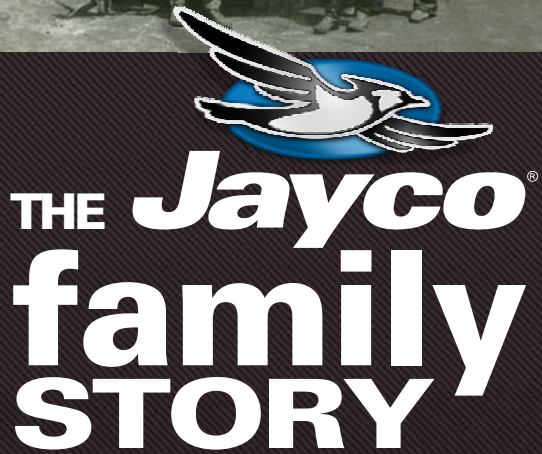

# THE Jayco family STORY

**THE JAYCO STORY BEGAN IN 1968 WITH OUR FAMILY – THE BONTRAGERS.** Lloyd Bontrager created an innovative, easy-to-use lifter system that led to a better fold-down camper. Loaded with more conveniences, he believed his camper would bring families closer together.

Since then, the Jayco family has grown. From our factory to our front office, from our salespeople to our suppliers, our family bond is four decades strong with the support of more than 300 dealers.

Together, we're helping make new family stories. **YOUR FAMILY STORY.**

welcome to the Jayco family



**Coach-Net®**  
RV Technical & Roadside Assistance

Travel worry-free with Jayco's Customer First Roadside Assistance program, yours at no cost during the first year of ownership. This program is offered through Coach-Net, the largest RV emergency road service in the country, and gives you immediate access to dependable roadside assistance and support services with a simple phone call.

Establishing a solid relationship with your local Jayco dealer is a key component in the enjoyment of your new Jayco. By purchasing from a local dealer, you will have a convenient location for sales, parts and service support. We hope you enjoy working with them as much as we do.



Jayco proudly sponsors Tread Lightly!, a nonprofit organization whose mission is to empower generations to enjoy the outdoors responsibly through education and restoration.



From RV insurance to extended warranties, JayPlus has it covered. Ask your Jayco dealer about our exclusive JayPlus program today.



As a Jayco owner, you can be part of the Jayco Jafari International Travel Club. Ask your dealer about the Jafari "flight" in your area, write Jayco or visit our website.

**Gross Vehicle Weight Rating (GVWR):** The maximum permissible weight of the motor coach, including the Unloaded Vehicle Weight (UVW) plus passengers, personal items, all cargo, fluids, options and dealer-installed accessories. The GVWR is equal to or greater than the sum of the UVW and the Cargo Carrying Capacity.

**Gross Combined Weight Rating (GCWR):** The maximum allowable combined

weight of the motor coach used as a tow vehicle and the attached towed vehicle.

It is important for your safety and enjoyment that you are aware of the weights and tow ratings of the RV you select. Consult a competent advisor for questions or advice. Whether you are new to RVing or a veteran, get a feel for the performance of your RV before heading out on the roadways. When you tow a vehicle with your RV, you must

drive differently than when you drive a single vehicle. Practice hooking up, driving, backing up and braking in a safe environment or seek out professional instruction. Jayco affixes a weight label to each RV which lists weight information for that vehicle. Refer to that label to verify the vehicle will meet your requirements. See specification chart inside.

Jayco, Inc., P.O. Box 460, Middlebury, IN 46540, [www.jayco.com](http://www.jayco.com) © **RVIA**

See dealer for further information and prices. All information in this brochure is the latest available at the time of publication approval. Jayco reserves the right to make changes and to discontinue models without notice or obligation. Photos in this brochure may show optional equipment and props for photography purposes. RVs built for sale in Canada may differ to conform to Canadian codes. ©2012 Jayco, Inc. 2013 Redhawk.cdr JM11-12 60K Printed in the U.S.A.