



GREYHAWK

FIND YOUR WAY TO FAMILY FUN



2015 GREYHAWK

CLASS C MOTORHOMES BY JAYCO

2
YEAR
WARRANTY

Read more about the only Class C **2-YEAR WARRANTY** on the back cover!

THE FUN FINDER

At Jayco, we focus on family fun when we build motorhomes. It's our compass — helping us find ways to make your getaway as enjoyable as the retreat. For 2015, the Jayco Greyhawk delivers the best value on the road with a feature-filled Customer Value Package that includes an industry-first JRide *Ride and Handling* Package, dark-tinted frameless windows and a touch-screen, in-dash infotainment system. On the inside, Washington Glazed cabinetry, solid-surface countertops and LED lighting pack comfort into your next adventure.



JRIDE

HANDS DOWN, THE BEST RIDE. Read more about our Ride and Handling package on Page 6!



DEDICATED TO SAFETY

Great design starts with great priorities — like your safety. Greyhawk, which touts a 305 HP Triton engine, comes equipped with lap belts in every seating position and remote-controlled, side-view mirrors with camera.*

* Customer Value Package



FRENCH VANILLA

CAPPUCCINO

SADDLE





High-end kitchens with one-piece, solid-surface countertops



Queen-sized bed with comfortable Denver Mattress*



31FS bunk beds for a maximum 9-person sleeping capacity



Customer Value Package dark-tinted frameless windows

* Customer Value Package



*** RIDE AND HANDLING. DEFINED.**



Superior construction meets a superior ride.

WALL CONSTRUCTION

- 1 Vacuum bonded: Features laminated layers of high-gloss fiberglass, lauan, aluminum framing, R-5 bead-foam insulation and vinyl paneling
- 2 Seamless fiberglass front cap: Increases aerodynamics, while cap adds durability and leak protection where it's needed most
- 3 Frameless windows (Customer Value Package): An industry-first on Class C motorhomes

FLOOR CONSTRUCTION

- 4 Vacuum bonded: Features laminated layers of Darco underbelly, lauan, a welded aluminum frame, R-9 bead-foam insulation and 5/8" Strukturwood
- 5 Welded aluminum frame: Lighter and more corrosion-resistant than competing steel frames, provides more cargo capacity

ROOF CONSTRUCTION

- 6 Vacuum-bonded layers: Features laminated layers of 5" arched aluminum trusses, moisture-resistant 1/4" plywood decking, R-15 bead-foam insulation and soft-touch ceiling
- 7 Seamless one-piece rubber roof: Features one-piece construction for better leak protection

* The JRide is a Customer Value Package feature.

STANDARDS AND OPTIONS

CUSTOMER VALUE PACKAGE

- JRide Package: Bilstein shocks, stabilizer bar, Hellwig helper springs and rubber isolation body mounts
- Hydraulic leveling jacks
- Infotainment system with in-dash, touch-screen radio with 6.5" LCD color display, DVD/USB, Sirius satellite prep, Bluetooth and built-in GPS
- Back-up and side-view cameras/monitor
- Remote-control, heated, side-view mirrors
- Frameless windows
- 12V electric awning with LED lights
- Portable, outside gas grill
- Tankless water heater
- 400-watt inverter
- 15,000-BTU air conditioner with heat pump
- Pillowtop Denver Mattress
- 22" LED TV in bedroom

STANDARD EXTERIOR EQUIPMENT

- TuffShell vacuum-bonded laminated floor, sidewalls and roof
- Bead-foam insulation (R-15 max roof, R-9 max floor, R-5 max walls)
- Champagne fiberglass exterior with vinyl graphics
- Front molded seamless fiberglass cap
- Fiberglass running boards
- Keyless entry door, touch-pad lock system
- Fiberglass, radius-cornered entrance door with screen door
- Electric-powered entrance step
- High-output, marine-grade exterior speakers (2)
- Pass-through storage compartment with slam latches and light (select models)
- Locking exterior storage compartments
- Onan 4,000-watt MicroQuiet generator with auto-changeover
- Slideout battery tray with house battery
- Illuminated battery disconnect switch
- 12V electrical system with 120V, 60-amp power converter
- 30-amp power cord
- 120V GFCI protected exterior receptacle
- 56-lb. propane tank
- Heated holding tanks, 12V pads
- 4" tube bumper with sewer hose storage
- Black tank sprayer
- Outside shower
- Roof ladder

STANDARD INTERIOR EQUIPMENT

- 84" ceiling height with padded vinyl ceiling
- High-intensity recessed LED ceiling lights
- Washington Glazed cabinetry with raised-panel doors and deluxe hidden hinges
- Ball bearing drawer guides
- 3-burner range with 9,000-BTU SuperBurner and piezo igniter
- 8 cu. ft. flush-mount refrigerator

STABILIZER BAR

- A Greyhawk's enhanced rear stabilizer bar raises and lowers each side of the unit to similar heights, increasing the torsion rate up to 2 1/2 times more than stock stabilizer bars. No other Class C is equipped with this.

BILSTEIN SHOCKS

- B Bilstein shock absorbers, not found on other Class Cs, reduce bounce and eliminate excessive sway. A unique monotube design doesn't trap heat, reducing shock failure.

HELLWIG HELPER SPRINGS

- C Fluctuating loads impact alignment, reduce traction and diminish handling. Hellwig helper springs correct this, compressing under loads to level out your RV.

JRIDE.JAYCO.COM

- Microwave oven
- Oven
- One-piece, solid-surface, high-gloss countertop with integrated deep bowl sinks and covers (2)
- 12V demand water pump
- Water filtration system
- Dream Dinette mechanism, raises and lowers dinette tabletop
- Lap safety belts on all living area seats
- Hide-a-bed sofa (29ME)
- Vinyl flooring in living area, kitchen and bath
- Interior command center
- 31,000-BTU auto-ignition furnace with wall thermostat
- 26" digital LED HDTV (31FK)
- 32" digital LED HDTV (29KS, 29ME, 29MV, 31DS and 31FS)
- Cable TV hookup with RG-6 coax
- Digital antenna with signal booster
- Satellite dish prep
- ABS shower with one-piece, decorative, tile/stone-look surround
- Skylight in shower with light
- Toilet with foot flush
- Queen-sized bed
- Bedroom carpet with pad
- Under-bed storage (select models)
- Full cab-over Denver Mattress bunk mat (750-lb. rating)
- Denver Mattress bunk mats (300-lb. rating) (31FS)

STANDARD DRIVING EQUIPMENT

- Ford E-450 chassis
- Triton 6.8L EFI V-10 305 HP engine with 420 ft-lb torque
- 5-speed TorqShift series transmission with overdrive
- 120-amp alternator
- 55-gal. fuel tank
- 5,000-lb. hitch with 7-pin plug
- Remote keyless entry
- Auxiliary start switch
- Power anti-lock brakes with power steering
- A/C and cruise control
- Tilt steering wheel
- 6-way start power driver seat
- Driver and passenger air bags
- Power windows and door locks
- Third brake light
- Wheel liners

OPTIONS

- Black Crimson exterior paint
- Mahogany Mist exterior paint
- Aluminum rims
- Front entertainment center with 40" LED HDTV
- Outside kitchen (29KS)
- Bunk CD/DVD players (2) (31FS)

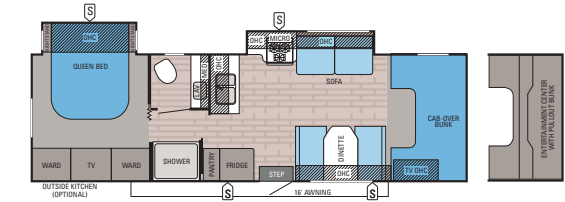

GREYHAWK | 29KS
Ext. Length: 31' 1" Exterior Height: 138" Sleeps: 4-5

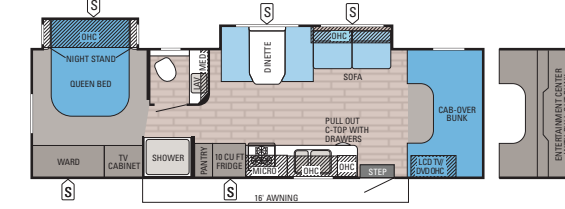

GREYHAWK | 29MV
Ext. Length: 32' Exterior Height: 138" Sleeps: 4-5

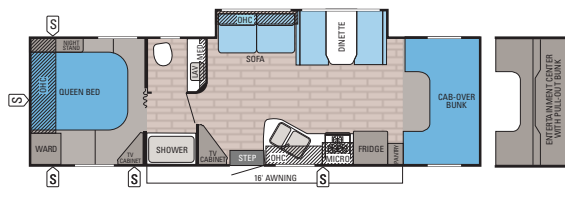

GREYHAWK | 31FK
Ext. Length: 32' Exterior Height: 138" Sleeps: 5-7

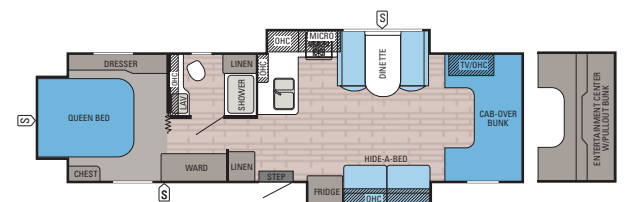

GREYHAWK | 29ME
Ext. Length: 32' 5" Exterior Height: 139" Sleeps: 5-6

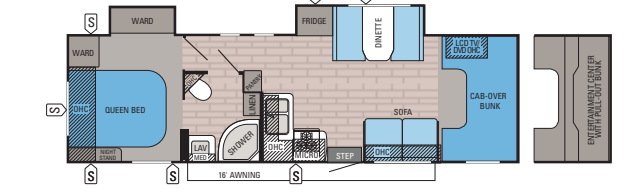

GREYHAWK | 31DS
Ext. Length: 32' 1" Exterior Height: 138" Sleeps: 5-7

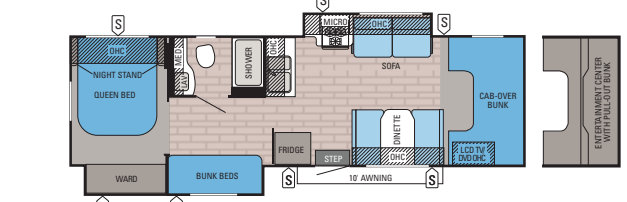

GREYHAWK | 31FS
Ext. Length: 32' 5" Exterior Height: 138" Sleeps: 7-9



CHAMPAGNE FIBERGLASS (STANDARD)



BLACK CRIMSON PAINT (OPTIONAL)



MAHOGANY MIST PAINT (OPTIONAL)

MODELS	DIMENSIONS		WEIGHTS (LBS.)		DRIVING FEATURES		FURNACE	TANKS (GALS.)					
	MODEL	EXT. LENGTH	EXT. WIDTH	EXT. HEIGHT (WITH A/C)	INTERIOR HEIGHT	GROSS VEHICLE WEIGHT RATING	GROSS COMBINED WEIGHT RATING	ENGINE/SIZE	WHEEL BASE	AUTO-IGNITION (BTUS)	FRESH	GRAY	BLACK
29KS	31' 1"	100"	138"	84"	14,500	22,000	6.8L TRITON EFI V-10	212"	31M	31M	32.75	40	32
29ME	32' 5"	100"	139"	84"	14,500	22,000	6.8L TRITON EFI V-10	223"	31M	31M	32.75	41	31
29MV	32'	100"	138"	84"	14,500	22,000	6.8L TRITON EFI V-10	223"	31M	31M	32.75	40	33
31DS	32' 1"	100"	138"	84"	14,500	22,000	6.8L TRITON EFI V-10	223"	31M	31M	32.75	40	32
31FK	32'	100"	138"	84"	14,500	22,000	6.8L TRITON EFI V-10	223"	31M	31M	32.75	40	32
31FS	32' 5"	100"	138"	84"	14,500	22,000	6.8L TRITON EFI V-10	223"	31M	31M	32.75	40	32

Gross Vehicle Weight Rating (GVWR): The maximum permissible weight of the motorhome, including the Unloaded Vehicle Weight (UVW) plus passengers, personal items, all cargo, fluids, options and dealer-installed accessories. The GVWR is equal to or greater than the sum of the UVW and the Cargo Carrying Capacity.

Gross Combined Weight Rating (GCWR): The maximum allowable combined weight of the motorhome used as a tow vehicle and the attached towed vehicle.

It is important for your safety and enjoyment that you are aware of the weights and tow ratings of the RV you select. Consult a competent advisor for questions or advice. Whether you are new to RVing or a veteran, get a feel for the performance of your RV before heading out on the roadways. When you tow a vehicle with your RV, you must drive differently than when you drive a single vehicle. Practice hooking up, driving, backing up and braking in a safe environment or seek out professional instruction. Jayco affixes a weight label to each RV which lists weight information for that vehicle. Refer to that label to verify the vehicle will meet your requirements. See specifications chart above.

NOBODY OFFERS A BETTER WARRANTY

2
YEAR
WARRANTY



Your quality time starts with peace of mind.

For 45 years, Jayco has helped generation after generation create family memories—good, old-fashioned family fun built around a campfire with a Jayco RV nearby. In all of that time, we learned something important—quality time starts with peace of mind, which is why Jayco offers the only 2-year limited warranty in Class C motorhomes.*

Nobody offers a better warranty than Jayco.

*For a copy of our limited warranty with full terms and conditions, please contact your Jayco dealer.



Generations of family fun.

YOUR LOCAL DEALER

300 JAYCO DEALERS

The fun starts with your local dealer

From the sales experience to service after the sale, we consider our dealers to be an important part of the Jayco family. Establishing a solid relationship with your local Jayco dealer is a key component in the enjoyment of your new Jayco. By purchasing from a local dealer, you will have a convenient location for sales, parts and service support. We hope you consider them a part of your camping family.

5-YEARS FREE

Roadside Assistance

Travel worry-free with Ford's Roadside Assistance program, yours at no cost during the first five years of ownership. This program is offered through Coach-Net, the country's largest RV emergency road service, and gives you immediate access to assistance.

Jayco, Inc., P.O. Box 460, Middlebury, IN 46540

See dealer for further information and prices. All information in this brochure is the latest available at the time of publication approval. Jayco reserves the right to make changes and to discontinue models without notice or obligation. Photos in this brochure may show optional equipment and props for photography purposes. RVs built for sale in Canada may differ to conform to Canadian codes. ©2014 Jayco, Inc. 15-GRHK-PL 0614-60K Printed in U.S.A.



www.jayco.com